

115	100 1/4 <sup>Ⓐ</sup>	100	100	100
120	1/4 <sup>Ⓑ</sup>	4T	4T	5T 235

↑  
235  
↓

mrcarpets

Job No: R18460

Name: Dittrich

Address:

Tel:

Sheet: of:

Lingfield  
Cot. Lin-044

Cut Plan  $235 \times 400$   
= 9.40m<sup>2</sup>

# Ground to 157 floor

mrcarpet  
 Job No: R18460  
 Name: Ditttrich  
 Address:  
 Tel:  
 Sheet: of:

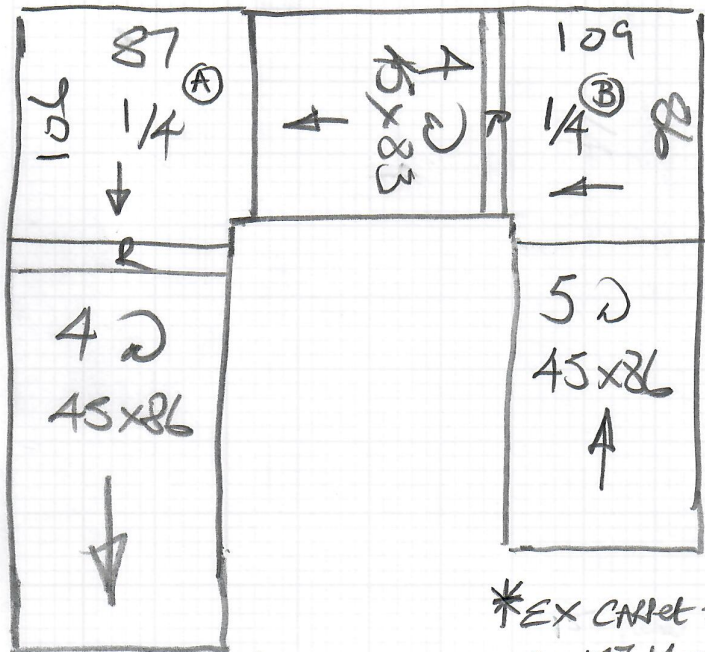

Hall (Stone)

\*EX CARPET to remain  
 on 157 floor landing  
 including Riser.

Wood floor

U/D ex Wood loop + Pu foam

Re-use ex stl

fit New Heavy Duty Rubber U/Lty.

R18460

2nd call of 2

Notes for Measure

Estimator: Nigel

Mr Simon R. Dittrich, 4 Cedar Park Gardens

Date of Measure: Wed, 28 Oct 20

At: tbc 9am Meet

Site Address:

4 Cedar Park Gardens

Customer Address:

South Lodge  
7 Southside Common  
LONDON

SW19 4TL

LONDON

SW19 4TE

CONTACT: As customer details

Mobile	Home	Office
07555-722087		

Email:

jeeves63@hotmail.co.uk

Areas to be done and Description of Measure

stairs as existing (maybe plain loop)

Nick Robertson

Match existing CARPET

Kingfield

Lih-044

Instructions and Estimators comments

Not entered

Must Read!

Not entered

Office Ref: R18460

Mr Simon R. Dittrich, 4 Cedar Park Gardens

Date of Measure Wed, 28 Oct 20

At tbc

**Floor:**  Wood / Concrete / other \_\_\_\_\_

**S/edge:** Wood/Concrete/No pin/ existing (if existing, allow \_\_\_ sticks to supplement where necessary)

**Sticking Req'd:** Yes/No Type: Fastset/Other

**Underlay:** Re-use Existing /  New required

**Type:** 42oz Felt / Fomalux / PU Foam / Luxury PU Foam / LowTog / Durafit  Heavy Rubber

**Doorbars:** Alloy / Satin Ali / Polished Ali / Anod / Solid Brass / Chrome / Nisheen  
 Seam/Wood/T/Holds: colour \_\_\_\_\_ None

**Door Clearance:** OK / Low (advise on quote) N/A

**Uplift:** No /  Yes (if "Yes" - what type?) Wool Loop & PU foam

**Furniture:**  No/Yes (if YES, please specify the following) - 1 man / 2 men (Fitter to get paid) £\_\_\_\_\_ total/per room

**Parking Cost:**  Free / £\_\_\_\_\_ per hour

**Parking Restrictions:** (type) / £\_\_\_\_\_

**Congestion Zone:**  No / Yes

**Access:**  Easy / Hard / 2 men req'd / \_\_\_\_\_ floor?

**Runners:** Whipping / Binding (if binding, specify type)

**Tape size:** 1½" / 2" / 3" / 5"

**Style:** Top taping / Side binding

**Stairrods:** Type \_\_\_\_\_ Nr \_\_\_\_\_ Size \_\_\_\_\_

**Must Read: Not entered**