

MODURO 'IMPRESS' HERRINGBONE
LANNER CAR SIGNATURE PANDORA

R18466
SCALABINI
1A ERNIE ROAD
SW20 0HS

6 BOXES @ 2.40 = 14.40m²

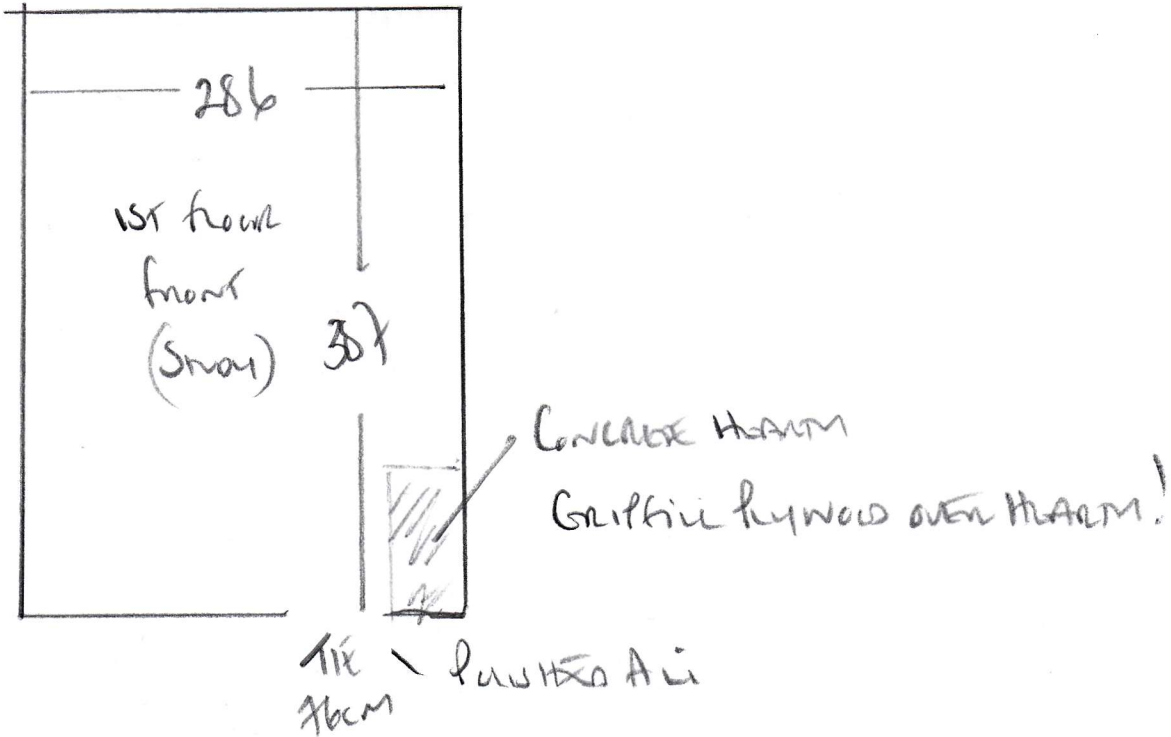

Landing - CARLSON LUXIFELT

WOOD FLOORBOARDS - TO BE SCREWED DOWN BY BUILDERS
BUILDERS TO LAY 12MM PLYWOOD + UNDER FLOOR HEAT PADS
(ELECTRICAL UNDER FLOOR HEATING) + SCREWED OVER PADS!!

ALLOW FOR SPOTLANT 1200 PRO OVER BUILDERS TRAP 3MM GAP
+ MUST USE H1 ADHESIVE!!



Laurel Oak 51942P
Parquetry

Dimension: 632 x 158 mm
Bevel: yes

Herringbone
STRAIT PLANK
2.40m² BOXES

$$6 \times 2.40 = 14.40 \text{ m}^2$$

€34.99 m²

€8397 per box

R18466

4th call of 4

Notes for Measure

Estimator: Colin

Mrs Scalabrini, 14 Ernle Road

Date of Measure: Mon, 9 Nov 20

At: tbc

930-1000 ✓

Site Address:

**14 Ernle Road
Wimbledon**

LONDON SW20 0HJ

CONTACT: Julie

| | | |
|--------------|---------------|--------|
| Mobile | Home | Office |
| 07713-105255 | 020-8947-7627 | N/P |

Customer Address:

14 Ernle Road
Wimbledon
LONDON

SW20 0HJ

Email:

julie.s1966@btinternet.com

Areas to be done and Description of Measure

room in Impress Laurel Oak col 51942 in 196 x 1320mm planks fitted herringbone edge to edge (no border)
underfloor heating

Instructions and Estimators comments

Not entered

Must Read!

Not entered

Office Ref: R18466

Mrs Scalabrini, 14 Ernle Road

Date of Measure Mon, 9 Nov 20

At tbc

Floor: Wood / Concrete / other _____

S/edge: ~~Wood~~/Concrete/No pin/existing (if existing, allow ___ sticks to supplement where necessary)

Sticking Req'd: Yes/No Type: Fastset/Other

Underlay: Re-use Existing / New required

Type: 42oz Felt / Fomalux / PU Foam / Luxury PU Foam / LowTog / Durafit

Doorbars: Alloy / Satin Ali / Polished Ali / Anod / Solid Brass / Chrome / Nisheen
Seam/Wood/T/Holds: colour _____

Door Clearance: OK / Low (advise on quote)

Uplift: No / Yes (if "Yes" - what type?) _____

Furniture: No/Yes (if YES, please specify the following) - 1 man / 2 men (Fitter to get paid) £_____ total/per room

Parking Cost: Free / £_____ per hour

Parking Restrictions: (type) / £_____

Congestion Zone: No / Yes

Access: Easy / Hard / 2 men req'd / _____ floor?

Runners: Whipping / Binding (if binding, specify type)

Tape size: 1½" / 2" / 3" / 5"

Style: Top taping / Side binding

Stairrods: Type _____ Nr _____ Size _____

BUILDERS TO LAY
12mm PLYWOOD
+ U/Floor ELECTRICAL
HEATING TAPS!

ALLOW
STRIP GAP 1200mm
3mm GAP OVER
BUILDERS PREP!

INSPECT BUILDERS
PREP ONCE IT IS
COMPLETED?

ARRANGE

CHECK MEASURE/
SITE INSPECTION
WHEN READY.

Must Read: Not entered