

mrcarpet
 Job No: R18530
 Name: ZENG
 Address: 22 KINGSWOOD SW19 3NE
 Tel:
 Sheet: of:

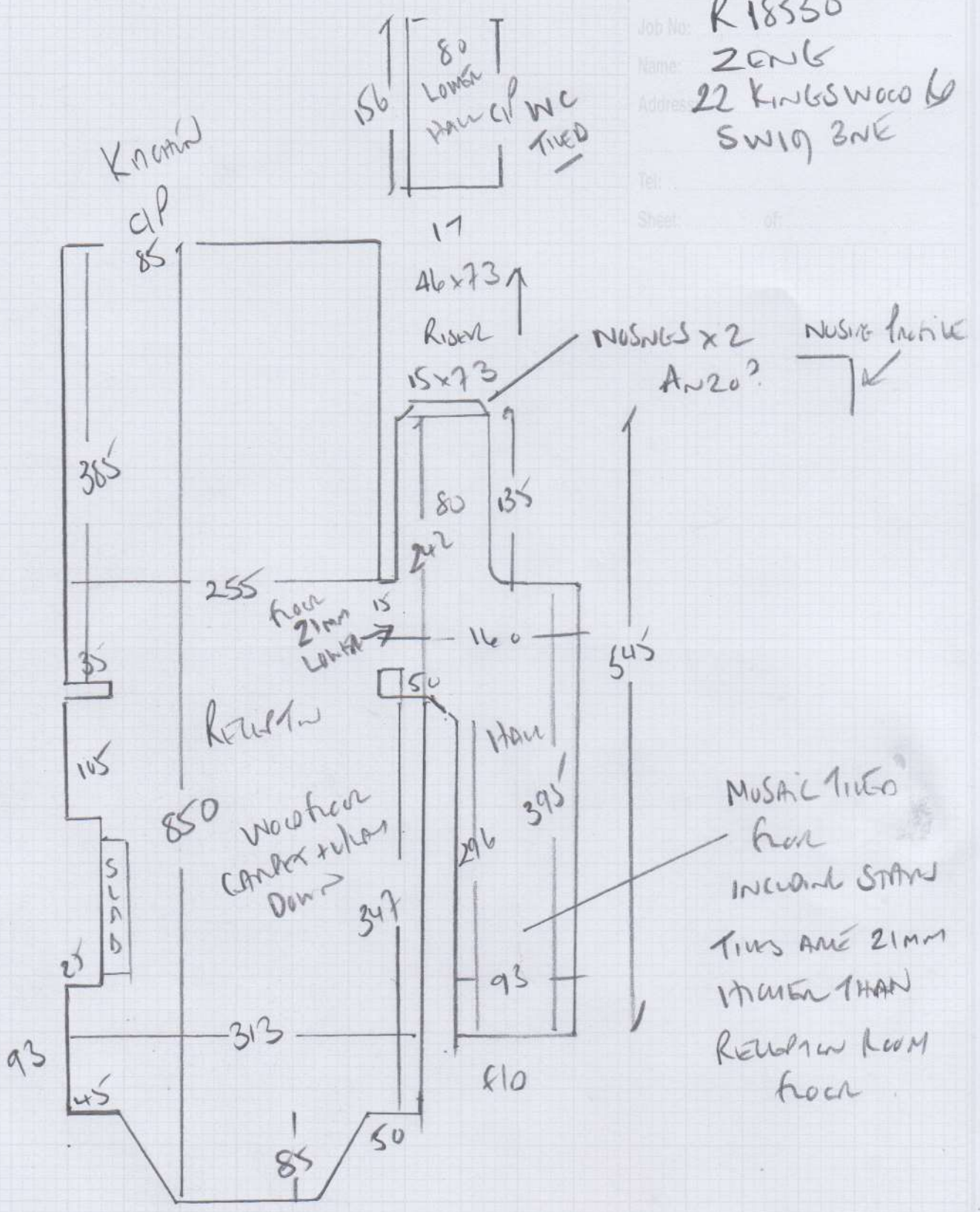

LV1? STAIRS AREA
 RECEPTION WILL NEED 6mm RUN + STICK DOWN
 HALLWAY - VERSILAN + LV1 STICK DOWN
 TILE LIP on REDUCING STRIP BETWEEN HALL & RECEPTION LEVELS!!

R18530

2nd call of 3

Notes for Measure

Estimator: Colin

Mrs Alice Zeng, 22 Kingswood Road

Date of Measure: Mon, 15 Mar 21

At: tbc

9.30 - 10 AM ✓

Site Address:
22 Kingswood Road

Customer Address:
22 Kingswood Road

LONDON SW19 3NE

LONDON SW19 3NE

CONTACT: As customer details

Mobile	Home	Office
07515-127520		

Email:
alice.zeng0922@gmail.co.uk

Areas to be done and Description of Measure

lounge and hall in Amtico

SPACIA

CHECK SUB-FLOORS

THUS IN HALLWAY - VENSILAM?
CANTON IN LOUNGE

CHECK SUB FLOOR TREE REARERS
+ SUB FLOOR LEVELS

Instructions and Estimators comments

Not entered

1) SPACIA - ?

2) SIGNATURE - ?

CUSTOMER IS NOT SURE ON
SPECIFICATION

'SHIPPING ANNOY'?

35m² x £150

BUDGET PRICE APPROX

AMTICO SPACIA £4500?

SIGNATURE £5250?

DELIVERING AND
FROM PRICE

Must Read!

Not entered

Office Ref: R18530

Mrs Alice Zeng, 22 Kingswood Road

Date of Measure Mon, 15 Mar 21

At tbc

Floor: Wood / Concrete / other Have Ceramic Tiles Mosaic
2mm thicker than

S/edge: Wood/Concrete/No pin/existing (if existing, allow ___ sticks to supplement where necessary) frambars

Sticking Req'd: Yes/No Type: Fastset/Other

Underlay: Re-use Existing / New required Plywood Layer + fix

Type: 42oz Felt / Fomalux / PU Foam / Luxury PU Foam / LowTog / Durafit

Doorbars: Alloy / Satin Ali / Polished Ali / Anod / Solid Brass / Chrome / Nisheen
 Seam/Wood/T/Holds: colour _____

Door Clearance: OK / Low (advise on quote)

Uplift: No / Yes (if "Yes" - what type?) Camber + underlay in Level

Furniture: No / Yes (if YES, please specify the following) - 1 man / 2 men (Fitter to get paid) £ 100 total/per room

Parking Cost: Free / £ _____ per hour

Parking Restrictions: (type) / £ NEARBY (WILTON COUNCIL)
Ring 60

Congestion Zone: No / Yes

Access: Easy / Hard / 2 men req'd / _____ floor? Grass Area

Runners: Whipping / Binding (if binding, specify type)

Tape size: 1 1/2" / 2" / 3" / 5" Have 21mm thicker than kitchen

Style: Top taping / Side binding

Stairrods: Type _____ Nr _____ Size _____

Must Read: Not entered

Office Ref: R18530