

18673

1st call of 3

# Notes for Measure

Estimator: JOHNC

Mrs Catalina Duncan, 53 Tenyson Ave

Date of Measure: Fri, 15 Oct 21

At: 9.30am

Site Address:  
53 Tenyson Ave

Customer Address:  
53 Tenyson Ave

NEW MALDEN KT3 6LZ

NEW MALDEN KT3 6LZ

CONTACT: As customer details

Mobile	Home	Office
07748-295044		

Email:  
cataverri@yahoo.it

*Catdown*

### Areas to be done and Description of Measure

stairs from first to loft and 2 bedrooms (bed 1 Fairfield Silk) (bed 2 in Parkside Waverley)

*Himalaya Waverley 2339*

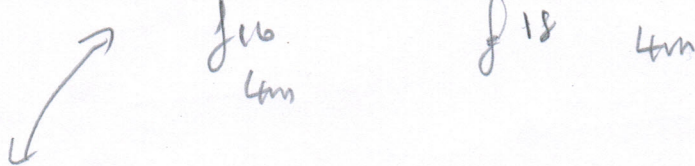

Colour 02 80 = 5m

Colour 0630 = 4m

### Instructions and Estimators comments

Not entered

*f49 - 20%*

*Element Des GLDFT 18*

*Queen town 68/1431*

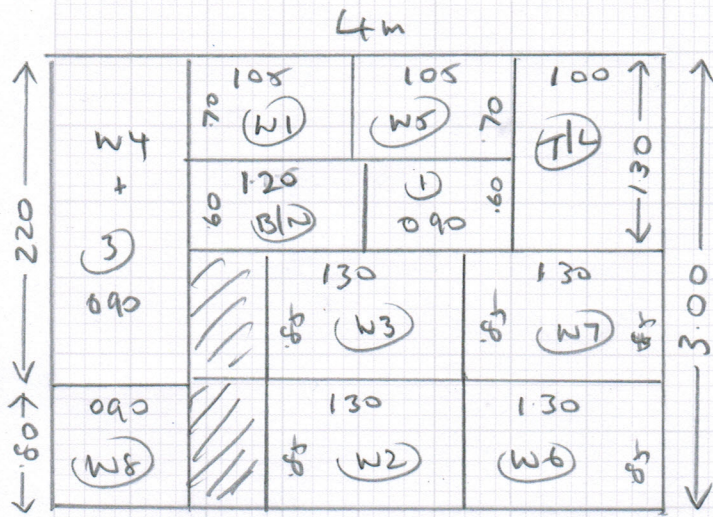

R18673

Mrs C. DUNCAN  
 53 Tennyson Ave  
 New Malden  
 KT3 6LZ

Elements of Design  
 ELDES 18  
 3.00 x 4m

Loft Bed 4.00 x 5m (or) 5.00m x 4m

1st floor Bed 3.15m x 4m

(1022)

Layout

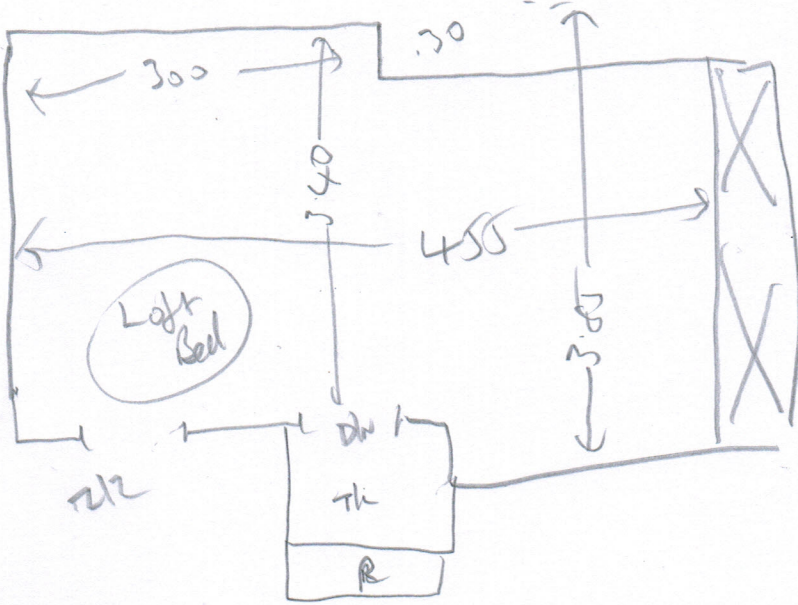

F/R Bed size  
0250

wood  
no ub  
needs ledge  
no m/r

- TIC 1.1502 x 092
- ① 047 x 076
- w1 058 x 088
- w2 059 x 1.15
- w3 073 x 1.15
- w4 089 x 080
- ③ 047 x 079
- w5 059 x 091
- w6 060 x 1.15
- w7 077 x 1.15
- w8 089 x 077
- B/N 050 x 1.05

wood  
no ub  
needs ledge

FLDBS-18

2022

W/malaga wood  
net.  
Wardley 2339

1st floor F Bed

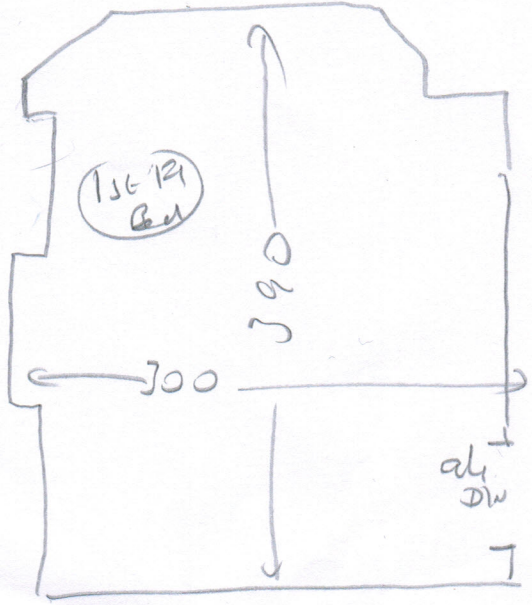

wood  
u/lr/stop  
needs 1/2 sledge  
m/r x2

Mrs Catalina Duncan, 53 Tenyson Ave

Date of Measure

Fri, 15 Oct 21

At 9.30am

Door: Wood / Concrete / other \_\_\_\_\_

Edge: Wood/Concrete/No pin/existing (if existing, allow \_\_\_ sticks to supplement where necessary)

*Top Bed + Bottom = needs  
bt fl bed = needs 1/2*

Licking Req'd: Yes/No Type: Fastset/Other

Underlay: Re-use Existing / New required

Type: 42oz Felt / *Skim* Fomalux / PU Foam / *Beds* Luxury PU Foam / LowTog / Durafit

Doorbars: Alloy / Satin Ali / Polished Ali / Anod / Solid Brass / Chrome / Nisheen  
Seam/Wood/T/Holds: colour \_\_\_\_\_

Door Clearance: OK / Low (advise on quote)

Lift: No / Yes (if "Yes" - what type?) \_\_\_\_\_

*Yes 1st fl bed only*

Furniture: No/Yes (if YES, please specify the following) - 1 man / 2 men (Fitter to get paid) £ \_\_\_\_\_ total/per room

Marking Cost: Free / £ \_\_\_\_\_ per hour

Marking Restrictions: (type) / £ \_\_\_\_\_

Obstruction Zone: No / Yes

Access: Easy / Hard / 2 men req'd / \_\_\_\_\_ floor?

Runners: Whipping / Binding (if binding, specify type)

Runner size: 1 1/2" / 2" / 3" / 5"

Runner style: Top taping / Side binding

Door rods: Type \_\_\_\_\_ Nr \_\_\_\_\_ Size \_\_\_\_\_