

R18686

3rd call of 5

Notes for Measure

Estimator: JOHNC

Mr Peter Brightwell, 66 Chesnut Road

Date of Measure: Tue, 9 Nov 21

At: tbc

Site Address:  
66 Chesnut Road

Customer Address:  
66 Chesnut Road

LONDON SW20 8EB

LONDON SW20 8EB

CONTACT: As customer details

Mobile	Home	Office
	02085409557	

Email:  
peterbrightwell@gmail.com

07834845762

Areas to be done and Description of Measure

Stairs and Landing, samples of Dakota C65 and Ultima Twist ordered

↑ Major  
Moeha

f 58.20 -10%

Instructions and Estimators comments

Not entered

66 CHESTNUT ROAD SW20 8EB  
 British Broadcasting Corporation  
 Room D4.29, BBC R&D, 56 Wood Lane, London W12 7SB  
 Telephone +44 (0)20304 09551  
 Mobile +44 (0)7834 845762 Email peter.brightwell@bbc.co.uk

**BBC** Email  
 peterbrightwell@gmail.com

Peter Brightwell  
 Lead Engineer

Home no: 020 85409557

Must Read!

Not entered

Office Ref: R18686

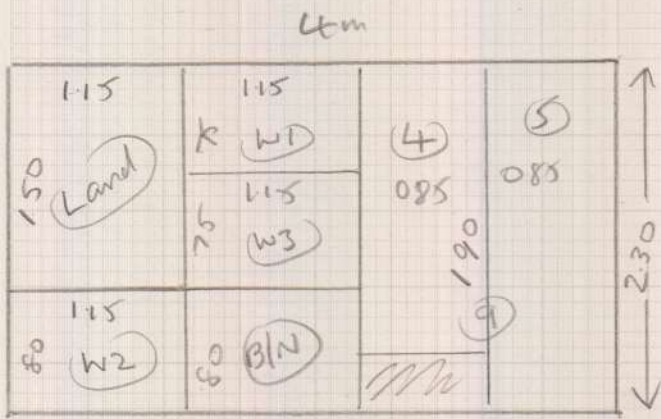

R18686

MR P. BRIGHTWELL  
66 Chestnut Road  
Raynes Park  
SW20 8EB

U. major, Mocha

230 x 4m

Layout

Exist amod  
212

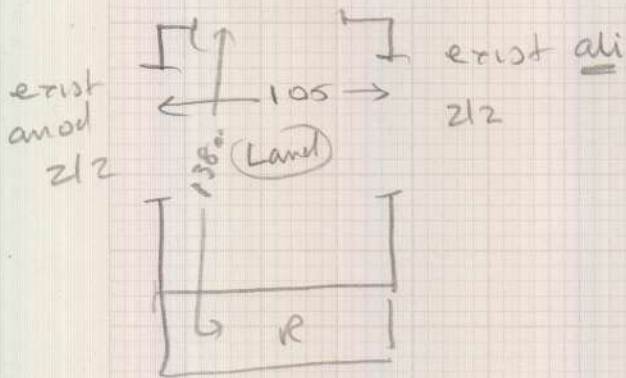

W1  $0.59 \times 0.85$

W2  $0.70 \times 1.05$

W3  $0.66 \times 0.72$

(9)  $0.44 \times 0.72$

B/N  $0.45 \times 0.95$

EXISTING SLODGE  
+ DOOR BARS

ARIST + DUSTSE

1001

Mr Peter Brightwell, 66 Chesnut Road

Date of Measure Tue, 9 Nov 21

At tbc

Floor: Wood / Concrete / other \_\_\_\_\_  
 S/edge: Wood/Concrete/No pin/existing (if existing, allow 3 sticks to supplement where necessary)  
 Sticking Req'd: Yes/No Type: Fastset/Other  
 Underlay: Re-use Existing / New required  
 Type: 42oz Felt / Fomalux / PU Foam / Luxury PU Foam / LowTog / Durafit  
 Doorbars: Alloy / Satin Ali / Polished Ali / Anod / Solid Brass / Chrome / Nisheen  
 Seam/Wood/T/Holds: colour \_\_\_\_\_ EXIST DLSans  
 Door Clearance: OK / Low (advise on quote)  
 Uplift: No / Yes (if "Yes" - what type?) \_\_\_\_\_  
 Furniture: No/Yes (if YES, please specify the following) - 1 man / 2 men (Fitter to get paid) £ \_\_\_\_\_ total/per room  
 Parking Cost: Free / £ \_\_\_\_\_ per hour  
 Parking Restrictions: (type) / £ \_\_\_\_\_ Permit from Airborne  
 Congestion Zone: No / Yes  
 Access: Easy / Hard / 2 men req'd / \_\_\_\_\_ floor?  
 Runners: Whipping / Binding (if binding, specify type)  
 Tape size: 1½" / 2" / 3" / 5"  
 Style: Top taping / Side binding  
 Stairrods: Type \_\_\_\_\_ Nr \_\_\_\_\_ Size \_\_\_\_\_

**Must Read: Not entered**