

Job No: R18707
 Name: HAZEL
 Address: 88 Brookwood Ln
 SW18 5DB
 Tel: _____
 Sheet: 1 of 2

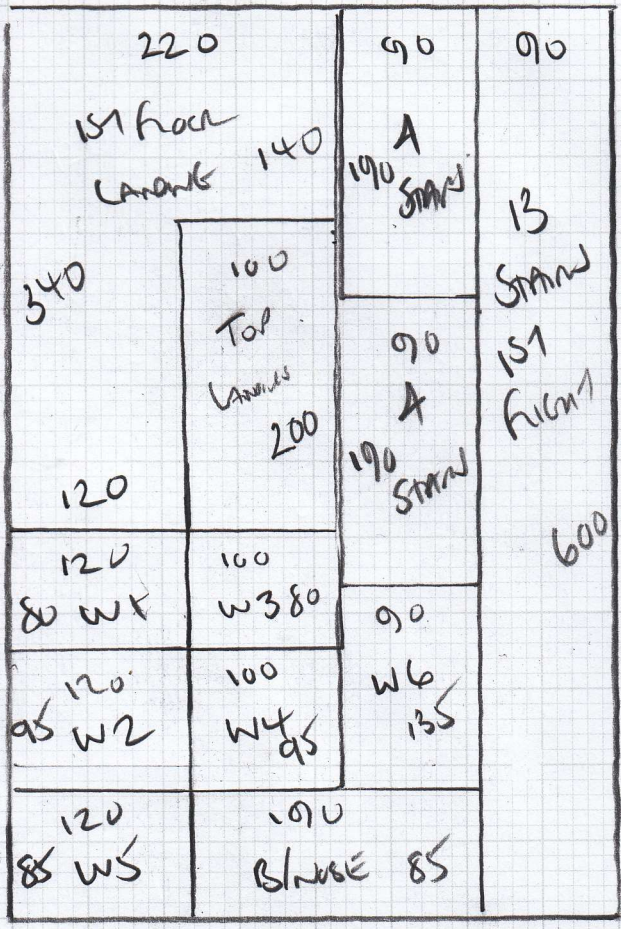

STAIRS + LANDINGS

Total floor - Ground floor

HAVANA

Colour HAV 23

PLAN 600 x 400

24m²

Job No: R18709
 Name: HAZEL
 Address: 88 Brookwood Road
 SW18 5DB
 Tel:
 Sheet: 2 of 2

Wood floor
 white Luv line
 on Pufam
 + Grids
 Existing Air Band
 + Gas stop

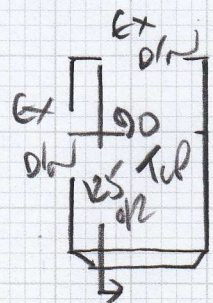

- AT
 ↓
 45 x 81
 w1 70 x 100
 w2 85 x 115
 w3 60 x 73
 w4 65 x 85
 w5 70 x 108
 w6 70 x 78
 AT
 45 x 81

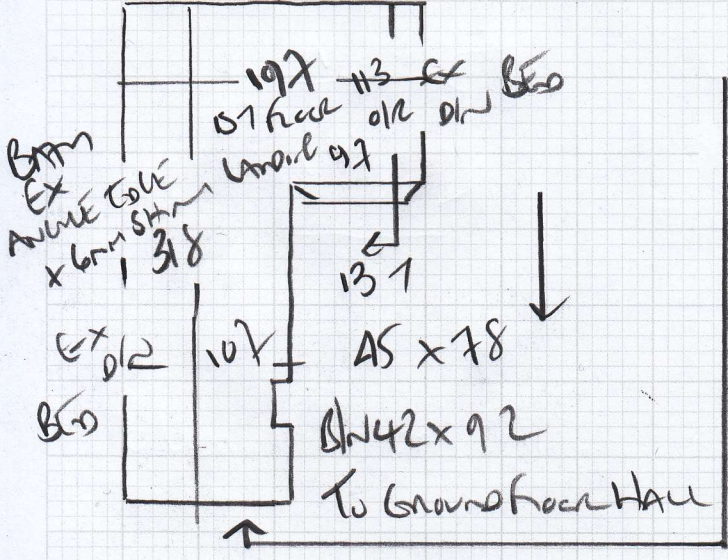

R18709

1st call of 2

Notes for Measure

Estimator: Colin

Mrs Lucy Hazell, 88 Brookwood Road

157

Date of Measure: Thu, 9 Dec 21

At: 8.30am-8.45am

Site Address:
88 Brookwood Road

Customer Address:
88 Brookwood Road

LONDON SW18 5DB

LONDON SW18 5DB

CONTACT: As customer details

Mobile	Home	Office
07767-770771		

Email:
lhazell@me.com

Areas to be done and Description of Measure

Stairs/landing samples borrowed of Havana cols 23 and 2~~X~~ and Dublin col DUB S203

LAOFS
-10/10

HAV-23 SELECTED ON SITE
SEND SAMPLE WITHIN 6
FUL CUSTOMER TO MATCH UP PAINT!

Instructions and Estimators comments

Not entered

Must Read! Not entered

Office Ref: R18709

Mrs Lucy Hazell, 88 Brookwood Road

Date of Measure Thu, 9 Dec 21

At 8.30am-8.45am

Floor: Wood / Concrete / other _____

S/edge: Wood / Concrete / No pin / existing (if existing, allow ___ sticks to supplement where necessary)

Sticking Req'd: Yes / No Type: Fastset / Other

Underlay: Re-use Existing / New required

Type: 42oz Felt / Fomalux / PU Foam / Luxury PU Foam / LowTog / Durafit

Doorbars: Alloy / Satin Ali / Polished Ali / Anod / Solid Brass / Chrome / Nisheen Seam / Wood / T / Holds: colour _____

Door Clearance: OK / Low (advise on quote)

Uplift: No / Yes (if "Yes" - what type?) Loop pile (Fibreoptic/Geslan)
ON OLD PU FOAM

Furniture: No / Yes (if YES, please specify the following) - 1 man / 2 men (Fitter to get paid) £ _____ total/per room

Parking Cost: Free / £ _____ per hour

Parking Restrictions: (type) / £ Ring 60 NEARBY

Congestion Zone: No / Yes

Access: Easy / Hard / 2 men req'd / _____ floor?

Runners: X Whipping / Binding (if binding, specify type)

Tape size: 1 1/2" X 2" / 3" / 5"

Style: X Top taping / Side binding

Stairrods: Type X _____ Nr _____ Size _____

Must Read: Not entered