

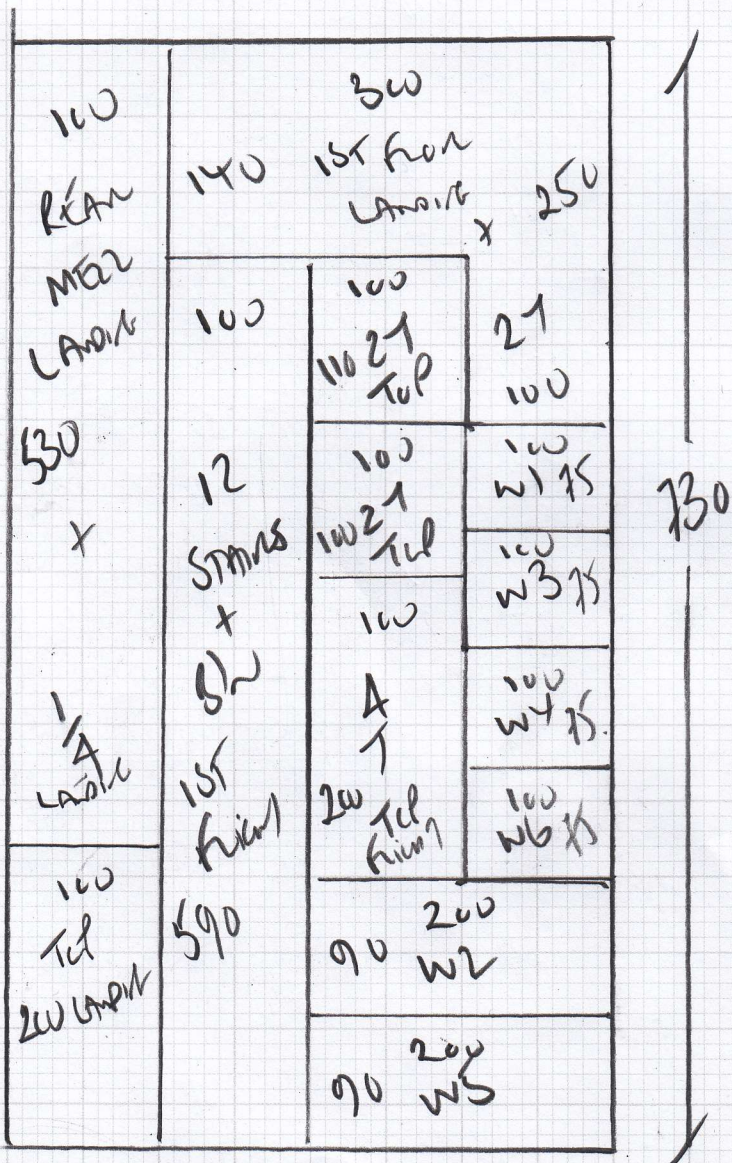

Job No: R18712
Name: MCCARTHY
Address: 109 PERRY ROAD
SW20 8NW

Tel: _____
Sheet: _____ of: _____



ARTEC STAIRS
OR SIMILAR

PLAN 130 x 400

29.20m²

Job No: R18712
 Name: MCCARTHY
 Address: 109 PEP-15 ROAD
 SW20 8NW
 Tel: _____
 Sheet: _____ of: _____

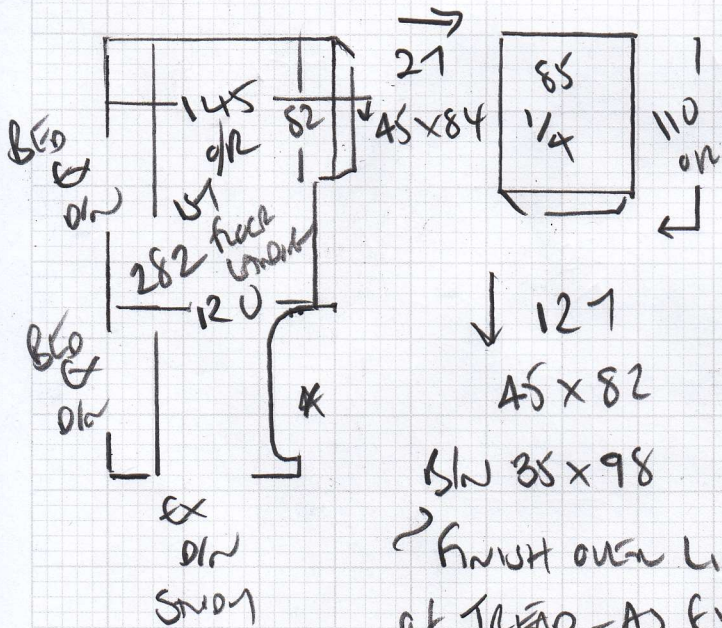
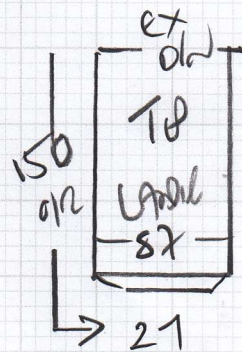
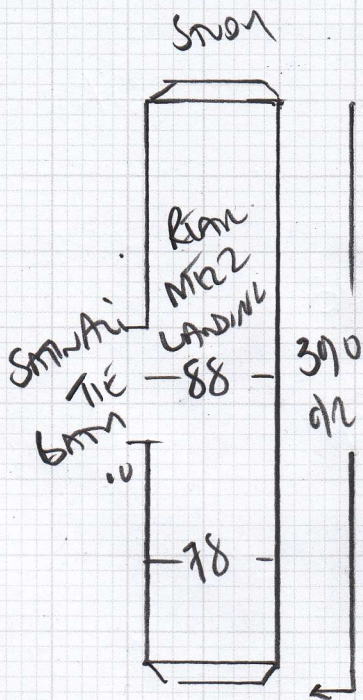

- 45 x 73
- W1 65 x 84
- W2 75 x 103
- W3 66 x 71
- 41
- 48 x 74
- W4 65 x 84
- W5 75 x 102
- W6 66 x 70
- 21
- 45 x 73

FINISH OVER LIP
 OF TREAD - AS EXTERNAL
 RISE IS PAINTED WHITE
 TO WOOD HALLWAY
 FLOOR.

*

R18712

1st call of 3

Notes for Measure

Estimator: Colin

Mrs Krystyan Mccarthy, 109 Pepys Road

Date of Measure: Mon, 13 Dec 21

At: tbc

9:10AM

Site Address:
109 Pepys Road

Customer Address:
109 Pepys Road

LONDON SW20 8NW

LONDON SW20 8NW

CONTACT: As customer details

Mobile	Home	Office
07775-724853		

Email:
krystyan.mccarthy@gmail.com

Areas to be done and Description of Measure

stairs and landing in Aztec Stripe tbc

Instructions and Estimators comments

Not entered

Must Read!

Not entered

Office Ref: R18712

Mrs Krystyan Mccarthy, 109 Pepys Road

Date of Measure Mon, 13 Dec 21

At tbc

Floor: Wood / Concrete / other _____
 S/edge: Wood / Concrete / No pin / existing (if existing, allow 3 sticks to supplement where necessary)
 Sticking Req'd: Yes / No Type: Fastset / Other
 Underlay: Re-use Existing / New required
 Type: 42oz Felt / Fomalux / PU Foam / Luxury PU Foam / LowTog / Durafit
 Doorbars: Alloy / Satin Ali / Polished Ali / Anod / Solid Brass / Chrome / Nisheen Seam/Wood/T/Holds: colour ~~Gold~~ + 1100LE x 1
 Door Clearance: OK / Low (advise on quote)
 Uplift: No / Yes (if "Yes" - what type?) Loop Kuro Strike
XPRESS? DILLOW
 Furniture: No / Yes (if YES, please specify the following) - 1 man / 2 men (Fitter to get paid) £ _____ total/per room
 Parking Cost: Free / £ _____ per hour
 Parking Restrictions: (type) / £ 11-12 kmison
 Congestion Zone: No / Yes
 Access: Easy / Hard / 2 men req'd / _____ floor?
 Runners: Whipping / Binding (if binding, specify type)
 Tape size: 1½" / 2" / 3" / 5"
 Style: Top taping / Side binding
 Stairrods: Type _____ Nr _____ Size _____

Must Read: Not entered