

Job No: R18752  
 Name: PAI  
 Address: 20 THE QUADRANT  
 SW20 8SP  
 Tel: \_\_\_\_\_  
 Sheet: \_\_\_\_\_ of: \_\_\_\_\_

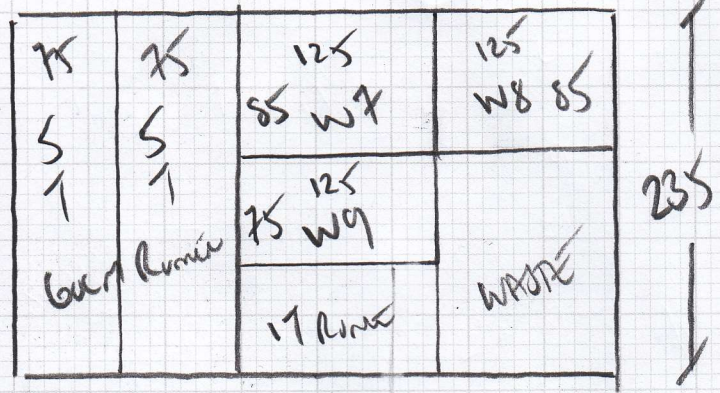

Grass - 1st floor  
 6cm Runers  
 'white' 60'

Raw GMA-Diamond  
 Plan 235 x 400

940m<sup>2</sup>

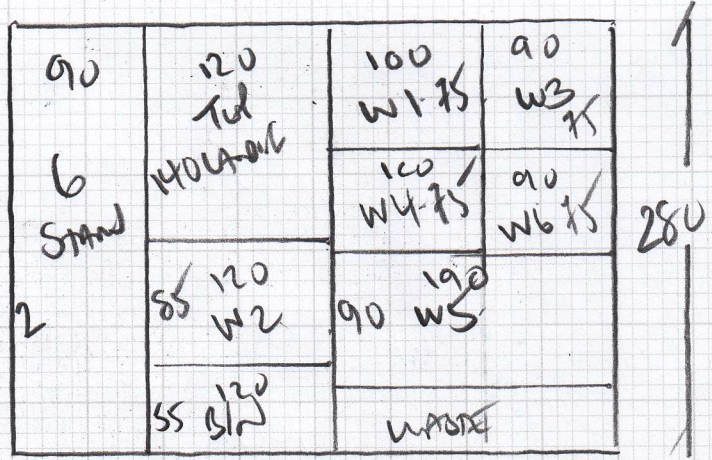

Tel floor Down to  
 1st floor  
 (Close cover)  
 Boston Corrugated-015

Plan 280 x 400

1120m<sup>2</sup>

Job No: R18752  
 Name: PAI  
 Address: 20 THE QUADRANT  
 SW20 8SP  
 Tel:  
 Sheet: of:

125 TCP LANDING	125 75 W7	90 6 T (TUL)	60
	85 125 W8	280	9 STAIRS +
85 125 W2	75 125 W9		OLN
	90 125 W5	60 125 BLN	60 125 RUMBLE
	75 125 W6	90 W3 90	460
	75 125 W1	90 11 T RUMBLE 90	

460  
 Tol from STAIRS CLOSE  
 + 1ST from STAIRS CASE  
 ROWS - CORNER DAMAGED  
 COLOR BASALT  
 Run 460 x 400  
 1840m<sup>2</sup>  
 15 LINERS WITH PINK

TCP Summary

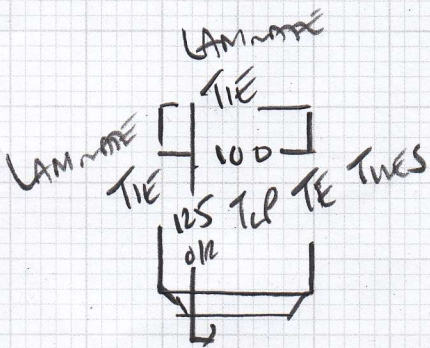

- w1 67 x 92
- w2 75 x 110
- w3 68 x 75
- 67
- 45 x 78 (boxed)
- w4 66 x 87
- w5 78 x 102
- w6 63 x 66
- Blu 45 x 78

WOOD floor

NO white

Azi bars + (Satin Azi upgrade of floor)

1st floor TO Ground floor

WOOD nosing

Riser 17 x 78  
 SCOTIA NEEDED REMOVING TO FACILITATE RUNNER  
 CUSTOMER ADVISOR ON SITE

17

45 x 82

w7 66 x 92

w8 76 x 113

w9 68 x 78

97

45 x 81

Blu 45 x 97

(75cm TO CURVE)

WOOD  
 WHOLE  
 RUNNER

Job No: R18752  
 Name: PAI  
 Address: 20 THE QUADRANT SW20 8SP  
 Tel: \_\_\_\_\_  
 Sheet: \_\_\_\_\_ of: \_\_\_\_\_

Mr Sid Pai, 20 The Quadrant

Date of Measure: Thu, 17 Feb 22

At: 10.30am-11.30

Site Address:  
20 The Quadrant

Customer Address:  
20 The Quadrant

LONDON SW20 8SP

LONDON SW20 8SP

CONTACT: As customer details

Mobile	Home	Office
07471-324865		

Email:  
siddharthpai85@gmail.com

Areas to be done and Description of Measure

Stairs/Landing bottom to be a runner in Rols Gala Diamond col Basalt rest fully covered in Boston col 015

1) Rols  
GMA Diamond that  
close cover top flights  
+ Runner from GMA -  
1st floor (WHITTED)

Instructions and Estimators comments

Not entered

2) Rols  
a) GMA - BT cover  
As whitened runner 015  
b) BOSTON 015 TO  
TOP FLIGHT CLOSE COVERED

Must Read!

Not entered

Office Ref: R18752

Mr Sid Pai, 20 The Quadrant

Date of Measure Thu, 17 Feb 22

At 10.30am-11.30

**Floor:**  Wood / Concrete / other \_\_\_\_\_

**S/edge:**  Wood/Concrete/No pin/existing (if existing, allow \_\_ sticks to supplement where necessary)

**Sticking Req'd:** Yes  No Type: Fastset/Other

**Underlay:** Re-use Existing /  New required

**Type:** 42oz Felt / Fomalux / PU Foam /  Luxury PU Foam /  LowTog / Durafit *Furter*

**Doorbars:**  Alloy *+ others* / Satin Ali / Polished Ali / Anod / Solid Brass / Chrome / Nisheen Seam/Wood/T/Holds: colour \_\_\_\_\_

**Door Clearance:**  OK / Low (advise on quote)

**Uplift:**  No / Yes (if "Yes" - what type?) \_\_\_\_\_

**Furniture:**  No/Yes (if YES, please specify the following) - 1 man / 2 men (Fitter to get paid) £\_\_\_\_\_ total/per room

**Parking Cost:** Free / £\_\_\_\_\_ per hour

**Parking Restrictions:** (type) / £ *Permanently 830.6301*

**Congestion Zone:**  No / Yes

**Access:**  Easy / Hard / 2 men req'd / \_\_\_\_\_ floor? *Crane - 1ST*

**Runners:**  Whipping / Binding (if binding, specify type)

**Tape size:** 1½" / ~~2"~~ / 3" / 5"

**Style:** Top taping / Side binding

**Stairrods:** Type ~~X~~ \_\_\_\_\_ Nr \_\_\_\_\_ Size \_\_\_\_\_

Must Read: Not entered