

all
 used
 no ub
 needs to
 no mtr

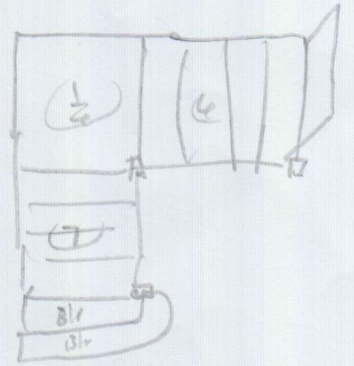

- the sepla
- Rivr 0020 2/4 080 end
- (6) 046 x 080 exact
- 1/2 land 1.05m x 2.06
- (6) 046 x 080 exact

Top Stairs

- Rivr 018 x 082 exact
- (4) 044 x 082 exact
- 1/2 land 1.07m x 085
- (7) 043 x 082
- 13/2 045 x 1.05
- 13/2 080 x 1.50

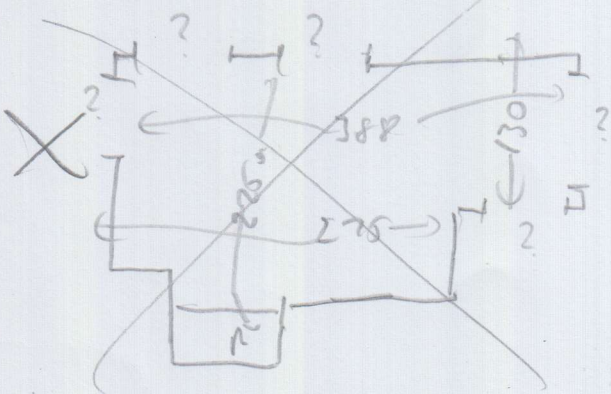

Dawies

S27984
Dawies



$$\begin{array}{r}
 645 \\
 415 \\
 \hline
 10.60 \times 5 = 53m^2
 \end{array}$$

WOOD floor NOW
 Requires in 2x
 Left Bedrooms + Landing
 CHOSEN V4 ALPINE
 CURTAIN OAK VANE
 35MIP LAUNDED.

S27984

2nd call of 2

Notes for Measure

Estimator: JOHNC

Mrs Elisabeth Davies, 37 Keswick Avenue

Date of Measure: Wed, 25 Nov 15

At: 9-9:30

Site Address:

37 Keswick Avenue
Merton Park

LONDON

SW19 3JE

CONTACT:

As customer details

Mobile
07971-010166

Home

Office

Customer Address:

37 Keswick Avenue
Merton Park
LONDON

SW19 3JE

Email:

elisabeth.davies100@yahoo.co.uk

Areas to be done and Description of Measure

2x loft bedrooms, Stairs and Landings. Stairs as an edge taped runner

2x Loft Beds + Top Landing now V4 wood

Staircases - KATSU K1 819110 + Taped Runner?

Instructions and Estimators comments

quote on Miku 510 with edge tape colour to confirm

Must Read!

Not entered

Office Ref: S27984