

mrcarpet  
 Job No: S32399  
 Name: RETTIE  
 Address: 22 STONEHILL LN  
 SWIT 8LW  
 Tel:  
 Sheet: of

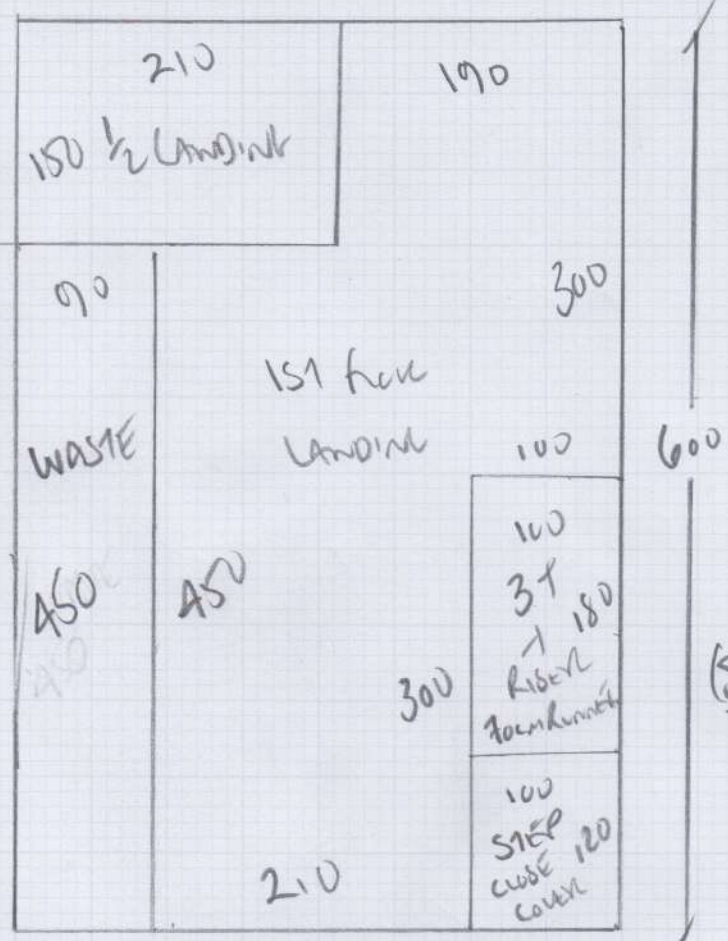

ABENLUMS  
STAIRS + LANDINGS  
(STAIRS AS TOLM RUNNER)

PLAN LOST  
 Colour 6391

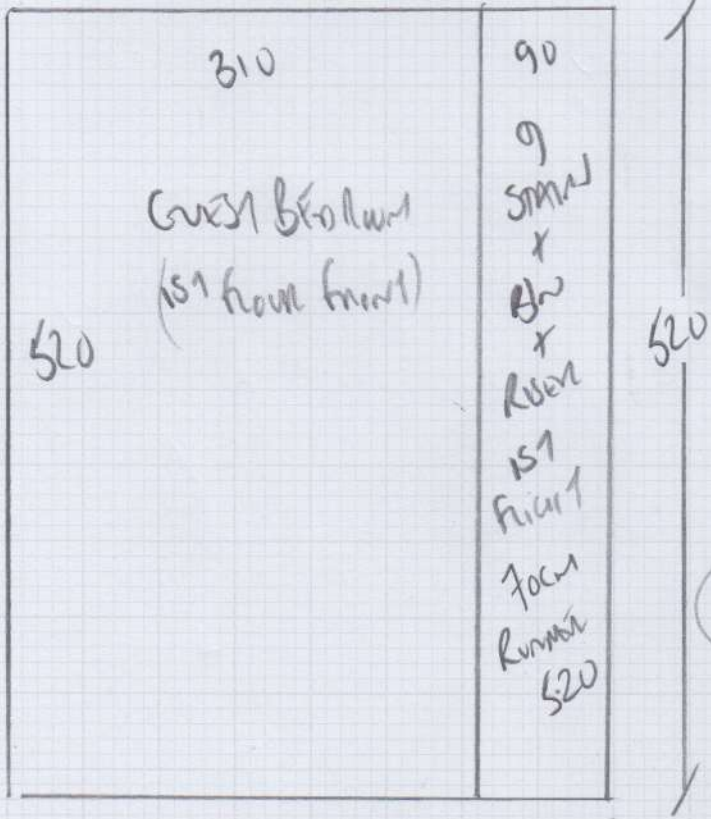

PLAN 1 600 x 400  
 PLAN 2 520 x 400  
 MASTER BED 520 x 400  
 FRONT BED 1 540 x 400  
 FRONT BED 2 440 x 400  
26.20 x 400

10480 m<sup>2</sup>





S32399

2nd call of 2

Notes for Measure

Estimator: Colin

Mrs Rettie, 22 Stonehill Road

Date of Measure: Tue, 4 May 21

At: Est to Arrange 10AM-1030AM

Site Address:  
22 Stonehill Road

Customer Address:  
22 Stonehill Road

LONDON SW14 8RW

LONDON SW14 8RW

CONTACT: As customer details

Mobile	Home	Office
07971-764777		

Email:  
jessicaretie@gmail.com

Areas to be done and Description of Measure

Stairs (discuss runner options 1st flight or all) Land + Top + Four Beds

INSTALLATION PHASE 1 GUEST BED STAIRS + LANDINGS  
(TAKED RUNNERS)

PHASE 2 FURTHER 3 BED ROOMS

Instructions and Estimators comments

Two quotes Plain Loop 639/24 (£33.30) Venz VEN 012 £30.60 / 10 mm PU

Colin Requests 4 x GREY SAMPLES  
IN Plain Loop - SEE SAMPLE PROGRAMME  
FOR CARNS SENT

Staircase  
Carns

Must Read!

Not entered

Office Ref: S32399

Mrs Rettie, 22 Stonehill Road

Date of Measure Tue, 4 May 21

At Est to Arrange

Floor: Wood / Concrete / other \_\_\_\_\_

S/edge: Wood/Concrete/No pin/existing (if existing, allow EXISTING TO ROOMS sticks to supplement where necessary)

Sticking Req'd: Yes/No Type: Fastset/Other

Underlay: Re-use Existing / New required

Type: 42oz Felt / Fomalux / PU Foam / Luxury PU Foam / LowTog / Durafit

Doorbars: Alloy / Satin Ali / Polished Ali / Anod / Solid Brass / Chrome / Nisheen Seam/Wood/T/Holds: colour USE SOME EXISTING

Door Clearance: OK / Low (advise on quote)

Uplift: No / Yes (if "Yes" - what type?) ROOMS ONLY

Furniture: No/Yes (if YES, please specify the following) - 1 man / 2 men (Fitter to get paid) £ 900 total/per room

Parking Cost: Free / £ 0 per hour

Parking Restrictions: (type) / £ NONE

Congestion Zone: No / Yes

Access: Easy / Hard / 2 men req'd / \_\_\_\_\_ floor?

Runners: Whipping / Binding (if binding, specify type)

Tape size: 1½" / 2" / 3" / 5"

Style: Top taping / Side binding

Stairrods: Type \_\_\_\_\_ Nr \_\_\_\_\_ Size \_\_\_\_\_

EXISTING TO ROOMS  
ALLOW ALL NEW TO SLIP

DEOS  
FOAM  
RUNNERS

NEW BAN SATIN ALI TO

ENSURE INCLUDE  
BATHROOM THE GATE  
MASTER BED DRAP

CHARCOAL / DARK GREEN  
TO MATCH COLOR IN TILES  
(SEE IMAGE)

Must Read: Not entered