

This plan if a Directional Carpet Selected

Job No: S32685  
 Name: Gates  
 Address:

Tel:  
 Sheet: of:

Cut Plan  $775 \times 500$   
 $= \underline{\underline{3875m^2}}$

U/Lay: -  
 Loft RM + TOP STRS =  $28m^2$   
 Runners =  $6m^2$

\* = Cut to exact sizes & send to Kasias for edging

\*\* Template these 3 Winders on site to maintain an equal 10cm gap at sides to match the straight runners

Job No: 532685  
 Name: Gates  
 Address:  
 Tel:  
 Sheet: of:

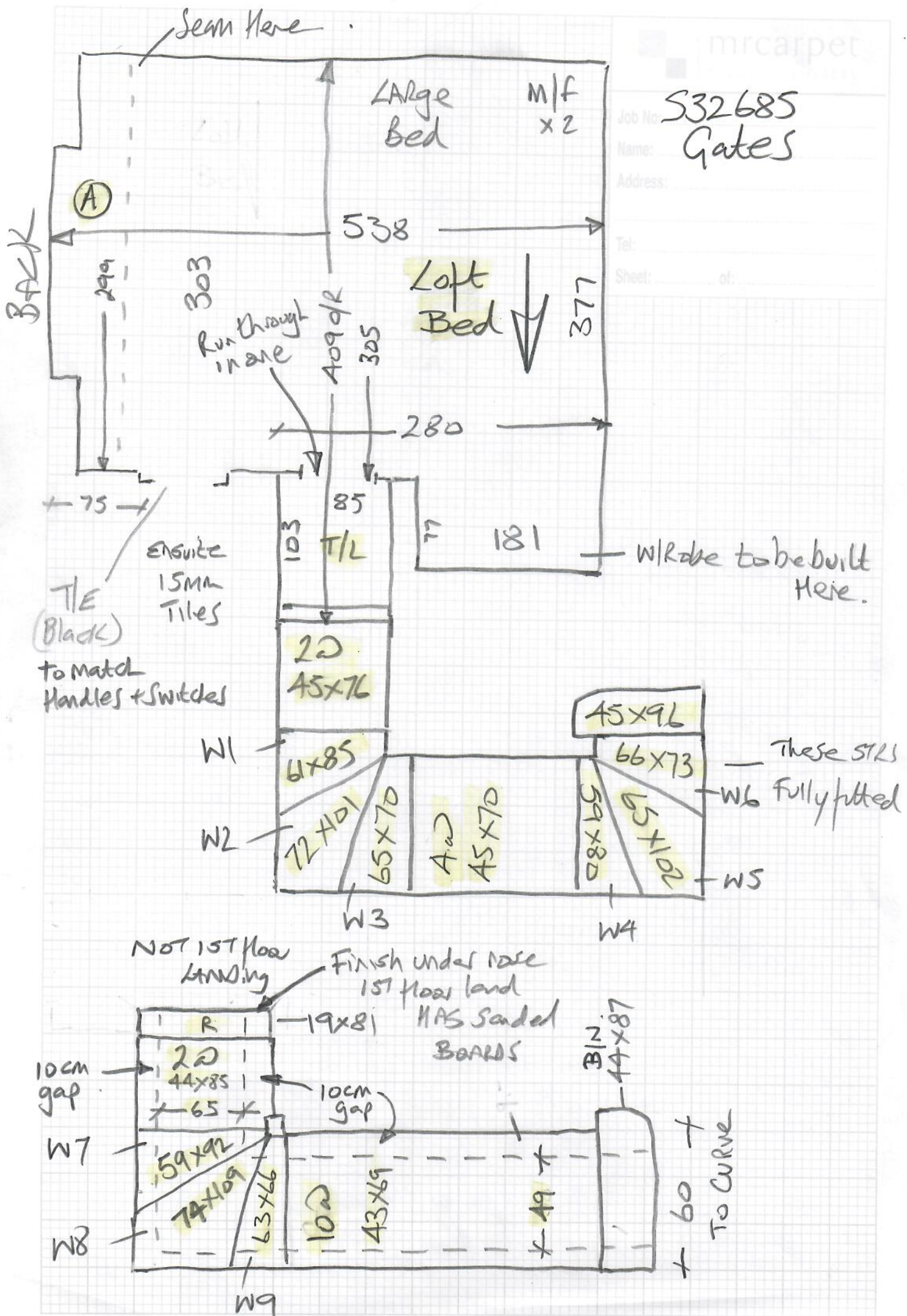

S32685

1st call of 3

Notes for Measure

Estimator: Nigel

Mrs Lucy Gates, 25 Greamesdyke Avenue

Date of Measure: Fri, 10 Sep 21

At: 8:30 - 9:00

Site Address:  
25 Greamesdyke Avenue

Customer Address:  
25 Greamesdyke Avenue

LONDON SW14 7BH

LONDON SW14 7BH

CONTACT: As customer details

Mobile	Home	Office
07718-909405 <i>TIM</i>		

Email:  
pleas obtain

Areas to be done and Description of Measure

2 x sets of stairs (full width to both - but poss runner to first flight but staircase is quite narrow) and Loft Room(s)

*Lucy Goodman 100 @ hotmail.com*

Instructions and Estimators comments

will come in after - please prepare cost sheet - THANKS! - Number on file is Husband Tim

Notes

- 1) DARK Color paintwork on skintings which Scuff during installation .
- 2) Tight Access to loft bed with white walls so may mark during unloading .
- 3) There is movement in lower stairs so paintwork might crack during installation
- 4) Broken Blv

Must Read!

Not entered

Office Ref: S32685

Mrs Lucy Gates, 25 Greamesdyke Avenue

Date of Measure Fri, 10 Sep 21

At 8:30 - 9:00

**Floor:** Wood / Concrete / other \_\_\_\_\_  
**S/edge:** Wood / Concrete / No pin / existing (if existing, allow \_\_\_ sticks to supplement where necessary)  
**Sticking Req'd:** Yes / No Type: Fastset / Other  
**Underlay:** Re-use Existing / New required  
**Type:** 42oz Felt / Fomalux / PU Foam / Luxury PU Foam / LowTog / Durafit  
**Doorbars:** Alloy / Satin Ali / Polished Ali / Anod / Solid Brass / Chrome / Nisheen  
 Seam/Wood/T/Holds: colour \_\_\_\_\_  
**Door Clearance:** OK / Low (advise on quote)  
**Uplift:** No / Yes (if "Yes" - what type?) \_\_\_\_\_  
**Furniture:** No / Yes (if YES, please specify the following) - 1 man / 2 men (Fitter to get paid) £ 20 total/per room  
**Parking Cost:** Free / £ \_\_\_\_\_ per hour  
**Parking Restrictions:** (type) / £ \_\_\_\_\_  
**Congestion Zone:** No / Yes  
**Access:** Easy / Hard / 2 men req'd / 2nd floor? *Panterage x1*  
**Runners:** Whipping / Binding (if binding, specify type)  
**Tape size:** 1½" / 2" / 3" / 5"  
**Style:** Top taping / Side binding  
**Stairrods:** Type \_\_\_\_\_ Nr \_\_\_\_\_ Size \_\_\_\_\_

*Runner + STAIRS*

*Large Bed*

**Must Read: Not entered**

Office Ref: S32685