

535186
MORGAN
26 HUTTONS
AVENUE

loft

York
- Ton-225

510x400

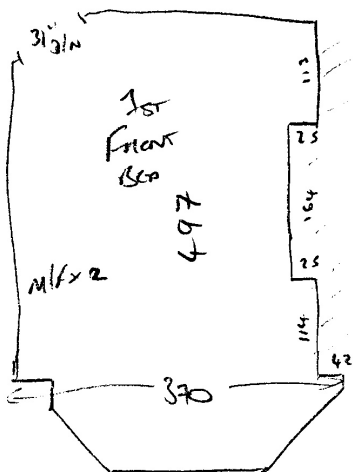

- WOOD
- Exsle
- Aci Ban
- Free Park
- Easy Access
- w/d - YES
- M/F x 2 (111' x 111' + 111' x 111')
- DO NOTS / USE

S35186

1st call of 4

Notes for Measure

Estimator: RichardH

Mrs S Morgan, 26 Hertford Avenue**Date of Measure: Fri, 11 Oct 24****At: 9-10am****Site Address:**26 Hertford Avenue
East Sheen

LONDON

SW14 8EQ

Customer Address:26 Hertford Avenue
East Sheen
LONDON

SW14 8EQ

CONTACT:

As customer details

Mobile
07951-692331Home
020-8876-0786Office
N/P**Email:**

nickhm@btinternet.com

Areas to be done and Description of Measure

AOS Measure main Bed York CTS LUX PU

Instructions and Estimators comments

Not entered

Must Read!**COLLECT SAMPLES****Office Ref: S35186**

Mrs S Morgan, 26 Herford Avenue

Date of Measure Fri, 11 Oct 24

At 9-10am

Floor: Wood / Concrete / other _____

S/edge: Wood/Concrete/No pin/existing (if existing, allow ___ sticks to supplement where necessary)

Sticking Req'd: Yes/No Type: Fastset/Other

Underlay: Re-use Existing / New required

Type: 42oz Felt / Fomalux / PU Foam / Luxury PU Foam / LowTog / Durafit

Doorbars: Alloy / Satin Ali / Polished Ali / Anod / Solid Brass / Chrome / Nisheen
Seam/Wood/T/Holds: colour _____

Door Clearance: OK / Low (advise on quote)

Uplift: No / Yes (if "Yes" - what type?) COTECU / LAY

Furniture: No/Yes (if YES, please specify the following) - 1 man / 2 men (Fitter to get paid) £ 20 total/per room

Parking Cost: Free / £ _____ per hour

Parking Restrictions: (type) / £ _____

Congestion Zone: No / Yes

Access: Easy / Hard / 2 men req'd / 1st floor?

Runners: Whipping / Binding (if binding, specify type)

Tape size: 1½" / 2" / 3" / 5"

Style: Top taping / Side-binding

Stairrods: Type _____ Nr _____ Size _____

Must Read: COLLECT SAMPLES