

S35240**2nd call of 3****Notes for Measure****Estimator: RichardH****Mrs A Hockley, 11 Earl Road****Date of Measure: Wed, 6 Nov 24****At: 10-11am****Site Address:**

11 Earl Road

Customer Address:

11 Earl Road

LONDON**SW14 7JH****LONDON****SW14 7JH****CONTACT:****As customer details**

| | | |
|---------------------|---------------|--------|
| Mobile | Home | Office |
| 07527-012558 | 020-8878-2980 | N/P |

Email:

annahockley@hotmail.com

Areas to be done and Description of Measure

AOS S/landing Pembroke 50 colour Rosewood HD PU JAN FITTING OFFER less 10% note not on the labour element please show

Instructions and Estimators comments

£33 less 10% = £29.70 THEN JAN DISCOUNT please show on Quote

2ND

Must Read!**JAN FITTING DISC****Office Ref: S35240**

Job No: S35240

Name:

Address:

Tel:

Sheet:

1/1

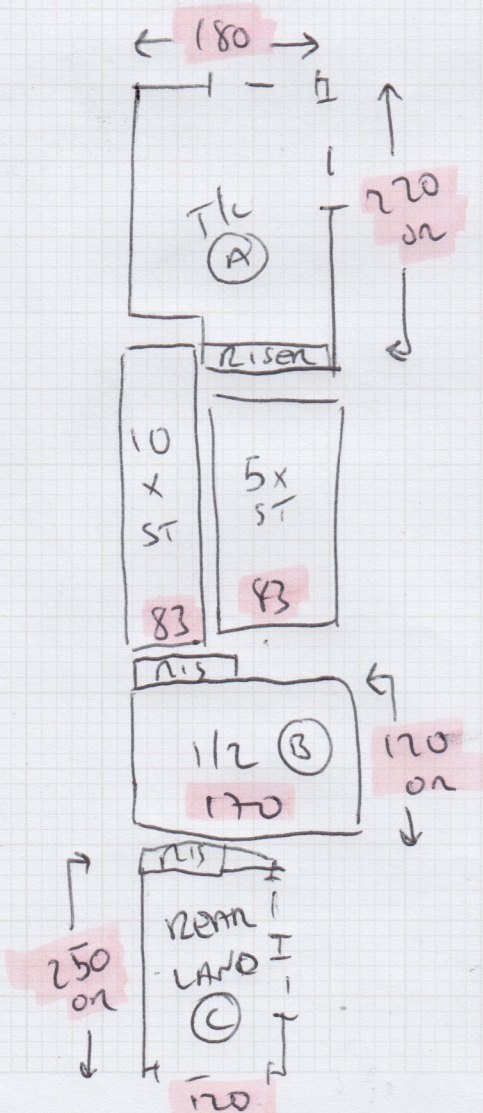
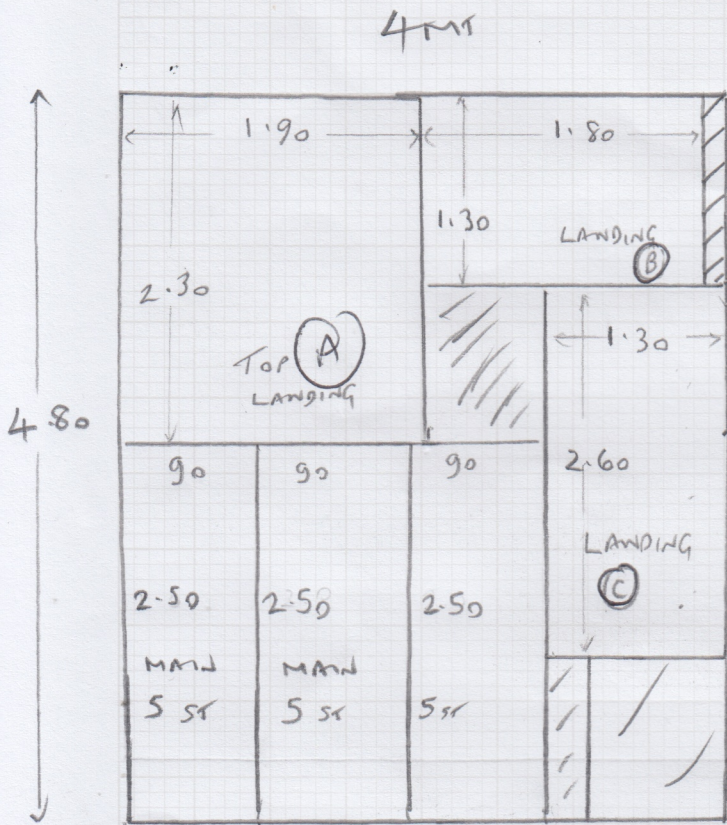

2ND WHEEL OWNERS
JAS



Anna Hockley
11 Earl Road
London
SW14 7JH

East Sheen, London
SW14 8QS
Tel Nr: 020-8876-9126

7th November 2024

FR 17/11
ADRIAN G
SWJ

Quotation - S35240

Area ; Stairs and landings

To supply & fit **Pembroke 50oz** colour ; Rosewood @ **£29.70 m²** (Reduced from £33.00 sq mt)

Heavy duty PU underlay to be laid beneath

Re-using existing gripper rod fixings and supplement where necessary

Existing door bars to remain

Stairs to be fitted full width

Move furniture as necessary (**customer to move small items & personal belongings, any storage furniture must be emptied prior to our visit**),

Price for uplift & disposal of existing materials shown separately below

| | |
|--|------------------|
| Normal Retail Price | £ 1226.00 |
| Less Promotional Discount | - £ 63.00 |
| Discount Price (Valid until end of current month) | £ 1163.00 |
| Additional January fitting discount | -£ 90.00 |
| Total reduced to | £ 1073.00 |

HOCKLEY

OPTIONS

To qualify for the additional discount the order needs to be placed by 30th November

Add uplift & dispose of existing carpets & underlay + £ 68.00

All prices include VAT @ 20%

This quotation is covered by our price match guarantee so please contact us if you obtain a lower price for these goods and services and we will match or beat our competitors quote subject to certain terms & conditions.

Payment terms

For order under £500; FULL PAYMENT with order

For orders over £500; 50% deposit payable with order & balance to be settled at least 48 hours prior to our fitter's arrival as agreed or after 30 days from the date of order placement, whichever comes first.

11,141.00
INC.
ALL
DISCOUNTS

£ 570.50