

S35338

1st call of 3

Notes for Measure

Estimator: Anthony

Mrs Airlie ~~Stavley~~, 250 Sheen Lane

Date of Measure: Mon, 13 Jan 25

At: 10.00 / 11.00

Site Address:

250 Sheen Lane
Sheen

LONDON

SW14 8RL

Customer Address:

250 Sheen Lane

Sheen

LONDON

SW14 8RL

CONTACT: As customer details

Mobile	Home	Office
07974-765673		

Email: ~~airliestavley@gmail.com~~

Areas to be done and Description of Measure

(JD) BATHROOM IN LIBERTY TWIST 40OZ AQUA

STAVLEY

Instructions and Estimators comments

UPLIFT AND REMOVE OLD / NEW UNDERLAY

Must Read!

BORROWED SAMPLE 08/01 AND RETURNED 10/01

Office Ref: S35338

Mrs Airlie Stavley, 250 Sheen Lane

Date of Measure Mon, 13 Jan 25

At 10.00 / 11.00

Floor: Wood / Concrete / other _____

S/edge: Wood/Concrete/No pin/existing (if existing, allow ___ sticks to supplement where necessary)

Sticking Req'd: Yes/No Type: Fastset/Other

Underlay: Re-use Existing / New required

Type: 42oz Felt / Fomalux / PU Foam / Luxury PU Foam / LowTog / Durafit

Doorbars: Alloy / Satin Ali / Polished Ali / Anod / Solid Brass / Chrome / Nisheen
Seam/Wood/T/Holds: colour _____

Door Clearance: OK / Low (advise on quote)

Uplift: No / Yes (if "Yes" - what type?) _____

Furniture: No/Yes (if YES, please specify the following) - 1 man / 2 men (Fitter to get paid) £ _____ total/per room

Parking Cost: Free / £ _____ per hour

Parking Restrictions: (type) / £ _____

Congestion Zone: No / Yes

Access: Easy / Hard / 2 men req'd / _____ floor?

Runners: Whipping / Binding (if binding, specify type)

Tape size: 1½" / 2" / 3" / 5"

Style: Top taping / Side binding

Stairrods: Type _____ Nr _____ Size _____

Must Read: BORROWED SAMPLE 08/01 AND RETURNED 10/01

Office Ref: S35338

Mr Carpet (London) Ltd



Job No: S35338

Name:

Address:

Tel:

Sheet: of:

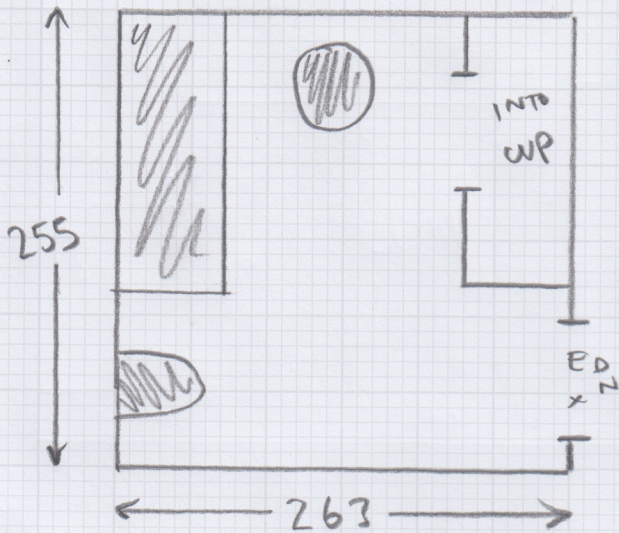

MOTM DAMAGE - CUT UP + LEAVE ON SITE

NEW ULAM, EX GRIPPER + DIBAR

INTO CUP - MUST TO CLEAR