



Job No: 535386

Name: PLANT

Address:

Tel:

Sheet: of:

WESTEND PRACTICE

- ERMINE

620 x 457

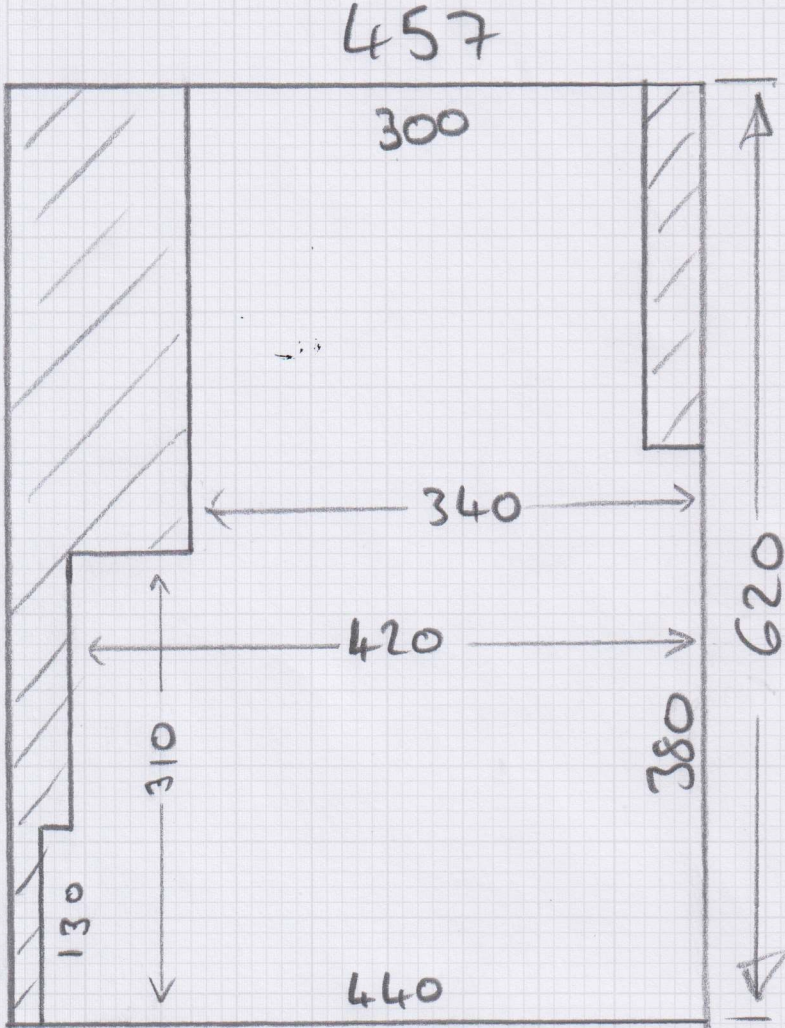

Job No: 535386

Name: PLANT

Address:

Tel:

Sheet: of:

620x457

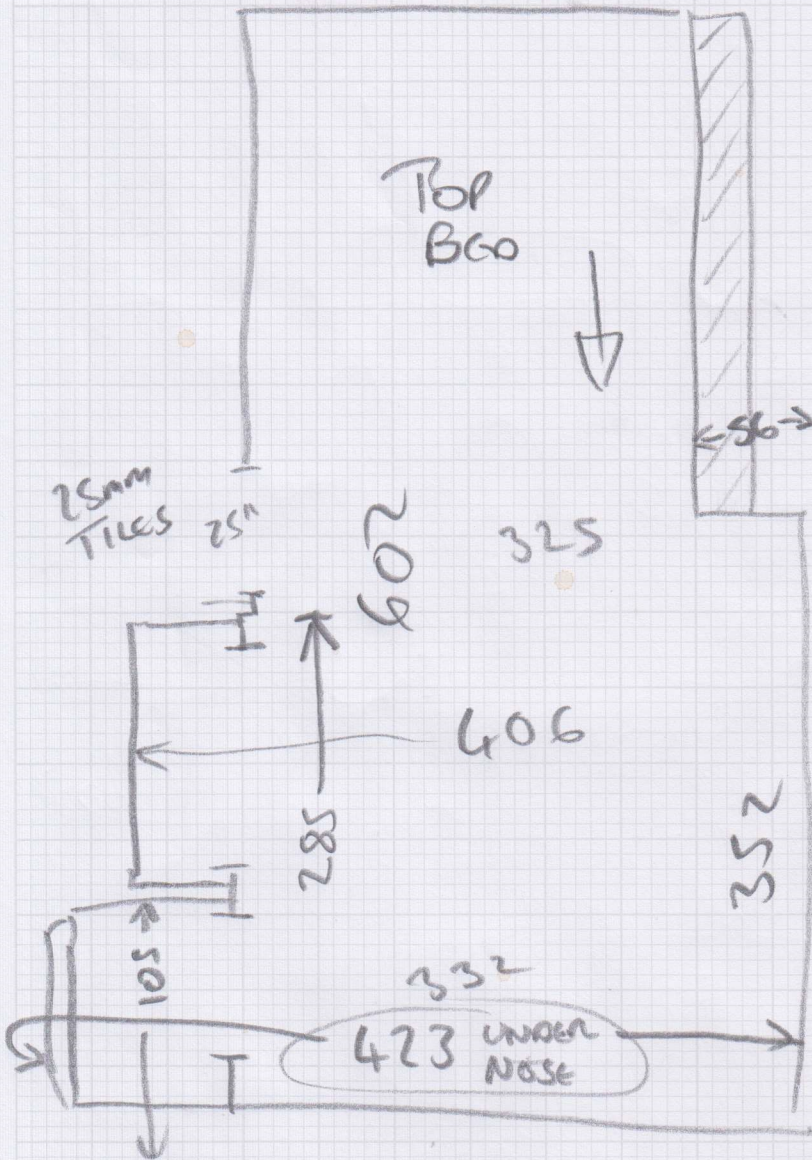

S35386

2nd call of 5

Notes for Measure

Estimator: Jack

Mr & Mrs N Plant, 15 Rectory Road

Date of Measure: Thu, 13 Feb 25

At: 10.00 / 11.00

Site Address:

15 Rectory Road
Barnes

LONDON

SW13 0DU

CONTACT: Nicholas & Roz

Mobile
07718-903120

Home

Office
N/P

Customer Address:

15 Rectory Road
Barnes
LONDON

SW13 0DU

Email:
nicholas_plant@sky.com

Areas to be done and Description of Measure

AOS Daughter's Bedroom Westend prestige colour Ermine TAKE SAMPLE PLEASE prev order FYI S35386 LUX PU

SALE PRICE?

* FIT ASAP - DECS TO COMPLETE 15/2 *

Instructions and Estimators comments

Not entered

Must Read!

TAKE SAMPLE WESTEND PRESTIGE ERMINE TVM

Office Ref: S35386

Mr & Mrs N Plant, 15 Rectory Road

Date of Measure Thu, 13 Feb 25

At 10.00 / 11.00

Floor: Wood / Concrete / other _____

S/edge: Wood/Concrete/No pin/existing (if existing, allow ___ sticks to supplement where necessary) *All*

Sticking Req'd: Yes/No Type: Fastset/Other

Underlay: Re-use Existing / New required

Type: 42oz Felt / Fomalux / PU Foam / Luxury PU Foam / LowTog / Durafit

Doorbars: Alloy / Satin Ali / Polished Ali / Anod / Solid Brass / Chrome / Nisheen
Seam/Wood/T/Holds: colour _____

Door Clearance: OK / Low (advise on quote) *Ali/Silver To Bath Tiles*

Uplift: No / Yes (if "Yes" - what type?) *CPT + felt* *U/LAY* *OR BATH TILES*

Furniture: No/Yes (if YES, please specify the following) - 1 man / 2 men (Fitter to get paid) £ 20 total/per room

Parking Cost: Free / £ _____ per hour

Parking Restrictions: (type) / £ PERMITS 10-12

Congestion Zone: No / Yes

Access: Easy / Hard / 2 men req'd / _____ floor? *2ND*

Runners: Whipping / Binding (if binding, specify type)

Tape size: 1½" / 2" / 3" / 5"

Style: Top taping / Side binding

Stairrods: Type _____ Nr _____ Size _____

Must Read: TAKE SAMPLE WESTEND PRESTIGE ERMINE TVM

