

Job No: **SS5632**
 Name: **Doney**
 Address: _____
 Tel: _____
 Sheet: _____ of _____

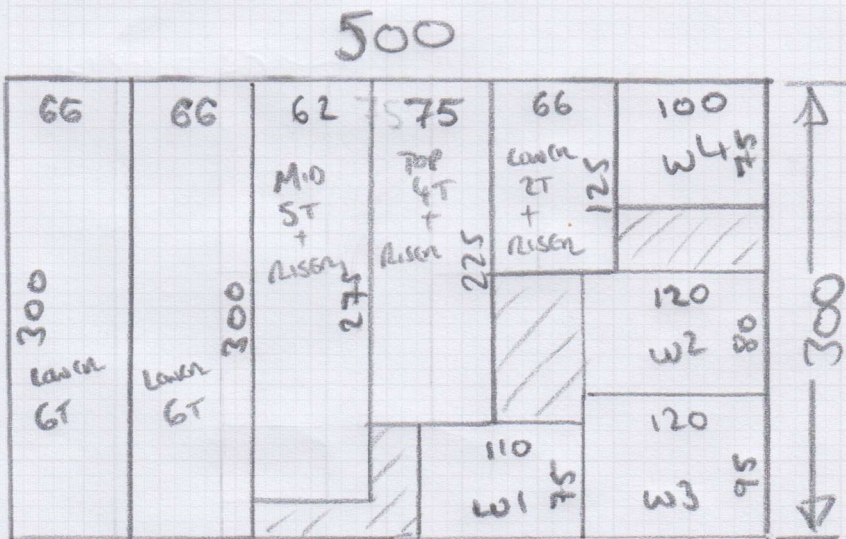

380 x 400

(DECO, ALPINE,
F.W.C HAMMERSBANE)



300 x 500

(THE ISLES)

Job No: 538432

Name: Doney

Address:

Tel:

Sheet: of:

Riser = 18 x 91

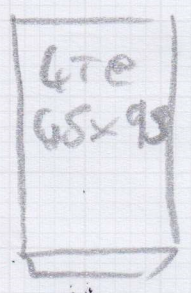

* Allow 10cm GAP EXCLUSIVE

* LEAD WOOD ON ALL STAIRS
NOSES ARE 1-2mm LOWER

Riser = 19 x 79

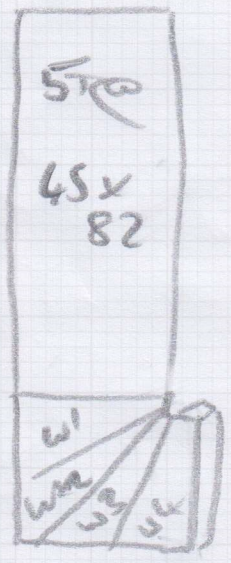

W1 = 65 x 92

W2 = 70 x 110

W3 = 86 x 107

W4 = 63 x 85

Riser = 17 x 83



~~Riser = 15 x 93~~

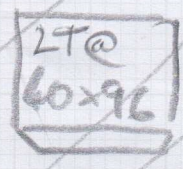

NOT THIS SECTION

Mr Charlie Dorey, 6a Salvin Road

Date of Measure: Mon, 3 Mar 25

At: 11am to 12 midday

Site Address:
6a Salvin Road

Customer Address:
6a Salvin Road

LONDON SW15 1DR

LONDON SW15 1DR

CONTACT: As customer details

Mobile	Home	Office
07551-515424		

Email: cpdorey@outlook.com

Areas to be done and Description of Measure

AOS Runners total 30 strs OPT 1 New England 2 OPT 2 DECO Saanen Opt 3 Isles tape border HD PU ALSO TAKE NEW ENGLAND H BONE SA

①

②

TRESCO

④

POSS. GT. WOOL ALPINE

③

FEATHER
CLASSICS
H'BONE
CUARK

Instructions and Estimators comments

Versus Hillside Cpts cust v price driven Please discuss symmetry of DECO and side view of u/lay

①	38.99	78
②	32.50	65
③	21.99	44
④	33.50	67

Must Read! TAKE SAMPLES OUTLINED

Office Ref: S35432

Mr Charlie Dorey, 6a Salvin Road

Date of Measure Mon, 3 Mar 25

At 11am to 12 midday

Floor: Wood / Concrete / other ENGINEERED WOOD
S/edge: Wood/Concrete/No pin/existing (if existing, allow ___ sticks to supplement where necessary) SHORT PIN?
Sticking Req'd: Yes/No No Type: Fastset/Other
Underlay: Re-use Existing / New required H.D.
Type: 42oz Felt / Fomalux / PU Foam / Luxury PU Foam / LowTog / Durafit
Doorbars: Alloy / Satin Ali / Polished Ali / Anod / Solid Brass / Chrome / Nisheen Seam/Wood/T/Holds: colour _____
Door Clearance: OK / Low (advise on quote)
Uplift: No / Yes (if "Yes" - what type?) _____
Furniture: No/Yes (if YES, please specify the following) - 1 man / 2 men (Fitter to get paid) £ _____ total/per room
Parking Cost: Free / £ 4 per hour
Parking Restrictions: (type) / £ Free P&D
Congestion Zone: No / Yes
Access: Easy / Hard / 2 men req'd / _____ floor?
Runners: Whipping / Binding (if binding, specify type)
Tape size: 1½" / 2" / 3" / 5"
Style: Top taping / Side binding
Stairrods: Type _____ Nr _____ Size _____

Must Read: TAKE SAMPLES OUTLINED

FAO JB



Measure S35432

Charlie Dorey

Measure Monday 3rd March 2025

11am to 12 Midday

Please take New England 2 swatch

PLEASE TAKE Deco Saanen (discuss symmetry of lines)

PLEASE TAKE Isles Take swatch £65 LESS 10%

Very price driven

Two other retailers have measured (**Hillside is one)

He liked the idea ** that they employ their own, I explained all our teams have been working for us for a long time

Mentioned we are a member of the Carpet Foundation

12 months guarantee on fitting

2 years back up if the supplier is a member of the CF as well

Explained our balance is two days before hand (use a credit card for rule 75) as well as our membership of the CF offers more back up for the customer

Definitely a LEE job

If we get this, we have to be fully set up explained plans and all notes

All points of customer expectations what is reasonable must be confirmed in our notes

Fires questions like you are in an interview manner which is fair enough, but from experience we must be detailed and professional in our approach

They only want this for 3 years and will be moving on, just FYI