

Job No: 535451

Name: PAINE

Address:

Tel:

Sheet: of:

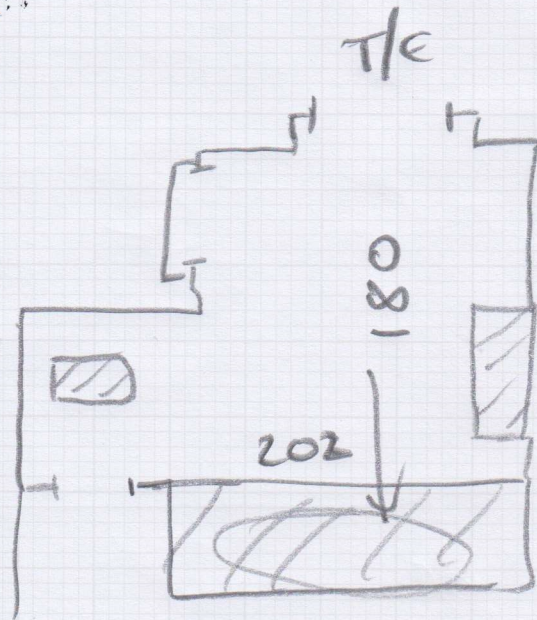

215 x 200

- Ex. Lut Down Well
- Lay Over

S35451

1st call of 3

Notes for Measure

Estimator: Jack

Mrs Heather Paine, 12 Alton Road

Date of Measure: Tue, 18 Mar 25

At: 10-11am

Site Address:
12 Alton Road

Customer Address:
12 Alton Road

RICHMOND TW9 1UJ

RICHMOND TW9 1UJ

CONTACT: As customer details

Mobile	Home	Office
07946-615871	020-8940-9934	N/P

Email:
hypaine@gmail.com

Areas to be done and Description of Measure

AOS X S26647 Bathroom currently in Karndean fitted by us in 2014 / TAKE MODESTO SHEET COLLECT PARKING PERMIT PLEASE

MODESTO DESIGN - MO/O (

Instructions and Estimators comments

complete u/d of ext LVT & sub floor

↑
No Need
All OK TO LAY OVER

Must Read! TAKE MODESTO SHEET VINYL BOOK TVM

Office Ref: S35451

Mrs Heather Paine, 12 Alton Road

Date of Measure Tue, 18 Mar 25

At 10-11am

Floor: Wood / Concrete / other _____

S/edge: Wood/Concrete/No pin/existing (if existing, allow ___ sticks to supplement where necessary)

Sticking Req'd: Yes/No Type: Fastset/Other *LAM Over Ex. LVT*

Underlay: Re-use Existing / New required

Type: 42oz Felt / Fomalux / PU Foam / Luxury PU Foam / LowTog / Durafit

Doorbars: Alloy / Satin Ali / Polished Ali / Anod / Solid Brass / Chrome / Nisheen Seam/Wood/T/Holds: colour _____

Door Clearance: OK / Low (advise on quote)

Uplift: No / Yes (if "Yes" - what type?) _____

Furniture: No/Yes (if YES, please specify the following) - 1 man / 2 men (Fitter to get paid) £_____ total/per room

Parking Cost: Free / £_____ per hour

Parking Restrictions: (type) / £_____ *PERMITS ONLY*

Congestion Zone: No / Yes

Access: Easy / Hard / 2 men req'd / 1st floor?

Runners: Whipping / Binding (if binding, specify type)

Tape size: 1 1/2" / 2" / 3" / 5"

Style: Top taping / Side binding

Stairrods: Type _____ Nr _____ Size _____

Must Read: TAKE MODESTO SHEET VINYL BOOK TVM