

Job No: S35519  
 Name: BROATCH  
 Address: \_\_\_\_\_  
 Tel: \_\_\_\_\_  
 Sheet: \_\_\_\_\_ of: \_\_\_\_\_

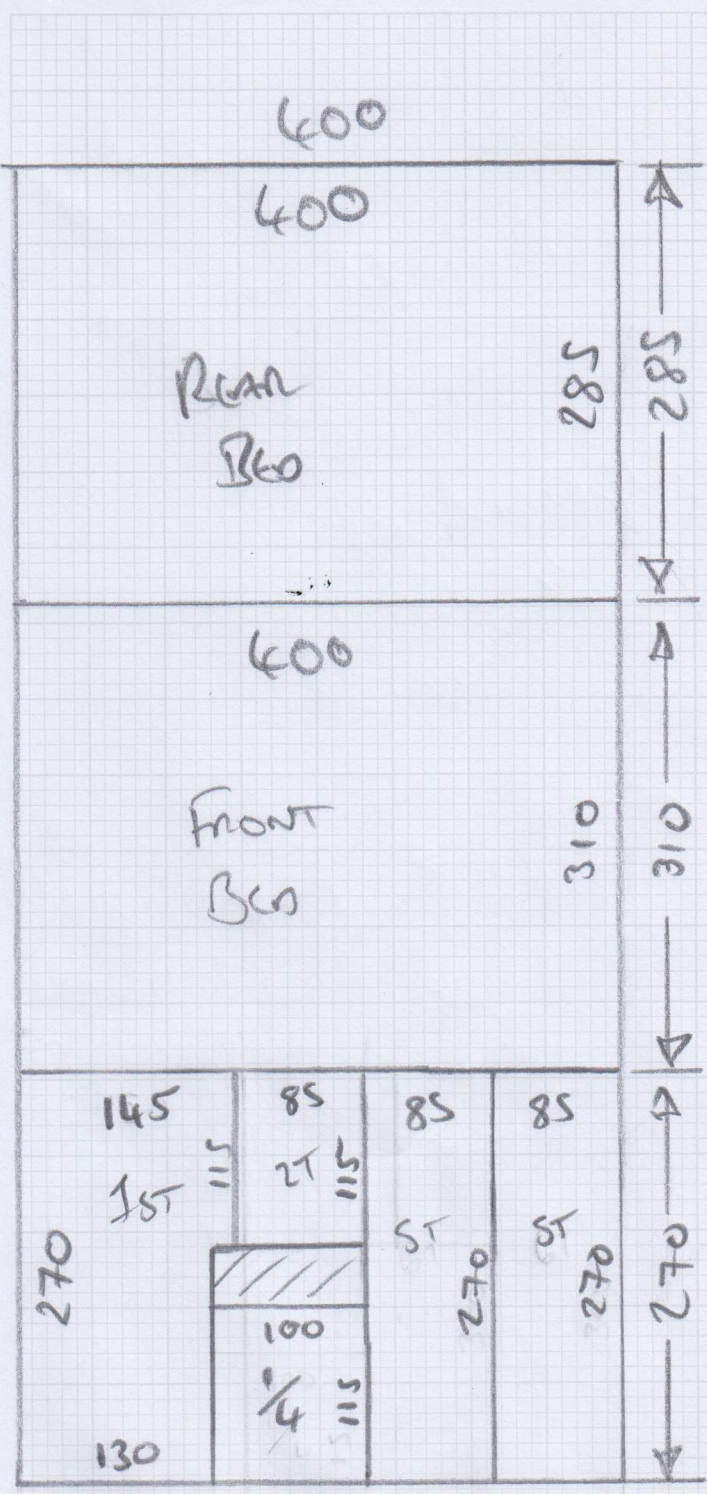

285 x 400  
 310 x 400  
 270 x 400

Job No: 535519  
 Name: BROATCH  
 Address: \_\_\_\_\_  
 Tel: \_\_\_\_\_  
 Sheet: \_\_\_\_\_ of: \_\_\_\_\_

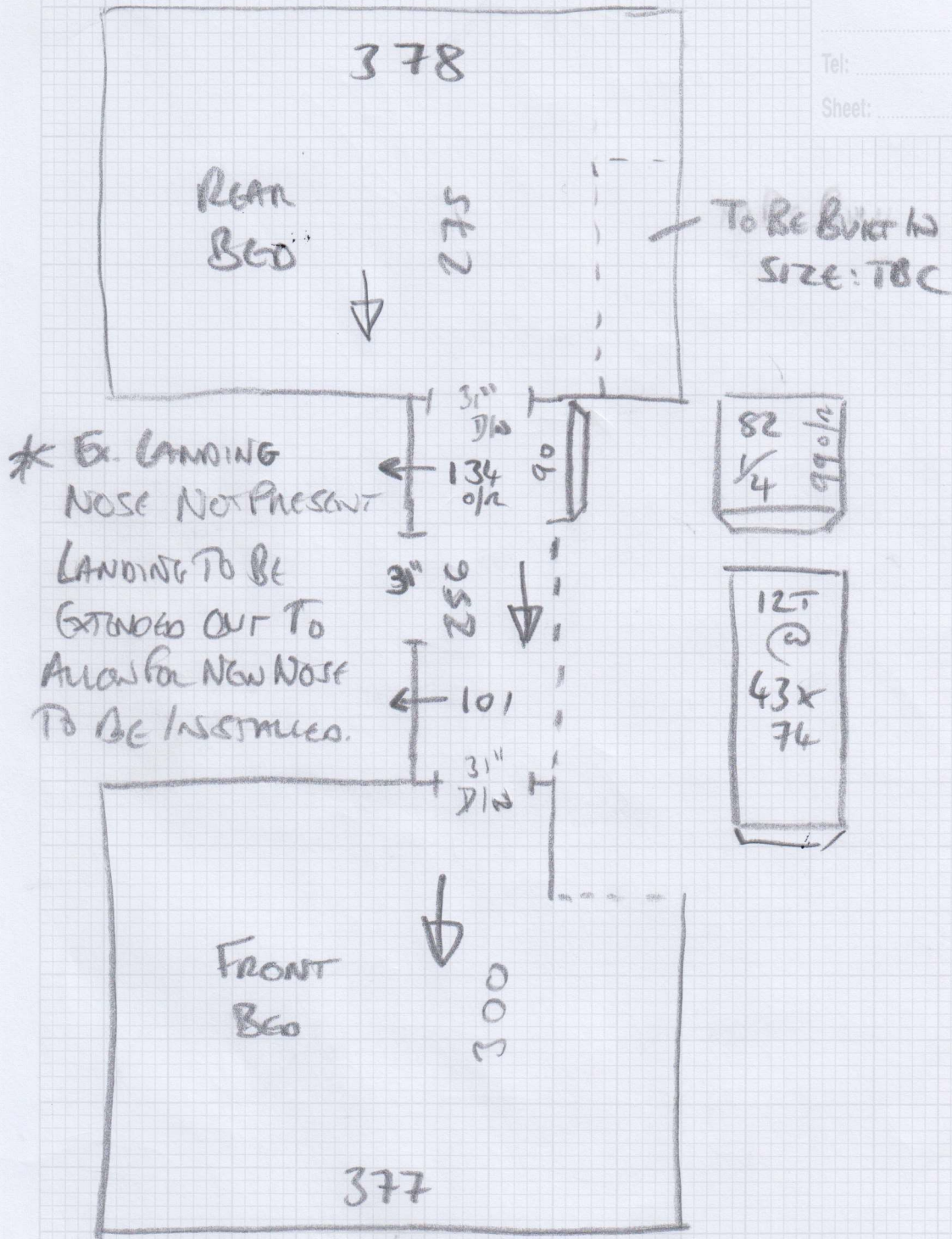

NOTE - SATU Tiles Are 7-10mm High

↳ Discuss ON FTI - D29 MAY NOT WORK

Mr Thomas Broatch, 46 Alder Road

Date of Measure: Fri, 11 Apr 25

At: 10.00 /11.00

Site Address:

46 Alder Road  
Sheen

LONDON

SW14 8ER

Customer Address:

46 Alder Road  
Sheen  
LONDON

SW14 8ER

CONTACT: As customer details

Mobile	Home	Office
07805-818521		

Email: tbbroatch@gmail.com

Areas to be done and Description of Measure

(JD) STAIRS / LANDING / TWO BEDS (I THINK HE WANT A RUNNER ON THE STAIRS) WESTEX BRIAR SOYA WITH SATIN BRASS BARS (STAIRRODS)

HO. PO

ADVISE 8mm  
CPT + U/LAY 9mm  
THICKNESS FOR  
DOOR TRIMMING

~~NO FRAMES!~~

Instructions and Estimators comments

FITTING AT THE END OF MY / BUILDERS ON SITE BUT OKAY TO MEASURE

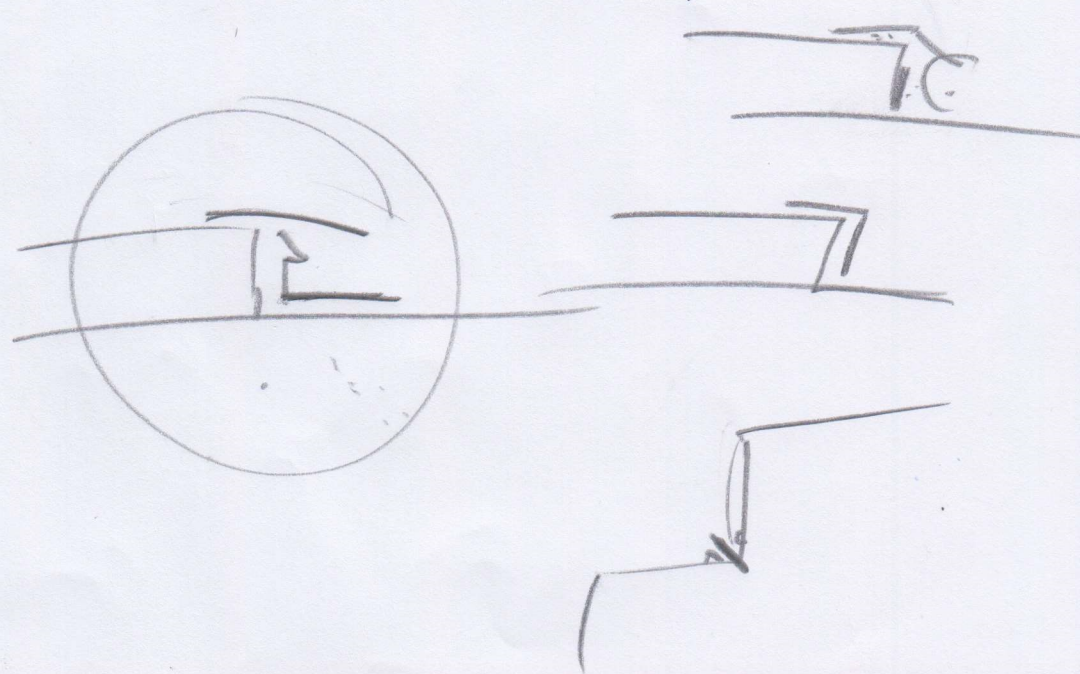

**Must Read!** WALKING DISTANCE

Office Ref: S35519

Mr Thomas Broatch, 46 Alder Road

Date of Measure Fri, 11 Apr 25

At 10.00 /11.00

**Floor:** Wood / Concrete / other \_\_\_\_\_

**S/edge:** Wood / Concrete / No pin / existing (if existing, allow \_\_\_ sticks to supplement where necessary)

**Sticking Req'd:** Yes / No Type: Fastset / Other

**Underlay:** Re-use Existing / New required

**Type:** 42oz Felt / Fomalux / PU Foam / H.O. / Luxury PU Foam / LowTog / Durafit

**Doorbars:** Alloy / Satin Ali / Polished Ali / Anod / Solid Brass / Chrome / Nisheen Seam / Wood / T / Holds: colour \_\_\_\_\_

**Door Clearance:** OK / Low (advise on quote) SATIN BRASS

**Uplift:** No / Yes (if "Yes" - what type?) \_\_\_\_\_

**Furniture:** No / Yes (if YES, please specify the following) - 1 man / 2 men (Fitter to get paid) £ \_\_\_\_\_ total / per room

**Parking Cost:** Free / £ \_\_\_\_\_ per hour CUST. TO EMPTY ✓

**Parking Restrictions:** (type) / Driveway on Plan

**Congestion Zone:** No / Yes \_\_\_\_\_

**Access:** Easy / Hard / 2 men req'd / 1st floor?

**Runners:** Whipping / Binding (if binding, specify type)

**Tape size:** 1½" / 2" / 3" / 5" Free Width

**Style:** Top taping / Side binding

**Stairrods:** Type \_\_\_\_\_ Nr \_\_\_\_\_ Size \_\_\_\_\_

Must Read: WALKING DISTANCE