

Job No: 535549
 Name: THURSDOWN
 Address: INTONIONS
 Tel: _____
 Sheet: _____ of _____

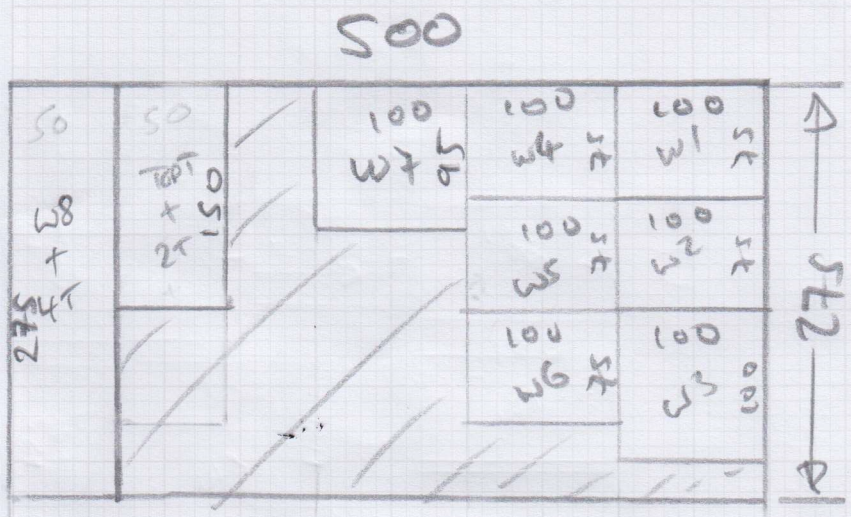

ROYALTY
 - FLINT
 275 x 500

FIXED PERIMETER ✓

Job No: 535549
 Name: THISTOWN
 Address: INTRON 5
 Tel: _____
 Sheet: _____ of: _____

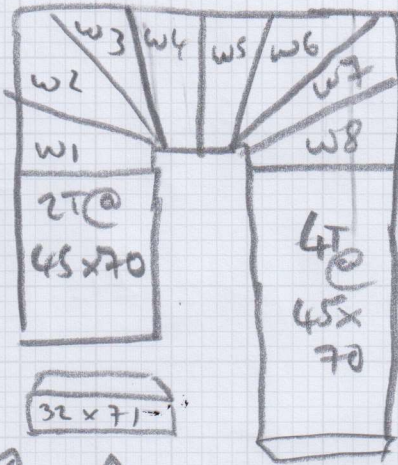

Riser = 18x67

- w1 = 61x79
- w2 = 63x98
- w3 = 86x100
- w4 = 63x70
- w5 = 63x81
- w6 = 63x103
- w7 = 83x106
- w8 = 65x70

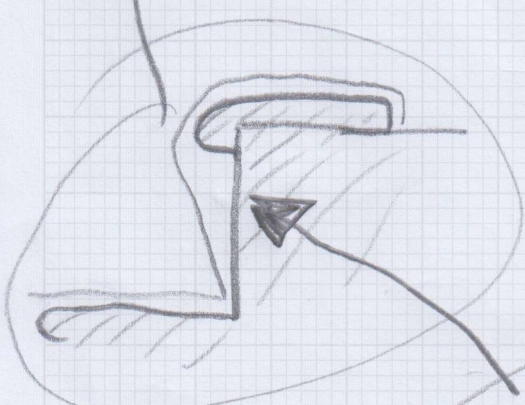

FIT UP RISER ONLY

S35549

2nd call of 4

Notes for Measure

Estimator: Jack

Thistledown Interiors, 31 Suffolk Road

Date of Measure: Fri, 2 May 25

At: 11-12

Site Address:
31 Suffolk Road

Customer Address:
81 Huntingfield Road

LONDON SW13 9NB

LONDON SW15 5EA

CONTACT: Jenna Dickinson

Mobile	Home	Office
07533-444211	N/P	N/P

Email:
jenna@thistledown-interiors.com

Areas to be done and Description of Measure

Loft Stairs for Royalty Flint (Riviera) to match lower flight. POSS RUNNER IF STAIRS WOULD ACCOMODATE OTHERWISE FULL WIDTH!

Fixed Runner - 10cm

94 → 84.60

Instructions and Estimators comments

Lower flight is whipped runner.

Must Read!

Access via Gary BOS 07709-417915

Office Ref: S35549

Thistledown Interiors, 31 Suffolk Road

Date of Measure Fri, 2 May 25

At 11-12

Floor: Wood / Concrete / other _____

S/edge: Wood/Concrete/No pin/existing (if existing, allow ___ sticks to supplement where necessary)

Sticking Req'd: Yes/ No Type: Fastset/Other *AN NEW REQ'D*

Underlay: Re-use Existing / New required *HQ-? ON MATS PREVIOUS ORDER*

Type: 42oz Felt / Fomalux / PU Foam / Luxury PU Foam / LowTog / Durafit

Doorbars: Alloy / Satin Ali / Polished Ali / Anod / Solid Brass / Chrome / Nisheen Seam/Wood/T/Holds: colour _____

Door Clearance: OK / Low (advise on quote)

Uplift: No / Yes (if "Yes" - what type?) _____

Furniture: No/Yes (if YES, please specify the following) - 1 man / 2 men (Fitter to get paid) £_____ total/per room

Parking Cost: Free / £_____ per hour

Parking Restrictions: (type) / £ Permit 10-12

Congestion Zone: No / Yes

Access: Easy / Hard / 2 men req'd / _____ floor?

Runners: Whipping / Binding (if binding, specify type)

Tape size: 1½" / 2" / 3" / 5"

Style: Top taping / Side binding

Stairrods: Type _____ Nr _____ Size _____

Must Read: Access via Gary BOS 07709-417915