

Job No:  
Name: S 35843  
Address: Hide  
Tel:  
Sheet:

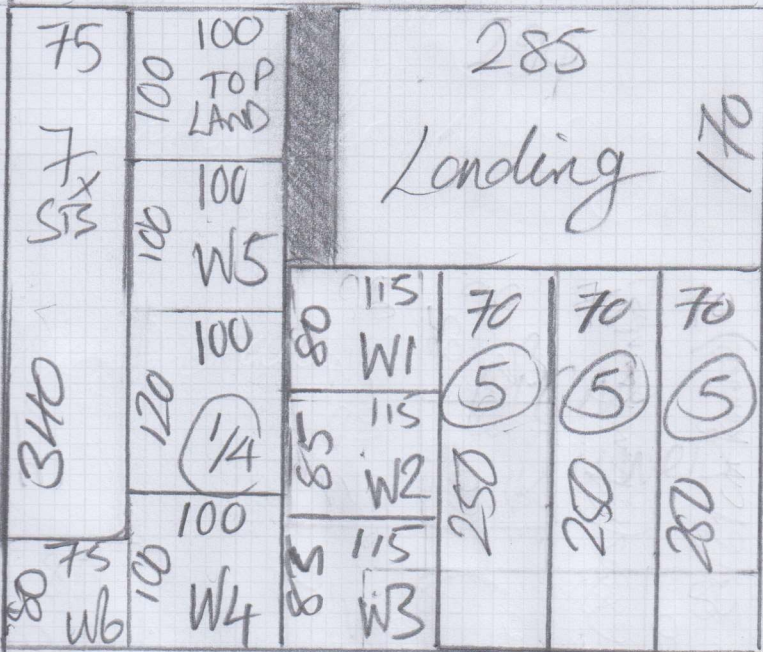

The Isles  
420 x 5M

Job No:  
Name: S35843  
Address: Hide  
Tel:  
Sheet: of:

Loft Bathroom  
(184 x 205)

Minus Shower tray 100 x 87  
Ply + Mastic

- ✓ Top Landing = 87 x 88
- ✓ ~~7~~ x Stairs @ . 50 x 67 + 1x Chrome (S)
- ✓ W1 = 73 x 75 W3 = 75 x 71 W5 = 87 x 96
- ✓ W2 = 77 x 95 W4 = 73 x 86 W6 = 73 x 67

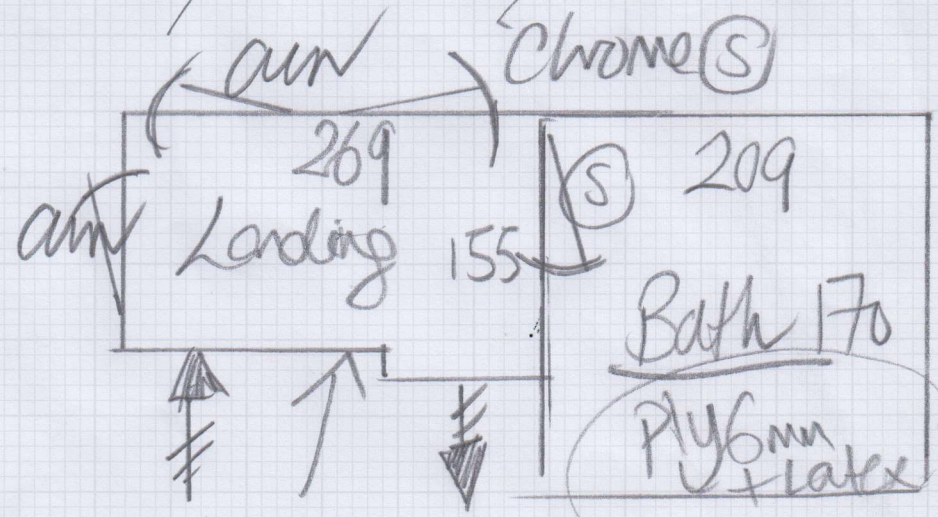

Lower Stairs New Grippe to lower sts & landing.

- ✓ 2 steps @ . 50 x 76 (Riser 61cm)
- ✓ 1/4 Landing (Template req.) 110 x 76
- ✓ 12 steps @ 50 x 76 (Riser 61cm)

S35843

1st call of 3

Notes for Measure

Estimator: Chris

Mr & Mrs Hide, 6 Manor Gardens

Date of Measure: Fri, 17 Oct 25

At: 10-11 +12 MINS

Site Address:

6 Manor Gardens

Customer Address:

6 Manor Gardens

RICHMOND

TW9 1XX

RICHMOND

TW9 1XX

CONTACT:

As customer details

Mobile	Home	Office
07765-257273		

Email:

john@johnhide.com

Areas to be done and Description of Measure

2 Baths - Moduleo. ALL S&L - The Isles (+ taped runner to 1st flight).

Instructions and Estimators comments

Check sub-floor etc

1ST

Must Read!

Customer will be home

Office Ref: S35843

Mr & Mrs Hide, 6 Manor Gardens

Date of Measure Fri, 17 Oct 25

At 10-11

Floor: Wood / Concrete / other \_\_\_\_\_

S/edge: Wood/Concrete/No pin/existing (if existing, allow \_\_\_ sticks to supplement where necessary) *Low + Low S/S only*

Sticking Req'd: Yes/No Type: Fastset/Other

Underlay: Re-use Existing / New required

Type: 42oz Felt / Fomalux / PU Foam / Luxury PU Foam / LowTog / Durafit

Doorbars: Alloy / Satin Ali / Polished Ali / Anod / Solid Brass / Chrome / Nisheen Seam/Wood/T/Holds: colour X2

Door Clearance: OK / Low (advise on quote)

Uplift: No / Yes (if "Yes" - what type?) As per todo

Furniture: No/Yes (if YES, please specify the following) - 1 man / 2 men (Fitter to get paid) £ \_\_\_\_\_ total/per room

Parking Cost: Free / £ \_\_\_\_\_ per hour

Parking Restrictions: (type) / £ Has a permit

Congestion Zone: No / Yes

Access: Easy / Hard / 2 men req'd / \_\_\_\_\_ floor?

Runners: Whipping / Binding (if binding, specify type)

Tape size: 1½" / 2" / 3" / 5" TBC

Style: Top taping / Side binding TBC

Stairrods: Type \_\_\_\_\_ Nr \_\_\_\_\_ Size \_\_\_\_\_ TBC

Must Read: Customer will be home