

Job No:

Emily Yang

Address:

S35907

Tel:

Sheet

of:

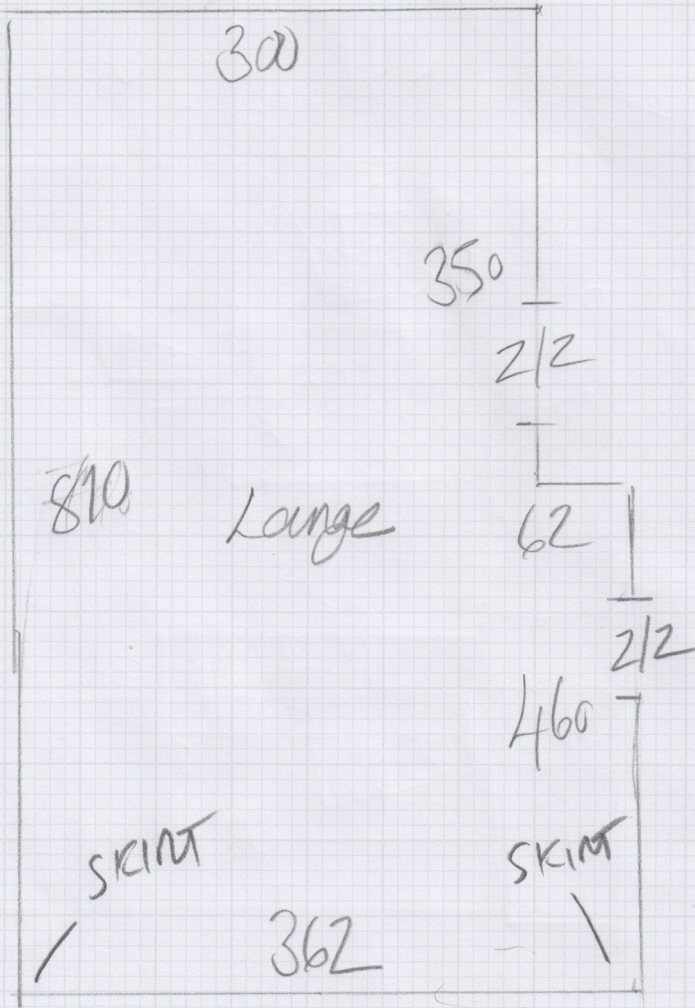

1/2

stairs

12 @ 50x72.1

+ Rise @ 28cm  
x 72.1

Wants 8cm  
either side  
as runner

AU STU AS 56 cm  
RUNNER - 8cm GAP EITHER  
SIDE

Job No: S35907

Name:

Address:

Tel:

Sheet: 2/2

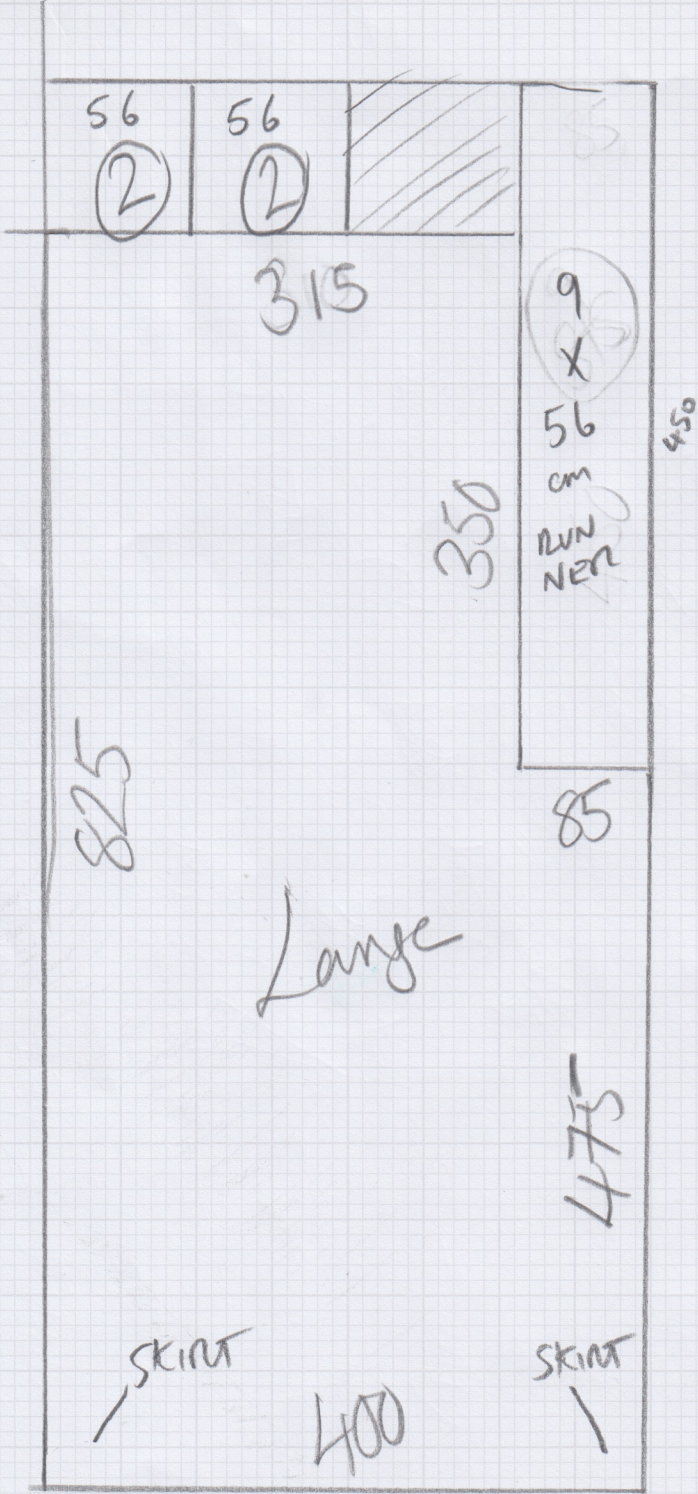

9.25 X 4.00

Mrs Emily Young, 3 Brathway Road

Date of Measure Thu, 13 Nov 25

At 10-11am

Floor: Wood / Concrete / other \_\_\_\_\_

S/edge: Wood/Concrete/No pin/existing (if existing, allow \_\_ sticks to supplement where necessary) Lounge new to stairs.

Sticking Req'd: Yes/No Type: Fastset/Other

Underlay: Re-use Existing / New required HD PU 6mm

Type: 42oz Felt / Fomalux / PU Foam / Luxury PU Foam / LowTog / Durafit

Doorbars: Alloy / Satin Ali / Polished Ali / Anod / Solid Brass / Chrome / Nisheen Seam/Wood/T/Holds: colour \_\_\_\_\_

Door Clearance: OK / Low (advise on quote) Due to doors

Uplift: No / Yes (if "Yes" - what type?) \_\_\_\_\_

Furniture: No/Yes (if YES, please specify the following) - 1 man / 2 men (Fitter to get paid) £ \_\_\_\_\_ total/per room X10

Parking Cost: Free / £ \_\_\_\_\_ per hour

Parking Restrictions: (type) / £ \_\_\_\_\_ Husband has an account to put fitter on

Congestion Zone: No / Yes

Access: Easy / Hard / 2 men req'd / EF floor?

Runners: Whipping / Binding (if binding, specify type) Red

Tape size: 1 1/2" / 2" / 3" / 5"

Style: Top taping / Side binding

Stairrods: Type \_\_\_\_\_ Nr \_\_\_\_\_ Size \_\_\_\_\_

Must Read: Mr Andy Young 07976-352377