

S35911

2nd call of 3

Notes for Measure

Estimator: Anthony

Mrs J Bunting, 32 Richmond Park Road

Date of Measure: Tue, 11 Nov 25

At: ~~10:00 - 11:00~~

PM
6

Site Address:

32 Richmond Park Road
East Sheen
LONDON SW14 8JT

Customer Address:

32 Richmond Park Road
East Sheen
LONDON SW14 8JT

CONTACT: As customer details

Mobile	Home	Office
00000-000000	020-8878-2624	N/P

Email: generalist2@btinternet.com

Areas to be done and Description of Measure

AOR - Mid Landing, Top Stairs and Top Landing same spec as previous orders

Kingston - Mocho. 14.60
- 16.00.
HD foam
W/ dispoe ->

Instructions and Estimators comments

Not entered

Wants BA Xmas.

Must Read!

Not entered

Office Ref: S35911

Mrs J Bunting, 32 Richmond Park Road

Date of Measure Tue, 11 Nov 25

At 10:00 - 11:00

Floor: Wood / Concrete / other _____

S/edge: Wood/Concrete/No pin/existing (if existing, allow ___ sticks to supplement where necessary)

Sticking Req'd: Yes/No Type: Fastset/Other

Underlay: Re-use Existing / New required

Type: 42oz Felt / Fomalux / PU Foam / Luxury PU Foam / LowTog / Durafit

Doorbars: Alloy / Satin Ali / Polished Ali / Anod / Solid Brass / Chrome / Nisheen
Seam/Wood/T/Holds: colour _____

Keep existing if poss.

Door Clearance: OK / Low (advise on quote)

Uplift: No / Yes (if "Yes" - what type?)

UP / DISPOSE carpet way

Furniture: No/Yes (if YES, please specify the following) - 1 man / 2 men (Fitter to get paid) £_____ total/per room

Parking Cost: Free / £_____ per hour

Parking Restrictions: (type) / £_____ *after 12 - or park in driveway*

Congestion Zone: No / Yes

Access: Easy / Hard / 2 men req'd / _____ floor?

Runners: Whipping / Binding (if binding, specify type)

Tape size: 1½" / 2" / 3" / 5"

Style: Top taping / Side binding

Stairrods: Type _____ Nr _____ Size _____

Must Read: Not entered



Job No:

Name:

Address:

Tel:

Sheet: of:

Bunting
835911

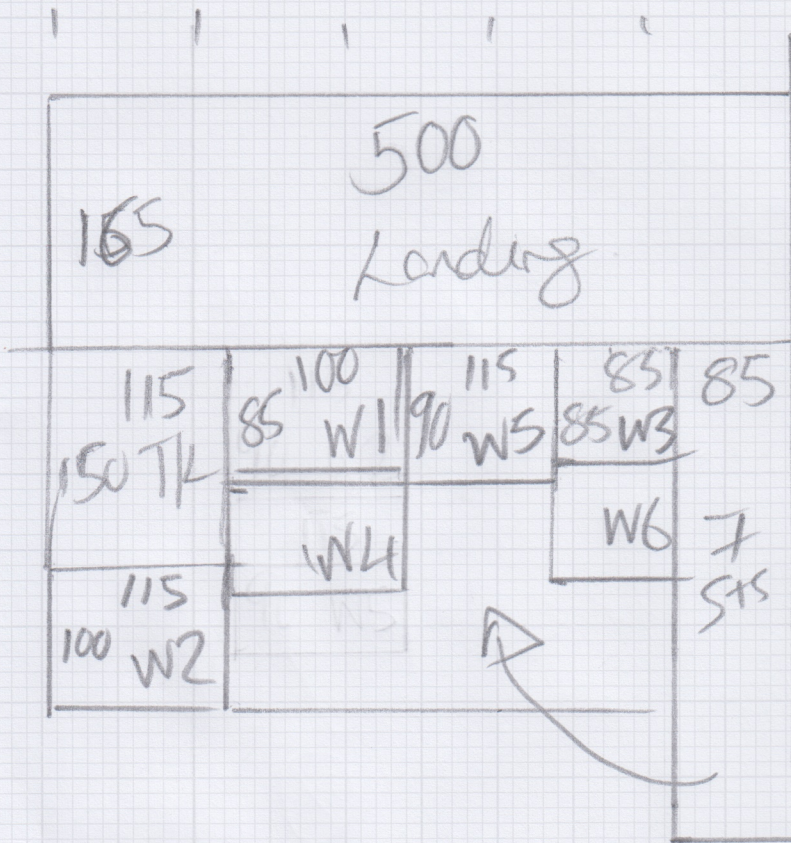

H 15 x 3m

Job No: Bunting
 Name: S359M
 Address: TUE-11-NOV
 Tel: _____
 Sheet: _____ of _____

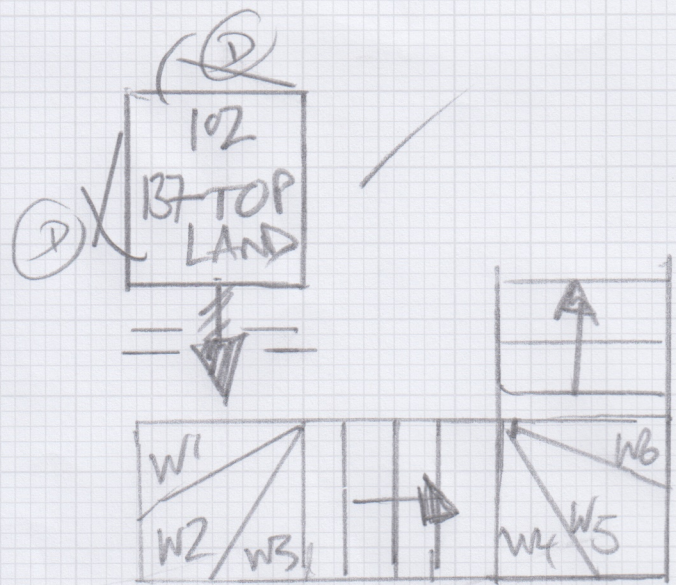

- Step 50x76 ✓
- W1 = 75x91 ✓
- W2 = 90x105 ✓
- W3 = 75x75 ✓
- 3@ 30x76 ✓
- W4 = 75x91 ✓
- W5 = 90x105 ✓
- W6 = 75x75 ✓
- 3@ 50x78 ✓

