

mrcarpet  
Job No: W12460  
Name: BUNKE & WILLS  
Address: REMOVES LTD  
69 STADIUM STADIUMS  
Tel: SW17 0AR  
Sheet: ..... of: .....

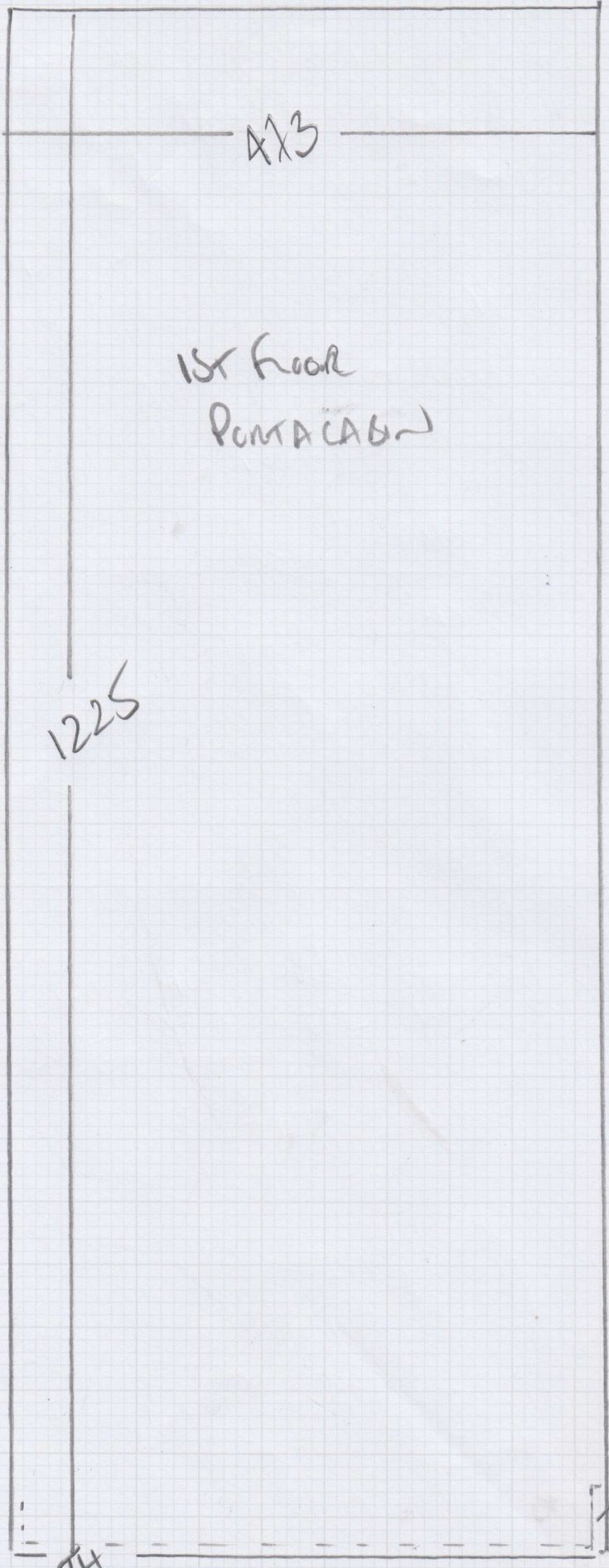

1st Floor  
PONTACABIN

1225

25mm DEEP  
DOOR ENTRANCE

!! 2 MEN REQUIRED TO  
GET CABLE UP METAL  
STAIRCASE !!

STUNNER BY WILLS FROM

TELEPHONE BY CABLE  
NEEDS RE-ROUTING  
TO BE PUT IN FRONT OF  
CABLE (HAS ENOUGH SPACE)

W12460

2nd call of 2

Notes for Measure

Estimator: Colin

Burke & Wills Removals Limited, 69 Wimbledon Stadium Business Ce

Date of Measure: Thu, 4 Jan 18

At: 9.30am-10.30am

Site Address:

69 Wimbledon Stadium Business Centr  
Riverside Road

LONDON SW17 OAR

CONTACT: As customer details

Mobile	Home	Office
07889-815580 GREG		020-8947-9001

Customer Address:

69 Wimbledon Stadium Business Centr  
Riverside Road

LONDON SW17 OAR

Email:

29 DEER LANE LEAD  
SW19 3NW

Areas to be done and Description of Measure

Portacabin (13m x 5m approx) Take JHS samples Stickdown job?

greg@burkeandwills.co.uk

Instructions and Estimators comments

Fitting required by 11/01/18 Possible Durafit job?

Must Read!

ask for Greg

Office Ref: W12460

Burke & Wills Removals Limited, 69 Wimbledon Stadium Business Ce

Date of Measure Thu, 4 Jan 18

At 9.30am-10.30am

Floor: Wood / Concrete / other \_\_\_\_\_

S/edge: Wood/Concrete/No pin/existing (if existing, allow \_\_\_ sticks to supplement where necessary)

Sticking Req'd: Yes/No Type: Fastset/Other DURAFIT JES

Underlay: Re-use Existing / New required

Type: 42oz Felt / Fomalux / PU Foam / Luxury PU Foam / LowTog / Durafit

Doorbars: ~~Alloy~~ / Satin Ali / Polished Ali / Anod / Solid Brass / Chrome / Nisheen Seam/Wood/T/Holds: colour NONE REQUIRED

Door Clearance: OK / Low (advise on quote)

Uplift: No / Yes (if "Yes" - what type?) \_\_\_\_\_

Furniture: No/Yes (if YES, please specify the following) - 1 man / 2 men (Fitter to get paid) £\_\_\_\_\_ total/per room

Parking Cost: Free / £\_\_\_\_\_ per hour

Parking Restrictions: (type) / £ IN CEMENTS

Congestion Zone: No / Yes

Access: Easy / Hard / 2 men req'd / 1ST floor? UP METAL STAIRCASE

Runners: ~~Whipping~~ / Binding (if binding, specify type)

Tape size: ~~1 1/2"~~ / 2" / 3" / 5"

Style: ~~Top~~ taping / Side binding

Stairrods: Type \_\_\_\_\_ Nr \_\_\_\_\_ Size \_\_\_\_\_

Must Read: ask for Greg