

F30830

3rd call of 5

Notes for Measure

Estimator: Chris

Lishma# Badiana, Flat 12

Date of Measure: Tue, 3 Feb 26

At: 12-1pm

Site Address:

Flat 12  
Mornington Ave

LONDON

W14 8UW

CONTACT: As customer details

Mobile	Home	Office
07807-077989		

Customer Address:

Flat 12 (28-30 Mornington Avenue)

Mornington Ave

LONDON

W14 8UW

Email:

lishma.badiana@gmail.com

Areas to be done and Description of Measure

bedroom

See app

Instructions and Estimators comments

customer will come in Monday to check on carpets

23-50  
-180

Must Read!

Not entered

Office Ref: F30830

Lishma# Badiana, Flat 12

Date of Measure Tue, 3 Feb 26

At 12-1pm

**Floor:** Wood / Concrete / other \_\_\_\_\_

**S/edge:** Wood/Concrete/No pin/existing (if existing, allow \_\_\_ sticks to supplement where necessary)

**Sticking Req'd:** Yes/No Type: Fastset/Other

**Underlay:** Re-use Existing / New required

**Type:** 42oz Felt / Fomalux / PU Foam / ~~Luxury PU Foam~~ / LowTog / Durafit

**Doorbars:** Alloy / Satin Ali / Polished Ali / Anod / Solid Brass / Chrome / Nisheen  
Seam/Wood/T/Holds: colour \_\_\_\_\_

**Door Clearance:** OK / Low (advise on quote)

**Uplift:** No / Yes (if "Yes" - what type?) \_\_\_\_\_

**Furniture:** No/Yes (if YES, please specify the following) - 1 man / 2 men (Fitter to get paid) £ \_\_\_\_\_ total/per room

**Parking Cost:** Free / £ 7 per hour

**Parking Restrictions:** (type) / £ \_\_\_\_\_

**Congestion Zone:** No / Yes

**Access:** Easy / Hard / 2 men req'd / 2nd floor?

**Runners:** Whipping / Binding (if binding, specify type)

**Tape size:** 1½" / 2" / 3" / 5"

**Style:** Top taping / Side binding

**Stairrods:** Type \_\_\_\_\_ Nr \_\_\_\_\_ Size \_\_\_\_\_

ULLSWATER 51/49.  
1152

Carpenter

Must Read: Not entered

mrcarpet  
DESIGNS FOR FLOORS  
Lishma  
Name: Badiana  
Address:  
Tel: **F30830**

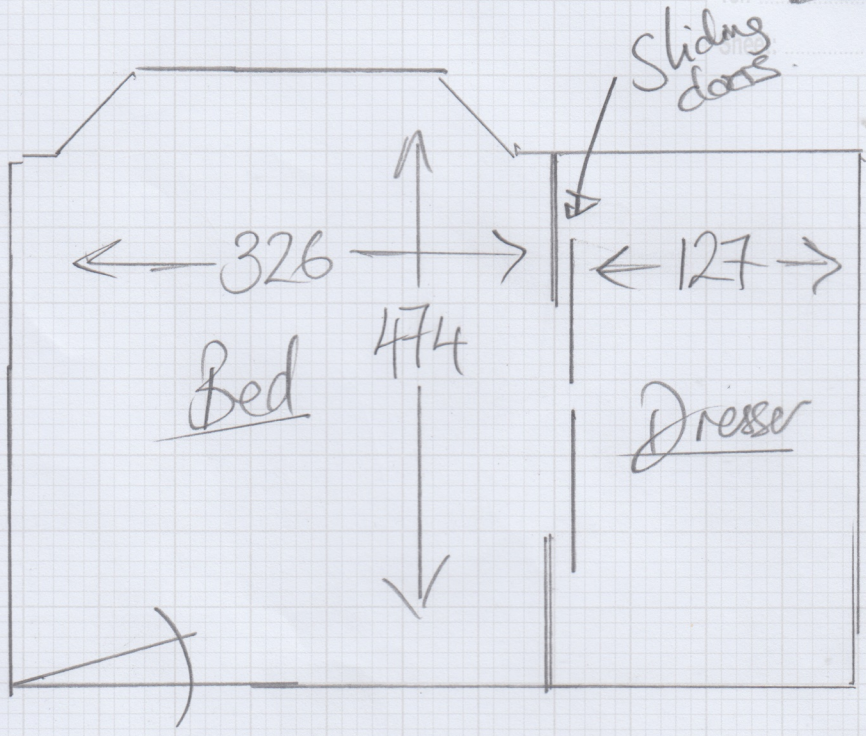

4.75 x 5.00