

**F30834**

4th call of 4

**Notes for Measure**

Estimator: Chris

Mrs Nicky Ellis, 55 Burnfoot Avenue

Date of Measure: Thu, 5 Feb 26

At: 2.00pm - 3.00pm

Site Address:

55 Burnfoot Avenue

Customer Address:

55 Burnfoot Avenue

LONDON

SW6 5EB

LONDON

SW6 5EB

CONTACT:

As customer details

Mobile  
07714-204659

Home  
N/P

Office  
N/P

Email:

snellis@btopenworld.com

**Areas to be done and Description of Measure**

Measure basement utility area

*Scanned d/f/02*

**Instructions and Estimators comments**

Secura Polished Concrete 2118 (lay ove ex sub-floor)

**Must Read!**

Not entered

Mrs Nicky Ellis, 55 Burnfoot Avenue

Date of Measure Thu, 5 Feb 26

At 2.00pm - 3.00pm

Floor: Wood / Concrete / other \_\_\_\_\_

S/edge: Wood/Concrete/No pin/existing (if existing, allow \_\_\_ sticks to supplement where necessary)

Sticking Req'd: Yes/No Type: Fastset/Other Vinyl Spray

Underlay: Re-use Existing / New required

Type: 42oz Felt / Fomalux / PU Foam / Luxury PU Foam / LowTog / Durafit

Doorbars: Alloy / Satin Ali / Polished Ali / Anod / Solid Brass / Chrome / Nisheen Seam/Wood/T/Holds: colour \_\_\_\_\_

Door Clearance: OK / Low (advise on quote)

Uplift: No / Yes (if "Yes" - what type?) \_\_\_\_\_

Furniture: No/Yes (if YES, please specify the following) - 1 man / 2 men (Fitter to get paid) £ \_\_\_\_\_ total/per room 2 x ABPS

Parking Cost: Free / £ 7 per hour

Parking Restrictions: (type) / £ \_\_\_\_\_

Congestion Zone: No / Yes

Access: Easy / Hard / 2 men req'd / \_\_\_\_\_ floor?

Runners: Whipping / Binding (if binding, specify type)

Tape size: 1 1/2" / 2" / 3" / 5"

Style: Top taping / Side binding

Must Read: Not entered

No: \_\_\_\_\_  
Name: \_\_\_\_\_  
Address: \_\_\_\_\_  
Tel: \_\_\_\_\_  
Sheet: \_\_\_\_\_ of: \_\_\_\_\_

Ellis  
F30834

Marble Care  
Needs care  
for separate  
pieces to this  
Tidd cust  
Pattern of drain  
will come through  
Mastic up the sides.

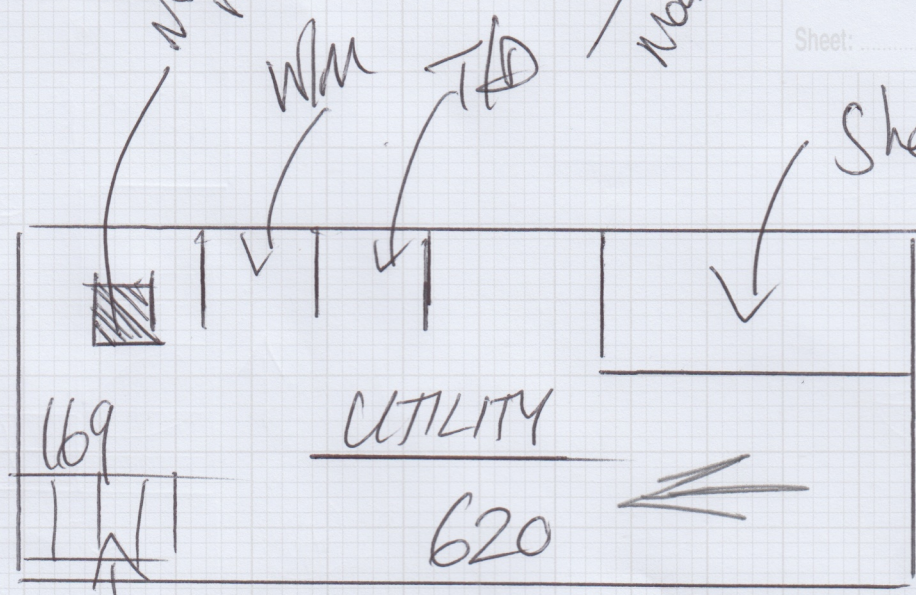

Shelving.  
Cust said  
go around  
it.

Over Plan  
Stairs.  
Fit around

More of fit  
under Appliances  
will come out  
ACM gap unit

635 x 2.00

- ↳ Fitting
- ↳ Mastic.
- ↳ Adhesive
- ↳ Move furniture