

Job No: F30835

Name: BRAMANI

Address:

Tel:

Sheet: of:

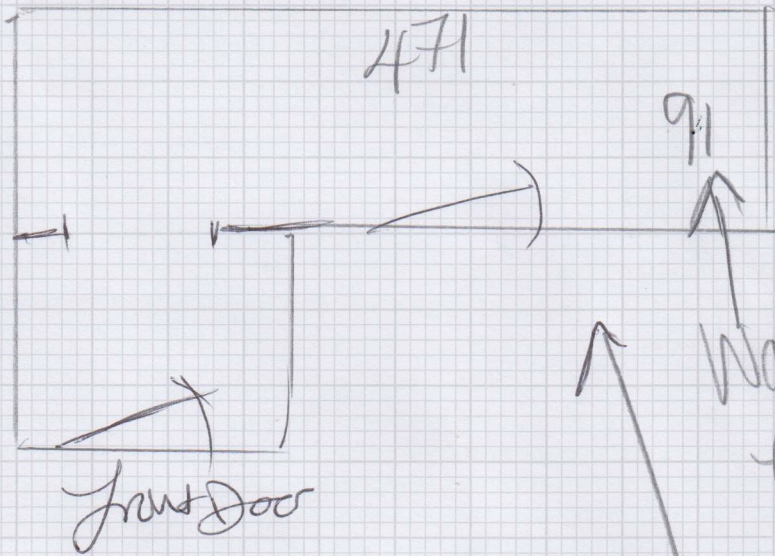

Door needs cutting

F30835

2nd call of 4

Notes for Measure

Estimator: Chris

Annalisa Bramani, Flat 10 21-23 Cramley Gardens

Date of Measure: Tue, 10 Feb 26

At: 11-12pm

Site Address:

Flat 10 21-23 Cramley Gardens

Customer Address:

Flat 10 21-23 Cramley Gardens

LONDON

SW7 3BD

LONDON

SW7 3BD

CONTACT:

As customer details

Mobile	Home	Office
0		02073811989

Email:

a.bramani@casa-londra.com

Areas to be done and Description of Measure

Rug for hall way

Instructions and Estimators comments

alternative or unnatural flooring with tape and acoustice underlay

Must Read!

Not entered

Office Ref: F30835

Annalisa Bramani, Flat 10 21-23 Cramley Gardens

Date of Measure Tue, 10 Feb 26

At 11-12pm

Floor: Wood / Concrete / other _____

S/edge: Wood/Concrete/No pin/existing (if existing, allow __ sticks to supplement where necessary)

Sticking Req'd: Yes/No Type: Fastset/Other

Underlay: Re-use Existing / New required

Type: 42oz Felt / Fomalux / PU Foam / Luxury PU Foam / LowTog / Durafit

Doorbars: Alloy / Satin Ali / Polished Ali / Anod / Solid Brass / Chrome / Nisheen
Seam/Wood/T/Holds: colour _____

Door Clearance: OK / Low (advise on quote)

Uplift: No / Yes (if "Yes" - what type?) _____

Furniture: No/Yes (if YES, please specify the following) - 1 man / 2 men (Fitter to get paid) £_____ total/per room

Parking Cost: Free / £_____ per hour

Parking Restrictions: (type) / £_____

Congestion Zone: No / Yes

Access: Easy / Hard / 2 men req'd / _____ floor?

Runners: Whipping / Binding (if binding, specify type)

Tape size: 1½" / 2" / 3" / 5"

Style: Top taping / Side binding

Stairrods: Type _____ Nr _____ Size _____

Must Read: Not entered