

Job No: **F30838**
 Name: **CHURCH OF**
 Address: **ST THOMAS**
OF CANTONBURY
 Tel:
 Sheet: of:

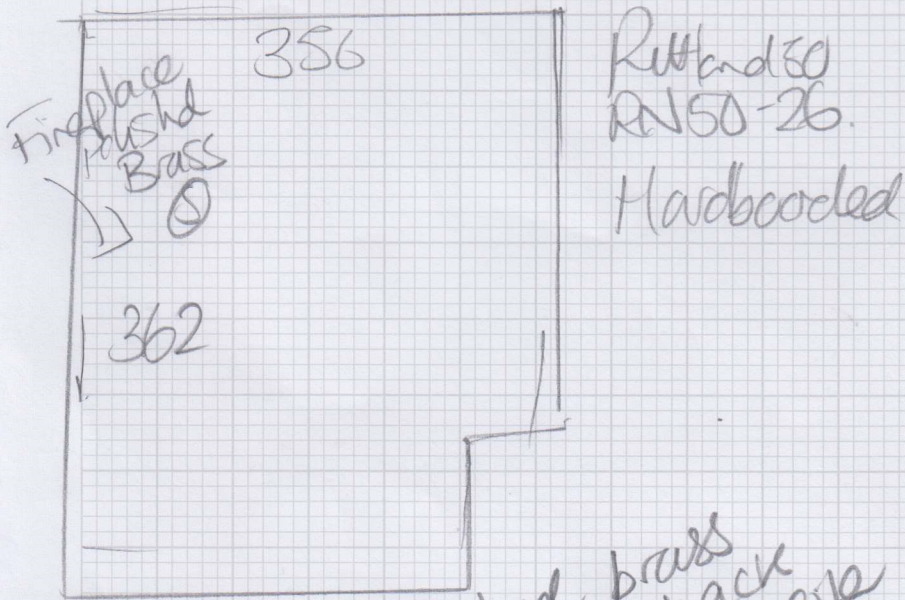

Currently a polished brass
 Dashed - can we cut back
 & join. carpet runs opposite
 direction.

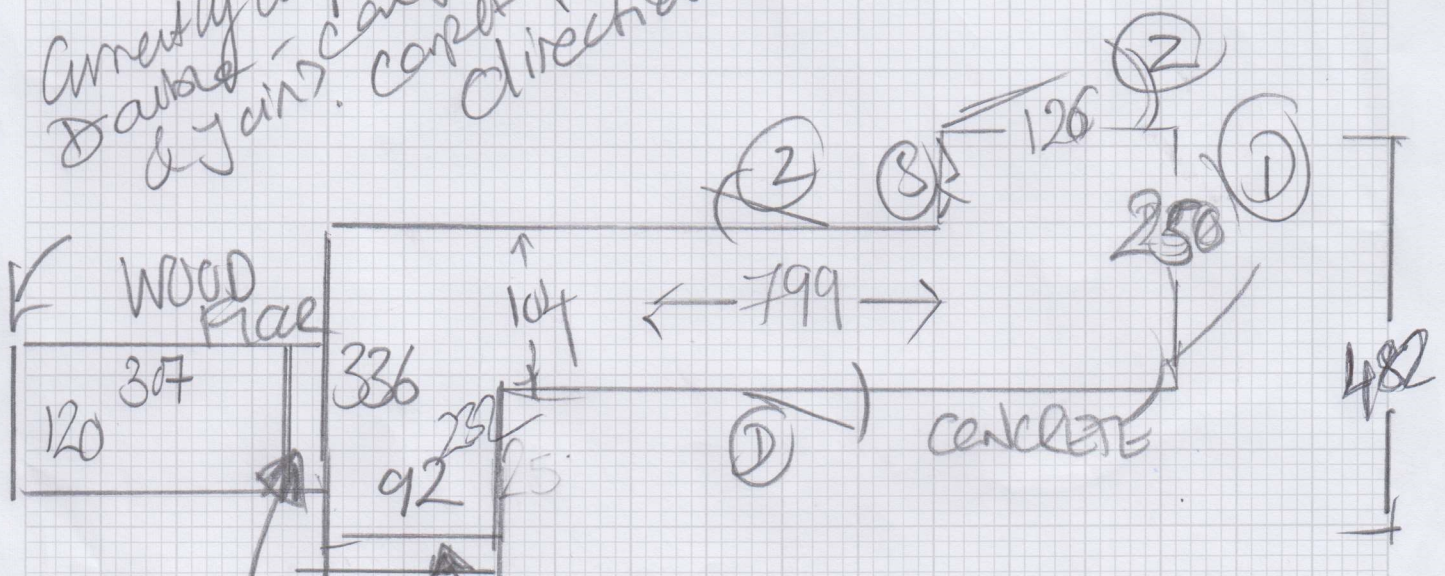

2x Steps 58 x 95 each

F30838**3rd call of 4****Notes for Measure****Estimator: Chris****Church Of St Thomas Of Canterbury, 60 Rylston Road****Date of Measure: Tue, 10 Feb 26****At: 12.00pm - 1.00pm****Site Address:****60 Rylston Road****Customer Address:***60 Rylston Road***LONDON****SW6 7HW***LONDON**SW6 7HW***CONTACT:****As customer details**

Mobile

Home

Office

07766-731966

N/P

020-7385-4040

Email:

fulham@rcdow.org.uk

Areas to be done and Description of Measure

Measure extended landing see F30374 + further room (add 3mm Hardboard to this area)

Instructions and Estimators comments

Landing Highfields Wine 289 DISC / Room Rutland 50oz CTS

Must Read!**FATHER JAMES - TAKE RED JHS CONTRACT TO MATCH****Office Ref: F30838**

Church Of St Thomas Of Canterbury, 60 Rylston Road

Date of Measure Tue, 10 Feb 26

At 12.00pm - 1.00pm

Floor: Wood / Concrete / other _____
S/edge: Wood/Concrete/No pin/existing (if existing, allow __ sticks to supplement where necessary)
Sticking Req'd: Yes/No Type: Fastset/Other *Hardboard to Bedroom*
Underlay: Re-use Existing / New required
Type: 42oz Felt / Fomalux / PU Foam / Luxury PU Foam / LowTog / Durafit
Doorbars: Alloy / Satin Ali / Polished Ali / Anod / Solid Brass / Chrome / Nisheen Seam/Wood/T/Holds: colour _____
Door Clearance: OK / Low (advise on quote)
Uplift: No / Yes (if "Yes" - what type?) _____
Furniture: No/Yes (if YES, please specify the following) - 1 man / 2 men (Fitter to get paid) £ _____ total/per room
Parking Cost: Free / £ _____ per hour
Parking Restrictions: (type) / £ _____
Congestion Zone: No / Yes
Access: Easy / Hard / 2 men req'd / _____ floor?
Runners: Whipping / Binding (if binding, specify type)
Tape size: 1½" / 2" / 3" / 5"
Style: Top taping / Side binding
Stairrods: Type _____ Nr _____ Size _____

Must Read: FATHER JAMES - TAKE RED JHS CONTRACT TO MATCH