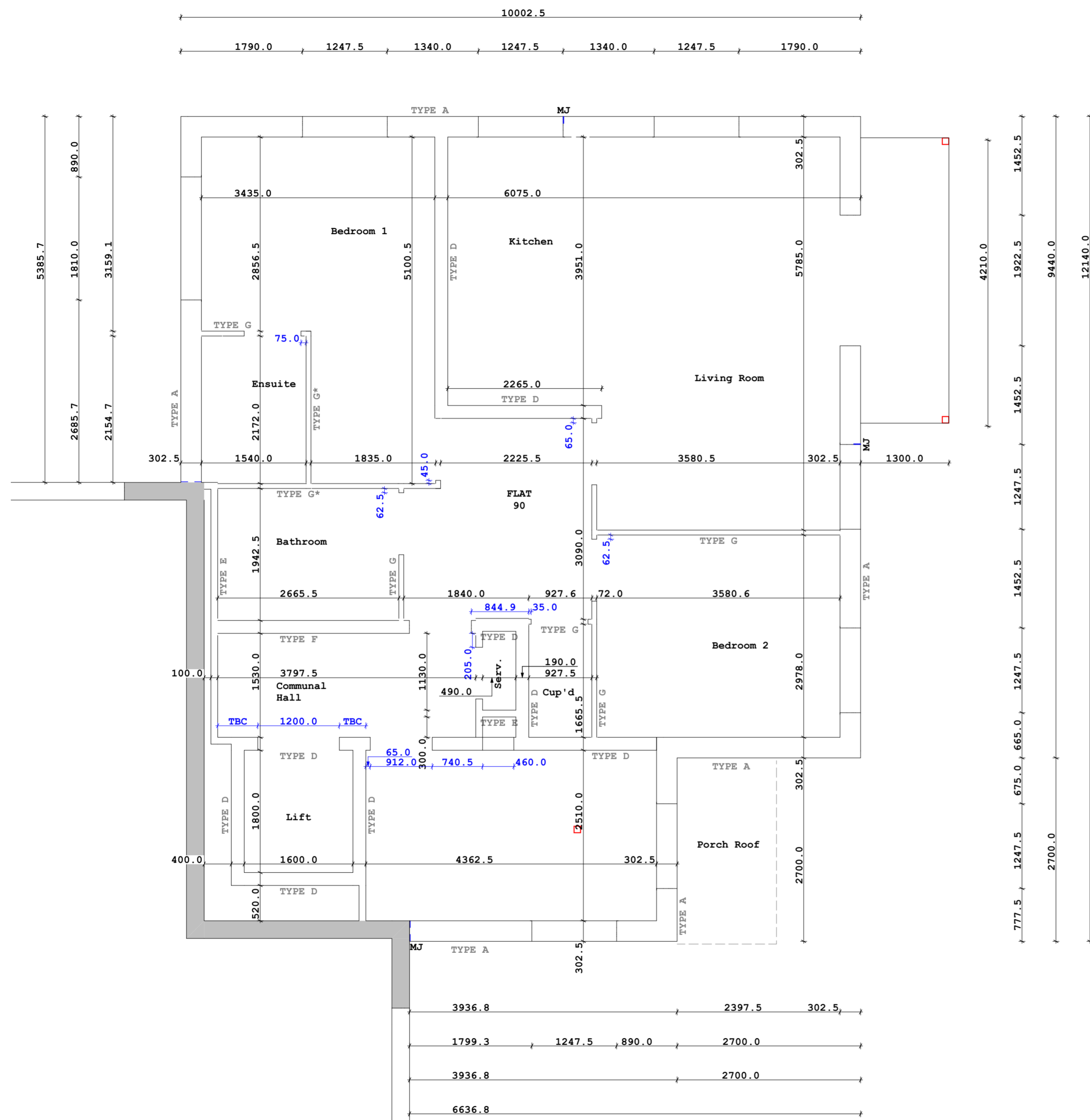

Figure dimension to be taken in preference to scale
 Dimensions to be checked on site prior to commencement of work.
 If any doubts on interpretation of plans PLEASE CONTACT
 GEOFFREY SLOAN ASSOCIATES IMMEDIATELY.
 All works to comply with current Building Regulations



Wall Types

TYPE A - 342.5mm Cavity Wall Brick Outer Skin, Block Inner Skin
 102.5mm Brick outer skin
 10mm Clear cavity
 90mm Kingspan K106 cavity board with retention disk fixings and taped at all joints with Wraptite self-adhesive breathable tape
 100mm Tarmac Topcrete Solid 10.4N/mm² block inner skin

TYPE B - External Skealing Wall
 9.5mm OSB sheathing
 140x50mm Timber stud wall formed with
 140x50mm Timber studs @ 400 C/C filled with
 120mm Kingspan Kooltherm K12 Insulation

TYPE C - 244mm Tile Hanging Wall
 Plain clay hanging on
 38x38mm Battens on
 38x38mm Counter battens on
 Klobber Permo Frame Vapour Control Layer (VCL)
 50mm Kingspan Kooltherm K112 framing board
 Klobber Permo Frame Vapour Control Layer (VCL)
 18mm Grade 'H' WBP hardboard plywood
 100x50mm Stud Wall with
 50mm Kingspan Kooltherm K112 framing board to external face of studs with
 12.5mm Gyproc Wallboard Duplex

TYPE D - 190mm Concrete Block Wall
 190mm 10.4N/mm² Tarmac Topcrete RPW

TYPE E - 100mm Concrete Block Wall
 100mm 7.3N/mm² Tarmac Toplite '7' Block

TYPE F - 250mm Acoustic Metal Stud Partition
 2 No 70x50mm Metal stud walls formed using
 70x50mm Gypframe '70 AS 50' AcouStuds @ 400C/C
 70x50mm Gypframe '72 FEC 50' Top Plate
 70x50mm Gypframe '72 FEC 50' Bottom Plate
 70x50mm Gypframe '70 AS 50' AcouStuds noggins @ 1200C/C staggered between stud
 60mm Rockwool RWA45 mineral wool insulation slabs between studs
 50mm Clear cavity between studs walls
 2x15mm Gyproc Soundbloc board to both sides

TYPE G - 72mm Metal Stud
 70x50mm Gypframe '70 AS 50' AcouStuds @ 400C/C
 70x50mm Gypframe '72 FEC 50' Top Plate
 70x50mm Gypframe '72 FEC 50' Bottom Plate
 70x50mm Gypframe '70 AS 50' AcouStuds noggins @ 1200C/C staggered between stud
 60mm Rockwool RWA45 full fill between studs
 12.5mm Gyproc Soundbloc board to both sides

H* substitute 12.5mm Soundbloc with 12.5mm Grade H WBP Hardwood plywood and 12.5mm Glasroc H Tilebacker in sanitary and kitchen walls.

TYPE H - Dormer Cheek Walls
 Code 5 Lead Panelling on
 BLM British Lead Underlay on
 BLM British Lead Grade A1F Building Paper on
 12.5mm Grade 'H' WBP hardwood plywood on
 25x38mm S/W battens forming ventilation void on
 Klobber Permo Frame Vapour Control Layer (VCL) on
 12.5mm Grade 'H' WBP hardwood plywood on
 75x50mm C24 stud wall, studs @ 400 C/C with
 50mm Kingspan Kooltherm K112 rigid insulation to inside face of studs min
 25mm air space to outside face of insulation with
 62.5mm Kingspan Kooltherm K118 Insulated plasterboard fixed to stud wall with
 5mm Thistle Multifinish

Below pitched roof finish, substitute 75x50mm studs with 140x50mm stud wall with 120mm Kingspan Kooltherm K112 between.

TYPE I - 215mm Brick Wall

FIRST FLOOR SETTING OUT PLAN

CONSTRUCTION DRAWING

Revisions	H 24-03-2021 - REVISED TENDER ISSUE I 18-05-2021 - CONSTRUCTION ISSUE	Scale	1:50 @ A2	GEOFFREY SLOAN ASSOCIATES BUILDING SURVEYORS & BUILDING ENGINEERS UNIT 7, OCKLEY COURT, COLES LANE, OCKLEY, SURREY, RH5 5LS	TEL	01306 711058	
Job	CC319 Construction 4no Flats - Charter Court, Linden Grove, New Malden, Surrey, KT3 3BL	Drawn by	CG		FAX	01306 713417	
		Checked by	AMS	Client	Charter Court (New Malden) Ltd.	Drawing Title	First Floor Setting Out Plan
				Drawing No	CC319/223/I	DATE	18-06-18