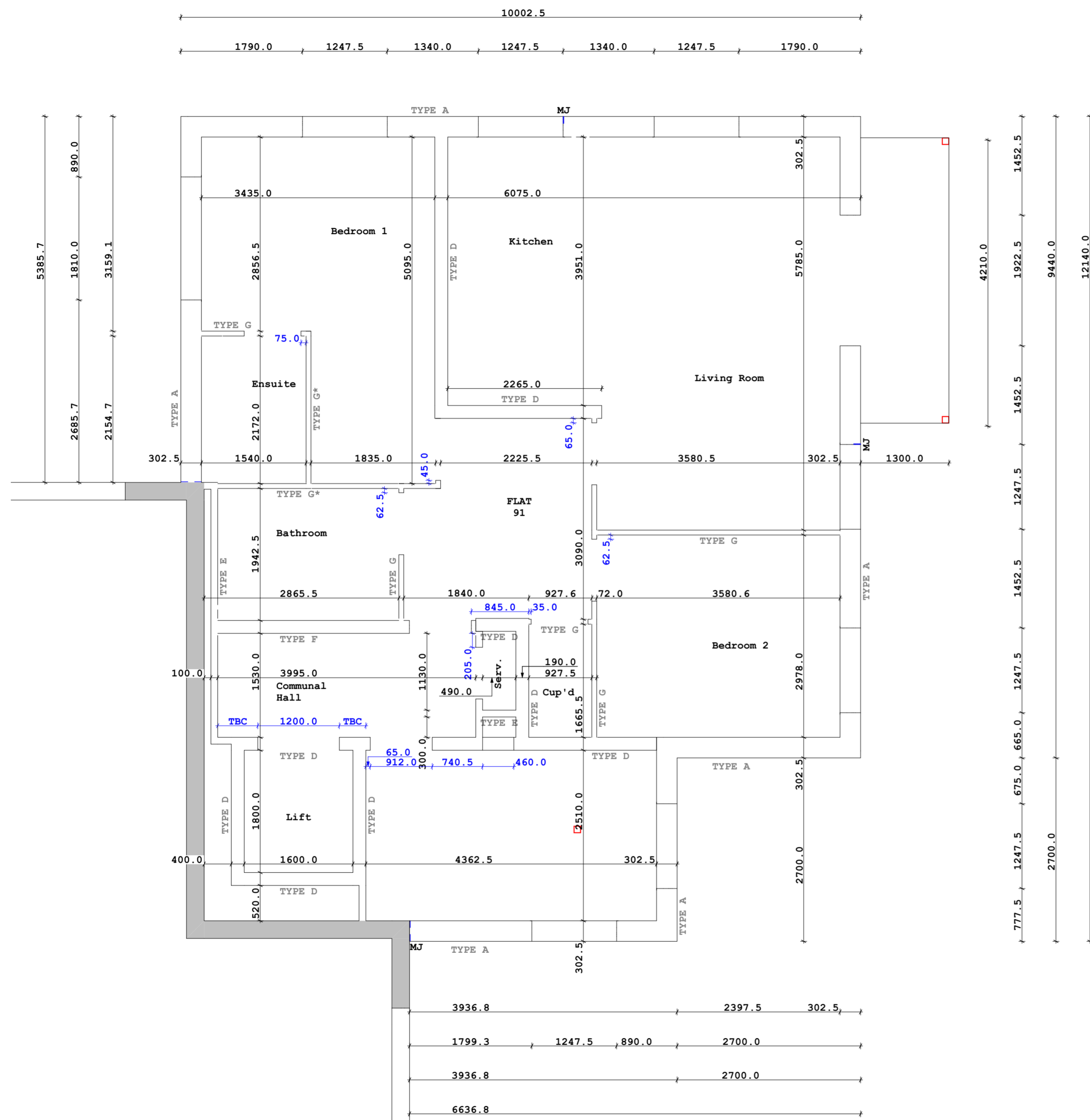

Figure dimension to be taken in preference to scale  
 Dimensions to be checked on site prior to commencement of work.  
 If any doubts on interpretation of plans PLEASE CONTACT  
 GEOFFREY SLOAN ASSOCIATES IMMEDIATELY.  
 All works to comply with current Building Regulations



**Wall Types**

**TYPE A - 342.5mm Cavity Wall Brick Outer Skin, Block Inner Skin**  
 102.5mm Brick outer skin  
 10mm Clear cavity  
 90mm Kingspan K106 cavity board with retention disk fixings and taped at all joints with Wraptite self-adhesive breathable tape  
 100mm Tarmac Topcrete Solid 10.4N/mm<sup>2</sup> block inner skin

**TYPE B - External Skealing Wall**  
 9.5mm OSB sheathing  
 140x50mm Timber stud wall formed with  
 140x50mm Timber studs @ 400 C/C filled with  
 120mm Kingspan Kooltherm K12 Insulation

**TYPE C - 244mm Tile Hanging Wall**  
 Plain clay hanging on  
 38x38mm Battens on  
 38x38mm Counter battens on  
 Klobber Permo Frame Vapour Control Layer (VCL)  
 50mm Kingspan Kooltherm K112 framing board  
 Klobber Permo Frame Vapour Control Layer (VCL)  
 18mm Grade 'H' WBP hardboard plywood  
 100x50mm Stud Wall with  
 50mm Kingspan Kooltherm K112 framing board to external face of studs with  
 12.5mm Gyproc Wallboard Duplex

**TYPE D - 190mm Concrete Block Wall**  
 190mm 10.4N/mm<sup>2</sup> Tarmac Topcrete RPW

**TYPE E - 100mm Concrete Block Wall**  
 100mm 7.3N/mm<sup>2</sup> Tarmac Toplite '7' Block

**TYPE F - 250mm Acoustic Metal Stud Partition**  
 2 No 70x50mm Metal stud walls formed using  
 70x50mm Gypframe '70 AS 50' AcouStuds @ 400C/C  
 70x50mm Gypframe '72 FEC 50' Top Plate  
 70x50mm Gypframe '72 FEC 50' Bottom Plate  
 70x50mm Gypframe '70 AS 50' AcouStuds noggins @ 1200C/C staggered between stud  
 60mm Rockwool RWA45 mineral wool insulation slabs between studs  
 50mm Clear cavity between studs walls  
 2x15mm Gyproc Soundbloc board to both sides

**TYPE G - 72mm Metal Stud**  
 70x50mm Gypframe '70 AS 50' AcouStuds @ 400C/C  
 70x50mm Gypframe '72 FEC 50' Top Plate  
 70x50mm Gypframe '72 FEC 50' Bottom Plate  
 70x50mm Gypframe '70 AS 50' AcouStuds noggins @ 1200C/C staggered between stud  
 60mm Rockwool RWA45 full fill between studs  
 12.5mm Gyproc Soundbloc board to both sides

H\* substitute 12.5mm Soundbloc with 12.5mm Grade H WBP Hardwood plywood and 12.5mm Glasroc H Tilebacker in sanitary and kitchen walls.

**TYPE H - Dormer Cheek Walls**  
 Code 5 Lead Panelling on  
 BLM British Lead Underlay on  
 BLM British Lead Grade A1F Building Paper on  
 12.5mm Grade 'H' WBP hardwood plywood on  
 25x38mm S/W battens forming ventilation void on  
 Klobber Permo Frame Vapour Control Layer (VCL) on  
 12.5mm Grade 'H' WBP hardwood plywood on  
 75x50mm C24 stud wall, studs @ 400 C/C with  
 50mm Kingspan Kooltherm K112 rigid insulation to inside face of studs min  
 25mm air space to outside face of insulation with  
 62.5mm Kingspan Kooltherm K118 Insulated plasterboard fixed to stud wall with  
 5mm Thistle Multifinish

Below pitched roof finish, substitute 75x50mm studs with 140x50mm stud wall with 120mm Kingspan Kooltherm K112 between.

**TYPE I - 215mm Brick Wall**

SECOND FLOOR SETTING OUT PLAN

**CONSTRUCTION DRAWING**

Revisions H 24-03-2021 - REVISED TENDER ISSUE I 18-05-2021 - CONSTRUCTION ISSUE	Scale	1:50 @ A2	GEOFFREY SLOAN ASSOCIATES BUILDING SURVEYORS & BUILDING ENGINEERS UNIT 7, OCKLEY COURT, COLES LANE, OCKLEY, SURREY, RH5 5LS	TEL	01306 711058
	Drawn by	CG		FAX	01306 713417
Job <b>CC319</b> Construction 4no Flats - Charter Court, Linden Grove, New Malden, Surrey, KT3 3BL	Checked by	AMS	Drawing Title Second Floor Setting Out Plan	Drawing No	CC319/224/I
	Client	Charter Court (New Malden) Ltd.		DATE	18-06-18