



Job No: S36025

Name: GORDON-SMITH

Address:

Tel:

Sheet: of:

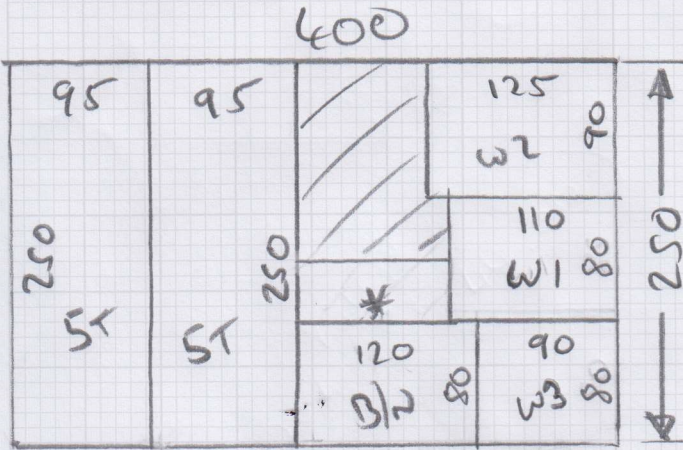

250 x 400

* Cut Piece for Customer
To Place ON TOP OF
BOTTOM STEP - 21x70

Job No: 536025

Name: GORDON-SMITH

Address:

Tel:

Sheet: of:

Top
LANDING
+
Riser
ARE
WOOD

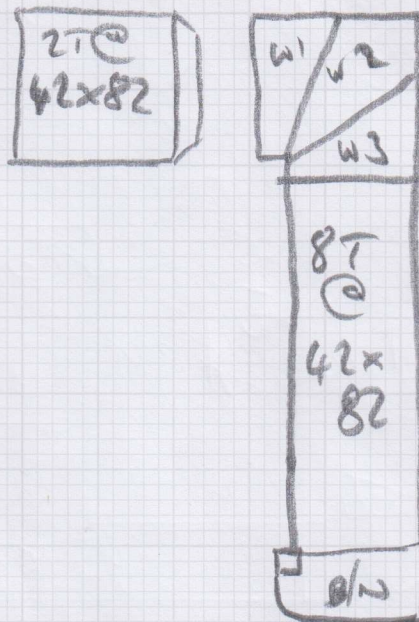

$$w1 = 66 \times 95$$

$$w2 = 80 \times 112$$

$$w3 = 68 \times 78$$

$$B/W = 42 \times 101$$

S36025

2nd call of 3

Notes for Measure

Estimator: Jack

Mrs Eva Gordon-Smith, 16 Eastbourne Gardens

Date of Measure: Wed, 28 Jan 26

At: 11-12

Site Address:

16 Eastbourne Gardens

Customer Address:

16 Eastbourne Gardens

LONDON

SW14 7NH

LONDON

SW14 7NH

CONTACT:

As customer details

Mobile
07949-285233

Home
020-8878-5579

Office
N/P

Email:
egs@gordonsmithconsulting.com

Areas to be done and Description of Measure

AOS Cosmoplitan TAKE Hay & Cornslk £37.90 sqm HD PU Flight of strs Full width

5002

5002

UNDER 2
+ £30

Move 10 PM

Instructions and Estimators comments

Wants to order soon , FIT APRIL

35.75 - 32.18

Do 4002 1806

+

5002 2088

OPTIONS

~~4002~~ 41 - 35.90

* Allow EXTRA

PIECE WHIPPED

TO GO ON BOTTOM STEP - (21x70)

Must Read!

TAKE COSMOPLITAN Hay & Cornsilk

Office Ref: S36025

Mrs Eva Gordon-Smith, 16 Eastbourne Gardens

Date of Measure Wed, 28 Jan 26

At 11-12

Floor: Wood / Concrete / other _____

S/edge: Wood/Concrete/No pin/existing (if existing, allow ___ sticks to supplement where necessary)

Sticking Req'd: Yes/No Type: Fastset/Other

Underlay: Re-use Existing / New required

Type: 42oz Felt / Fomalux / HD PU Foam / Luxury PU Foam / LowTog / Durafit

Doorbars: Alloy / Satin Ali / Polished Ali / Anod / Solid Brass / Chrome / Nisheen
Seam/Wood/T/Holds: colour _____

Door Clearance: OK / Low (advise on quote)

Uplift: No / Yes (if "Yes" - what type?) COST + U/LAY

Furniture: No/Yes (if YES, please specify the following) - 1 man / 2 men (Fitter to get paid) £_____ total/per room

Parking Cost: Free / £_____ per hour

Parking Restrictions: (type) / £ DRIVEWAY

Congestion Zone: No / Yes

Access: Easy / Hard / 2 men req'd / _____ floor? GROUND 10/15

Runners: Whipping / Binding (if binding, specify type)

Tape size: 1½" / 2" / 3" / 5"

Style: Top taping / Side binding

Stairrods: Type _____ Nr _____ Size _____

FULL WIDTH

Must Read: TAKE COSMOPLITAN Hay & Cornsilk

Office Ref: S36025

Mr Carpet (London) Ltd