

Job No: S36090
 Name: TOWNSEND
 Address: _____
 Tel: _____
 Sheet: _____ of: _____

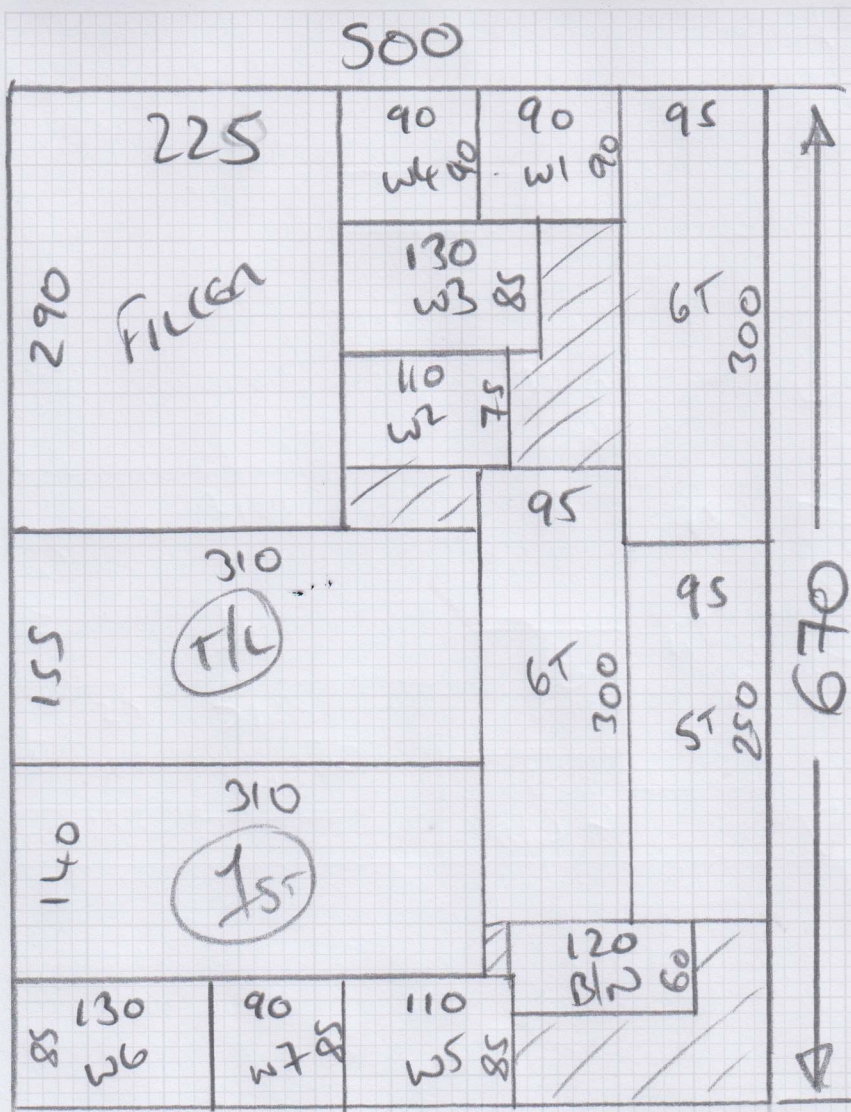

675 x 500
 670 x 500

Option 2

To include lower
 stairs & landing
 465 x 500 becomes
670 x 500

465 NEED TO
 BE GROSS OUT
 ON OTHER
 PLAN

Job No: 536090

Name: TOWNSEND

Address:

Tel:

Sheet: of:

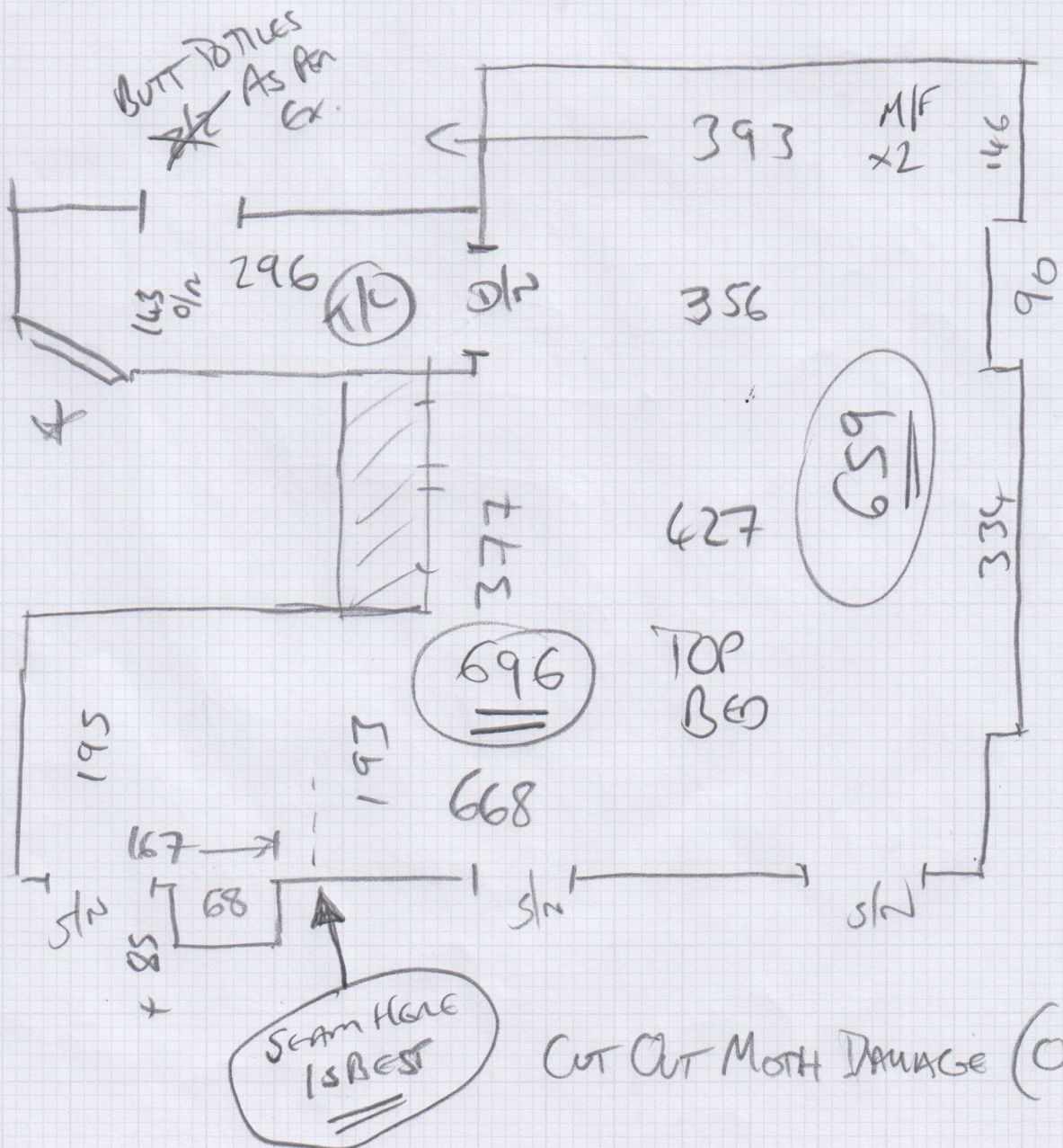
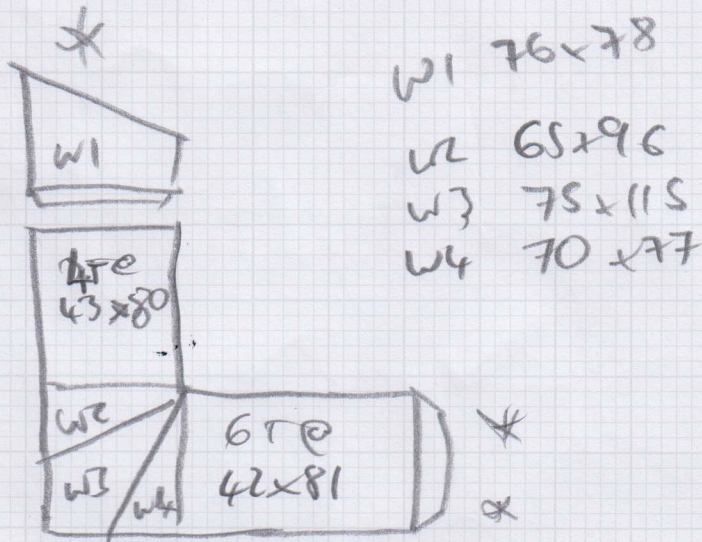

Job No: 536090

Name:

Address: JONSONS

Tel:

Sheet: of:

WS 65x95
WG 75x116
W7 73x77
B/W 42x101

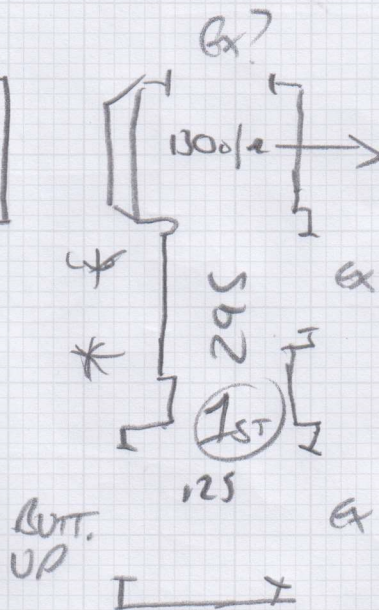

(Option for These Areas)

Mrs Camilla Townsend, 47 Clavering Avenue

Date of Measure: Wed, 4 Mar 26

At: 9-10am

Site Address:
47 Clavering Avenue
Barnes

Customer Address:
47 Clavering Avenue
Barnes
LONDON

SW13 8DX

LONDON SW13 8DX

CONTACT: As customer details

Mobile	Home	Office
07816-914559	N/P	N/P

Email:
cjohn20@gmail.com

Areas to be done and Description of Measure

AOS Loft Bed LOFT STRS OPT 1 Hampton OPT 2 Alhambra col ALH 12 Mix u/lays

26>22

93.50 > 79.48

Nude Casilaigne

+ May Add Bottom
Cassette & Straps ON
IF they have no buttons

SEE IF ANY
OTHER PANTS
WITH ALH-12
COLOUR
BUT CLOSER

NOPE!

Room = 33 Next.

Must Read!

Take Hampton Swatch & ALH 12

Office Ref: S36090

Mrs Camilla Townsend, 47 Clavering Avenue

Date of Measure Wed, 4 Mar 26

At 9-10am

Floor: Wood / Concrete / other _____

S/edge: Wood/Concrete/No pin/existing (if existing, allow ___ sticks to supplement where necessary)

Sticking Req'd: Yes/No Type: Fastset/Other

Underlay: Re-use Existing / New required

Type: 42oz Felt / Fomalux / PU Foam / Luxury PU Foam / LowTog / Durafit

Doorbars: Alloy / Satin Ali / Polished Ali / Anod / Solid Brass / Chrome / Nisheen Seam/Wood/T/Holds: colour _____ Brushed Chrome?

Door Clearance: OK / Low (advise on quote)

Uplift: No / Yes (if "Yes" - what type?) COT+U/LAY

Furniture: No/Yes (if YES, please specify the following) - 1 man / 2 men (Fitter to get paid) £ _____ total/per room

Parking Cost: Free / £ _____ per hour → Big Bus, Guest of Damians (X1)

Parking Restrictions: (type) / £ PERMITS ONLY

Congestion Zone: No / Yes

Access: Easy / Hard / 2 men req'd / _____ floor? 2nd - Big Piece

Runners: Whipping / Binding (if binding, specify type)

Tape size: 1 1/2" / 2" / 3" / 5" R/W

Style: Top taping / Side binding

Stairrods: Type _____ Nr _____ Size _____

Must Read: Take Hampton Swatch & ALH 12