

Job No: 536098
 Name: CARTER
 Address: _____
 Tel: _____
 Sheet: _____ of: _____

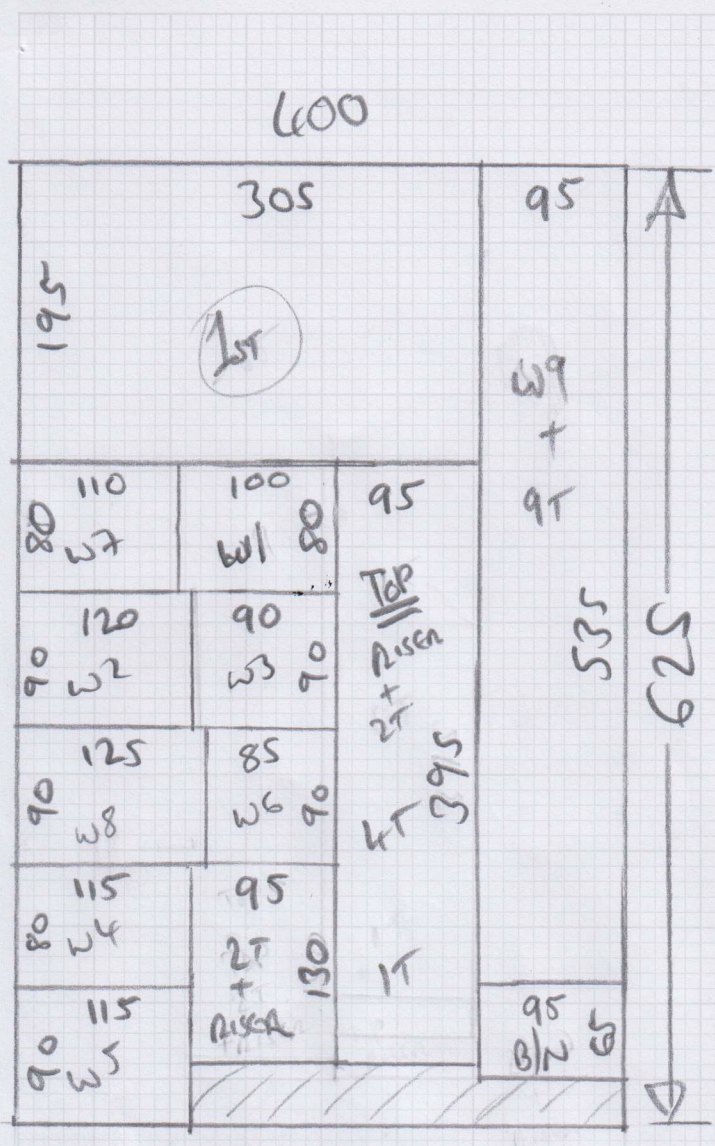

Job No: 536098

Name: CANTEEN

Address:

Tel:

Sheet: of:

Area = 19 x 70

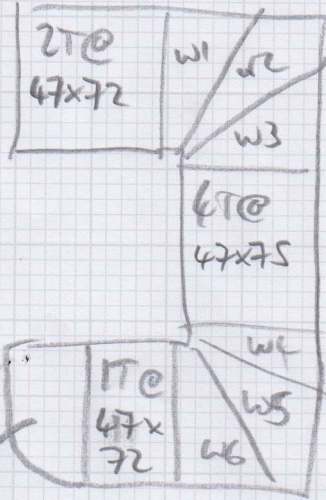

- | | | | |
|----|--------|----|--------|
| W1 | 69x87 | W4 | 70x91 |
| W2 | 77x104 | W5 | 77x106 |
| W3 | 76x75 | W6 | 76x72 |

B/N = 48 x 75

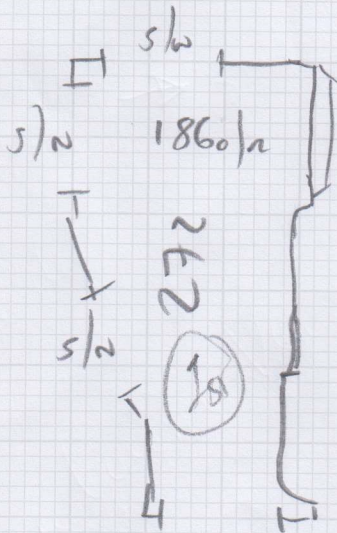

Area = 17 x 80

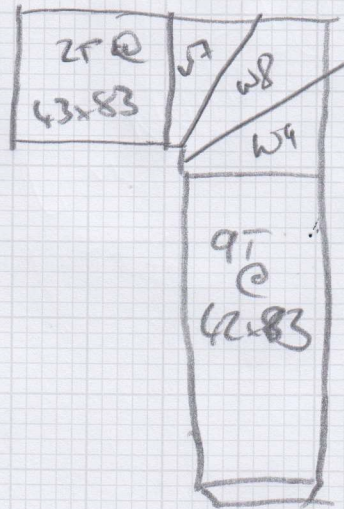

- | | |
|----|--------|
| W7 | 67x94 |
| W8 | 78x117 |
| W9 | 75x81 |

But to
tiles
20mm → 25mm

NOT BOTTOM
1/4 LANDING
on B/N

S36098

1st call of 4

Notes for Measure

Estimator: Jack

Mrs A Carter, 22 Gilpin Avenue

Date of Measure: Tue, 3 Mar 26

At: 9-10am

Site Address:

22 Gilpin Avenue
East Sheen

LONDON

SW14 8QY

Customer Address:

22 Gilpin Avenue
East Sheen
LONDON

SW14 8QY

CONTACT: As customer details

Mobile	Home	Office
07852-352149		

Email: ahening34@gmail.com

Areas to be done and Description of Measure

AOS X30431 FYI 1st Strs /land only MAKE OVER TO SELL TAKE BROOKLYN swatch poss full width now discusson site (prev Boston)

06 fms

f
DPTION
Run for
FLIGHT
AS WHIPPED
RUNNER

Instructions and Estimators comments

HD PU note 6yrs old underlay / REQ ASAP

Must Read!

TAKE BROOKLYN

Office Ref: S36098

Mrs A Carter, 22 Gilpin Avenue

Date of Measure Tue, 3 Mar 26

At 9-10am

Floor: Wood Concrete / other Plasterboard

S/edge: Wood/Concrete/No pin/existing (if existing, allow ___ sticks to supplement where necessary) AN NEW REQ'D

Sticking Req'd: Yes/No Type: Fastset/Other

Underlay: Re-use Existing / New required

Type: 42oz Felt / Fomalux / PU Foam / Luxury PU Foam / LowTog / Durafit

Doorbars: Alloy / Satin Ali / Polished Ali / Anod / Solid Brass / Chrome / Nisheen Seam/Wood/T/Holds: colour _____

Door Clearance: OK / Low (advise on quote)

Uplift: No / Yes (if "Yes" - what type?) _____

Furniture: No/Yes (if YES, please specify the following) - 1 man / 2 men (Fitter to get paid) £_____ total/per room

Parking Cost: Free / £_____ per hour

Parking Restrictions: (type) / £ PERMITS 10-12

Congestion Zone: No / Yes

Access: Easy / Hard / 2 men req'd / _____ floor?

Runners: Whipping / Binding (if binding, specify type) FLOR

Tape size: 1 1/2" / 2" / 3" / 5"

Style: Top taping / Side binding

Stairrods: Type _____ Nr _____ Size _____

Must Read: TAKE BROOKLYN