

S36104

1st call of 2

Notes for Measure

Estimator: Chris

Ms Debbie Jones, 169 Queen's Gate

Date of Measure: Tue, 10 Mar 26

At: 10.00 / 11.00

Site Address:

169 Queen's Gate  
Flat 1a (basement)

LONDON SW7 5HE

CONTACT: As customer details

Mobile  
07778-147179

Home

Office  
N/P

Customer Address:

169 Queen's Gate  
Flat 1a (basement)

LONDON SW7 5HE

Email:  
dm\_jones@btinternet.com

Areas to be done and Description of Measure

(JD) THIS IS IN ADDITION TO S35576 (AWI) MEASURE BEDROOM 2 IN ALHAMBRA ## TAKE BOOK

Instructions and Estimators comments

CALL ON ARRIVAL AS DEBBIE HAS SORTED THE PARKING

Must Read!

Not entered

Office Ref: S36104

Ms Debbie Jones, 169 Queen's Gate

Date of Measure Tue, 10 Mar 26

At 10.00 / 11.00

**Floor:**  Wood /  Concrete / other \_\_\_\_\_

**S/edge:** Wood/Concrete/No pin/existing (if existing, allow 5 sticks to supplement where necessary)

**Sticking Req'd:** Yes/ No Type: Fastset/Other

**Underlay:** Re-use Existing /  New required (OR SAME AS PREVIOUS 2017)

**Type:** 42oz Felt / Fomalux / PU Foam /  Luxury PU Foam / LowTog / Durafit

**Doorbars:** Alloy / Satin Ali / Polished Ali / Anod / Solid Brass / Chrome / Nisheen Seam/Wood/T/Holds: colour existing we fitted

**Door Clearance:**  OK / Low (advise on quote)

**Uplift:**  No / Yes (if "Yes" - what type?) will be done by builder so take off old quote too

**Furniture:**  No/Yes (if YES, please specify the following) - 1 man / 2 men (Fitter to get paid) £ \_\_\_\_\_ total/per room

**Parking Cost:**  Free / £ \_\_\_\_\_ per hour Park on site - cust to sort.

**Parking Restrictions:** (type) / £ \_\_\_\_\_

**Congestion Zone:**  No / Yes Park round back,

**Access:** Easy / Hard / 2 men req'd /  Basement floor?

**Runners:** Whipping / Binding (if binding, specify type)

**Tape size:** 1½" / 2" / 3" / 5"

**Style:** Top taping / Side binding

Job No: \_\_\_\_\_  
Name: Jones  
Address: S36104  
Tel: \_\_\_\_\_  
Sheet: \_\_\_\_\_ of \_\_\_\_\_

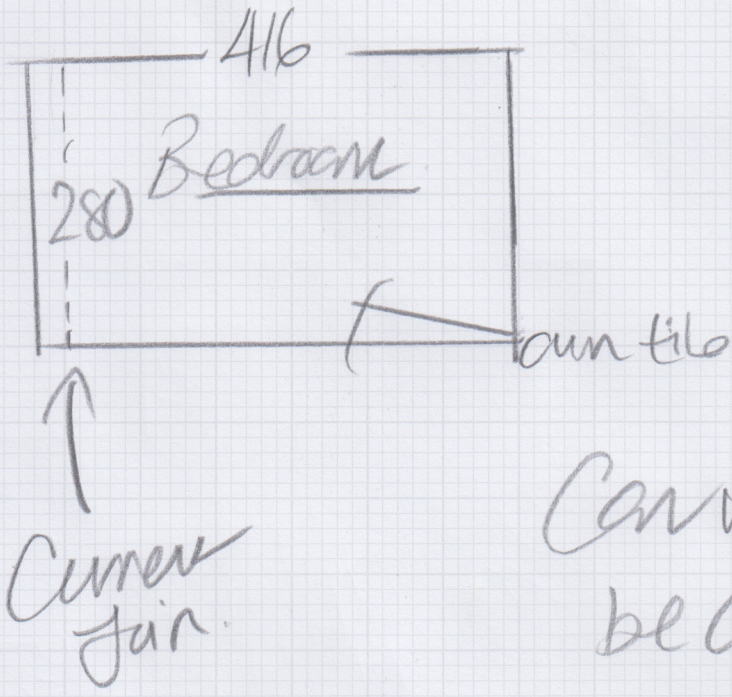

Can we do in 1 Piece?  
be cheaper!