

S36113

3rd call of 3

# Notes for Measure

Estimator: Chris

Mr & Mrs Richard Nickels, 42 Gerard Road

Date of Measure: Fri, 13 Mar 26

At: 12-1pm

**Site Address:**

42 Gerard Road  
Barnes

LONDON

SW13 9RG

**Customer Address:**

42 Gerard Road  
Barnes  
LONDON

SW13 9RG

**CONTACT:** As customer details

Mobile	Home	Office
07788-153294		

**Email:**  
nickelsrichard@gmail.com

**Areas to be done and Description of Measure**

AOS Main bed TAKE HAMPTON (fyi daughter had york discon FYI ) TAKE CRANBOURNE LUX PU CHECK DOOR CLEARANCE

**Instructions and Estimators comments**

Not entered

**Must Read!**

**TAKE CRANBOURNE & HAMPTON**

**Office Ref: S36113**

Mr & Mrs Richard Nickels, 42 Gerard Road

Date of Measure Fri, 13 Mar 26

At 12-1pm

Floor: Wood / Concrete / other \_\_\_\_\_

S/edge: Wood/Concrete/No pin/existing (if existing, allow \_\_\_ sticks to supplement where necessary)

Sticking Req'd: Yes/No Type: Fastset/Other

Underlay: Re-use Existing / New required

Type: 42oz Felt / Fomalux / PU Foam / Luxury PU Foam / LowTog / Durafit

Doorbars: Alloy / Satin Ali / Polished Ali / Anod / Solid Brass / Chrome / Nisheen Seam/Wood/T/Holds: colour \_\_\_\_\_

Door Clearance: OK / Low (advise on quote)

*- take off doors which don't 2022*

Uplift: No / Yes (if "Yes" - what type?) \_\_\_\_\_

Furniture: No/Yes (if YES, please specify the following) - 1 man / 2 men (Fitter to get paid) £ \_\_\_\_\_ total/per room

*1X empty unit only within 6 weeks.*

Parking Cost: Free / £ \_\_\_\_\_ per hour

Parking Restrictions: (type) / £ \_\_\_\_\_

*Permit as has*

Congestion Zone: No / Yes

*Large apt up 2 flights*

Access: Easy / Hard / 2 men req'd / \_\_\_\_\_ floor?

Runners: Whipping / Binding (if binding, specify type)

Tape size: 1 1/2" / 2" / 3" / 5"

Style: Top taping / Side binding

Stairrods: Type \_\_\_\_\_ Nr \_\_\_\_\_ Size \_\_\_\_\_

**Must Read: TAKE CRANBOURNE & ASHTON**

Job No:  
Name: Nickels  
Address: S36113  
Tel:  
Sheet: of:

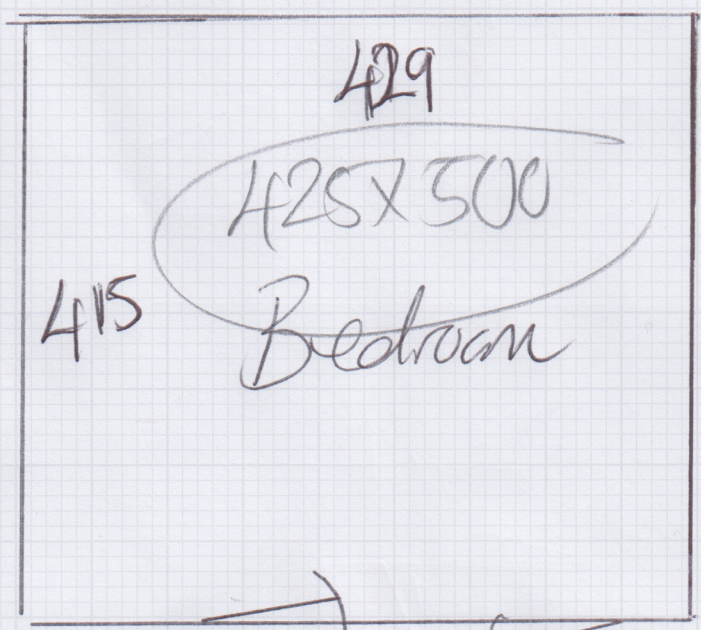

429

425 x 500

Bedroom

415

TO CAR  
EXIST

T/E  
Area