

S36132

1st call of 2

Notes for Measure

Estimator: Chris

Kate Maier, 34 Schubert Road

Date of Measure: Mon, 23 Mar 26

At: 1-2pm

Site Address:

34 Schubert Road

Customer Address:

34 Schubert Road

LONDON

SW15 2QS

LONDON

SW15 2QS

CONTACT: Kate

Mobile
07821-554914

Home
020-8874-4389

Office
N/P

Email:
katemaier@outlook.com

Areas to be done and Description of Measure

1 Bedroom for carpet to select (PLEASE MEASURE 2 EXTRA ROOMS FOR FUTURE) - Kate to advise on carpet selection/s

Instructions and Estimators comments

COLLECT SAMPLES IF KATE STILL HAS THEM. Inspect possible carpet beetle issue - speak to me?

Must Read!

Kate will be home

Office Ref: S36132

Kate Maier, 34 Schubert Road

Measure Mon, 23 Mar 26

At 1-2pm

Wood / Concrete / other _____

Edge: Wood/Concrete/No pin/existing (if existing, allow __ sticks to supplement where necessary)

Sticking Req'd: Yes/No Type: Fastset/Other

Underlay: Re-use Existing / New required

Type: 42oz Felt / Fomalux / PU Foam / Luxury PU Foam / LowTog / Durafit

Doorbars: Alloy / Satin Ali / Polished Ali / Anod / Solid Brass / Chrome / Nisheen
Seam/Wood/T/Holds: colour _____

Door Clearance: OK / Low (advise on quote) *add to get carpet*

Uplift: No / Yes (if "Yes" - what type?) *DBI such as*

Furniture: No/Yes (if YES, please specify the following) - 1 man / 2 men (Fitter to get paid) £ _____ total/per room

Parking Cost: Free / £ *7* per hour

Parking Restrictions: (type) / £ *NO*

Congestion Zone: No // Yes

Access: Easy / Hard / 2 men req'd / _____ floor?

Runners: Whipping / Binding (if binding, specify type)

Tape size: 1½" / 2" / 3" / 5"

Style: Top taping / Side binding

Stairrods: Type _____ Nr _____ Size _____

Must Read: Kate will be home

Job Name: Maier

Address: S3482

Tel: _____
Sheet: _____ of: _____

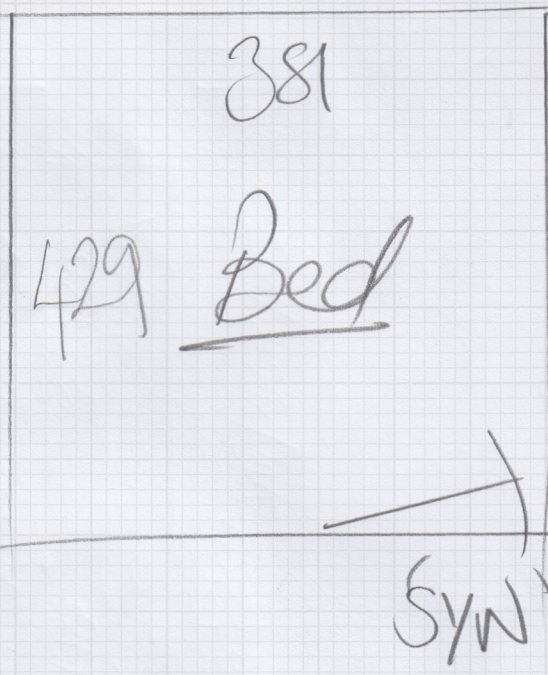

Wood

→ Highdiffe 102
→