

S36200

4th call of 4

Notes for Measure

Estimator: Chris

Ruth Hitchcock, 16 Grosvenor Avenue

Date of Measure: Mon, 27 Apr 26

At: 2pm - 3pm

Site Address:

16 Grosvenor Avenue  
Sheen

LONDON

SW14 8BX

Customer Address:

16 Grosvenor Avenue  
Sheen

LONDON

SW14 8BX

CONTACT: As customer details

Mobile	Home	Office
07586-300085	020-8876-4449	N/P

Email:

rvhitchcock@googlemail.com

Areas to be done and Description of Measure

Utility - Amtico Signature Woodplank 3" - Colour TBC

Instructions and Estimators comments

Take Amtico Signature Woods Folder

Must Read!

Not entered

Office Ref: S36200

Ruth Hitchcock, 16 Grosvenor Avenue

Date of Measure Mon, 27 Apr 26

At 2pm - 3pm

Floor: Wood / Concrete / other \_\_\_\_\_

S/edge: ~~Wood / Concrete / No pin / existing~~ (if existing, allow \_\_\_ sticks to supplement where necessary)

Sticking Req'd: Yes/No Type: Fastset/Other

Underlay: Re-use Existing / New required

Type: 42oz Felt / Fomalux / PU Foam / Luxury PU Foam / LowTog / Durafit

Doorbars: Alloy / Satin Ali / Polished Ali / Anod / Solid Brass / Chrome / Nisheen  
Seam/Wood/T/Holds: colour \_\_\_\_\_

Door Clearance: OK / Low (advise on quote)

Uplift: No / Yes (if "Yes" - what type?) \_\_\_\_\_

Furniture: No/Yes (if YES, please specify the following) - 1 man / 2 men (Fitter to get paid) £\_\_\_\_\_ total/per room

Parking Cost: Free / £\_\_\_\_\_ per hour

Parking Restrictions: (type) / £\_\_\_\_\_

Congestion Zone: No / Yes

Access: Easy / Hard / 2 men req'd / \_\_\_\_\_ floor?

Runners: Whipping / Binding (if binding, specify type)

Tape size: 1½" / 2" / 3" / 5"

Style: Top taping / Side binding

Stairrods: Type \_\_\_\_\_ Nr \_\_\_\_\_ Size \_\_\_\_\_

**Must Read: Not entered**

Job No: \_\_\_\_\_  
Name: Hitchcock  
Address: S36200  
Tel: \_\_\_\_\_  
Sheet: \_\_\_\_\_ of: \_\_\_\_\_

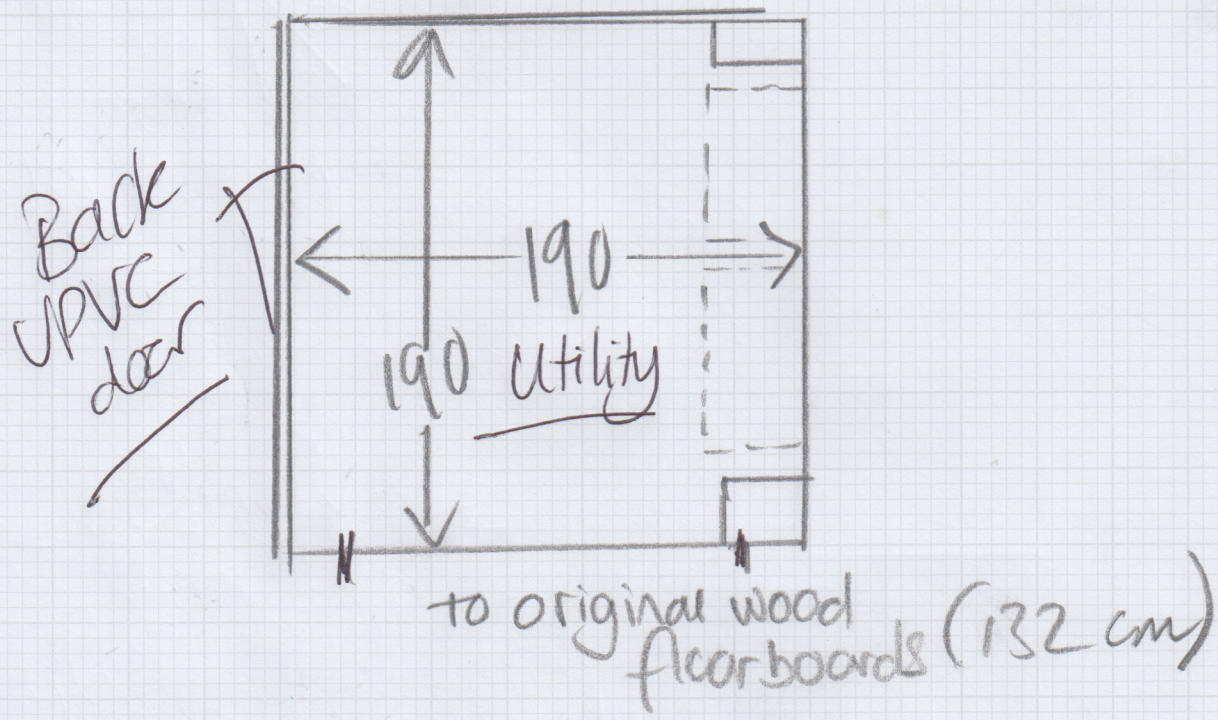

14.5 cm wood floorboards.