

Job No: **F25713**
 Name: **MAISON DESIGN**
 Address: **10 ROSEMARY CRESCENT**
SW11 4RZ
 Tel: _____
 Sheet: **1 of 1**

(A) RISER 17x73
 9 STRS 74x42
 460x60cm
 EXISTING RUNNER
 60.5cm + 5cm TAPE
 SHOWING

(B) RISER 15x77.5
 8 STRS 77.5cm x 43cm
 400x60cm

(C) RISER 15x77.5
 5 STRS 77.5cm x 42cm
 250x60cm

(D) RISER 77.5cm x 17cm - SEPARATE PIECE
 10 STRS 77.5cm x 45cm
 W AS STAIR 50cm - SEPARATE PIECE
 460x60cm

(E) 150x60cm

(F) BASEMENT STAIRS
 7 STRS CLOSE COVER
 THIS FIGHT
 FROM WASTE OFF
 CURRIC PLAN
 460x1.60m

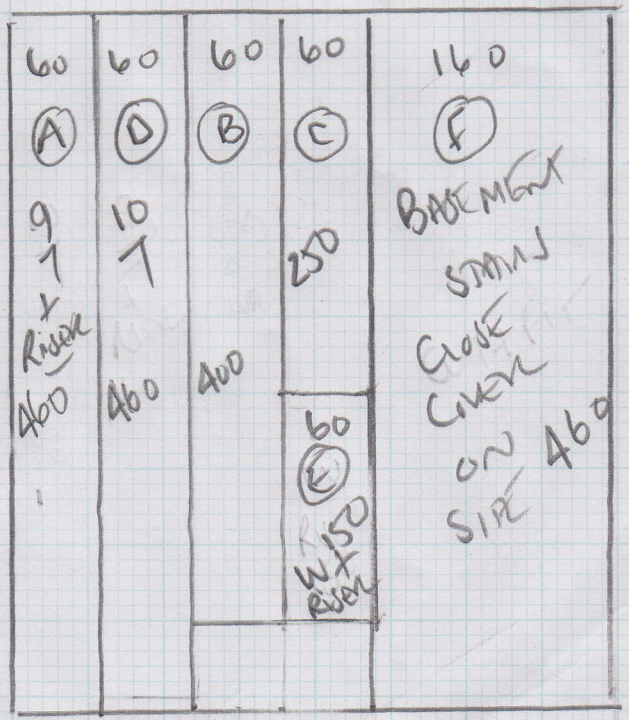

- 1) 460 x 60cm
- 2) 460 x 60cm
- 3) 400 x 60cm
- 4) 250 x 60cm
- 5) 150 x 60cm

TAPE SIDES
ONLY
STAIR RUNNERS



mrcarpet
DESIGNS FOR FLOORS

301 Munster Road
Fulham
SW6 6BJ
T 020-7381-1989
F 020-7385-4006

34.40m TAPE

WHIPPING / BINDING FORM

To be collected by B H Carpets – Tel 020-8665-9110 Fax 020-8665-6611

Customer Name: MASON DESIGN

Job No. : F 23713

Description of carpet : SISAL BOUCHE C658 ALUMINIUM

Whipping / Side Binding / Top Taping (1/2 & 1/2)

Colour of Binding tape: CP1 SUEET Colour of Whipping :

Size of Binding tape: 120mm Number of pieces : 5

Sizes To be cut to: 460x60, 460x60, 400x60, 250x60, 150x60

Whipping: metres @ £2.00 per metre = £

Blind Binding: metres @ £7.00 per metre = £

Taping Only 35 Units @ £6.00 per metre = £ 210.00
3" or 5" Tape

Any Queries call

Colin John Paul

Deliver Back to: Unit 19, Riverside Road, SW17

Mr Carpet Use. (Copy to be faxed to accounts when returned)

Date Collected: _____ Collected
By: _____

Date Returned: _____ Returned
By: _____