

LONGFIELD

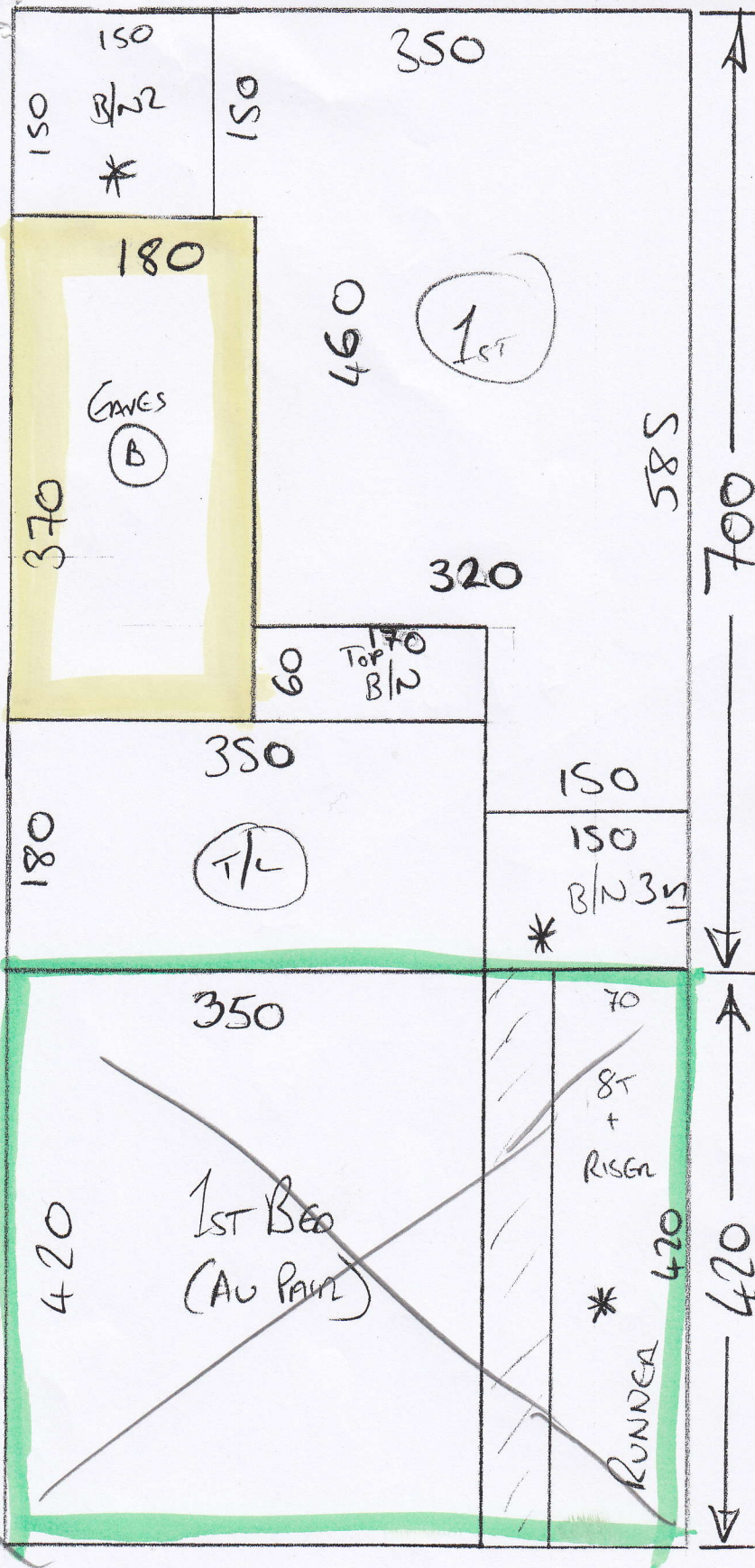

STOCK NATURAL 4
- HC 510

Cut (RAW) = 700×500

" 2 = 420×500

" 3 = 780×500

" 4 = 505×500

" 5 = 560×500

2965×500

$= 148.25m^2$

* = RUNNER

Return To Stock
= TAKEN ON PHASE 1

LONGFIELD

RETURN
305 x 500
TO STOCK

