

ALI BARS.  
EXISTING GRIPPER.

R16243  
BARBIERI  
19 PROSPECT RD  
KT6.

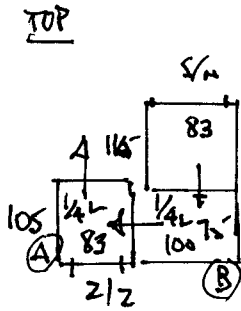

1 2.

9 x 45 x 76 + TURN.  
1 x BN.

FIRST.

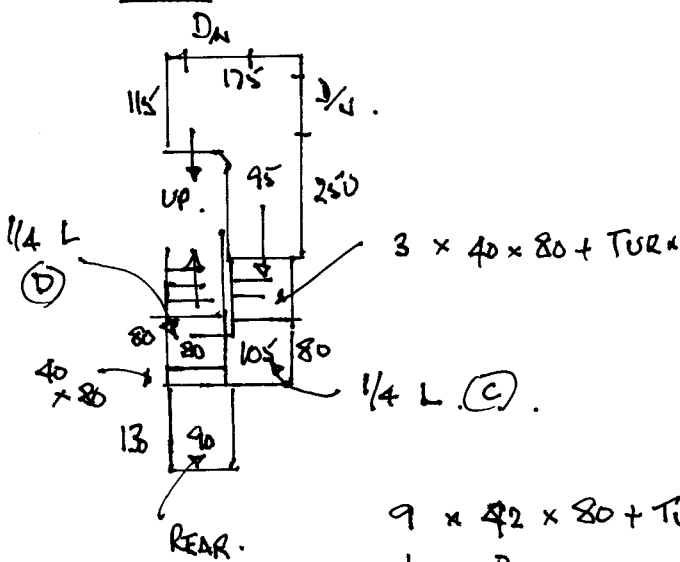

9 x 42 x 80 + TURN  
1 x BN.

NOTE:

FIRST LANDING, 3 STAIRS, 1/4 L (C).  
INC. STEP & 1/4 L (D) ALL TO MATCH  
TO FIRST STAIRS.

FIT STAIRS FIRST & MATCH STRIPE  
THRU TO AND INCLUDING FIRST LAND.

NOTE: 1/4 L (C) IS TO RUN THE  
SAME DIRECTION AS 3RD STAIRS.  
LINE RUNNING PARALLEL TO NOSING  
NOT OVER @ 90° ON 1/4 L (C).

1/4 L (A) AND TOP STAIRS PLANNED  
FOR STRIPE TO FOLLOW ON.  
SET UP OFF RT HAND WALL  
LOOKING UP FROM FIRST LANDING.

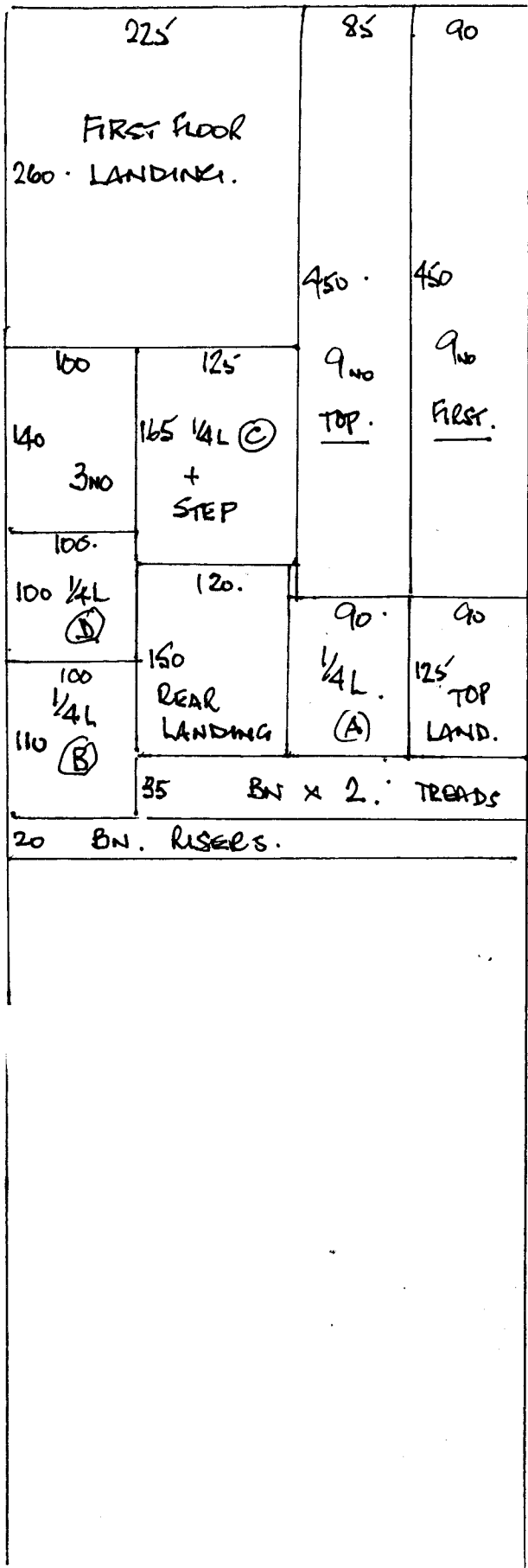

RIG 243  
 BARBIERI  
 19 PROSPECT RD  
 KT 6.

2 2.

$$630 \times 400 = 25.20 m^2$$

ORDERED 650 x 400.