

R15719
ELLIOTT
50 WILTON CRES
SW19.

2 2.

~~XXXXXXXXXX~~

Hardwick, LH12 Silverhow Stride

LANDING

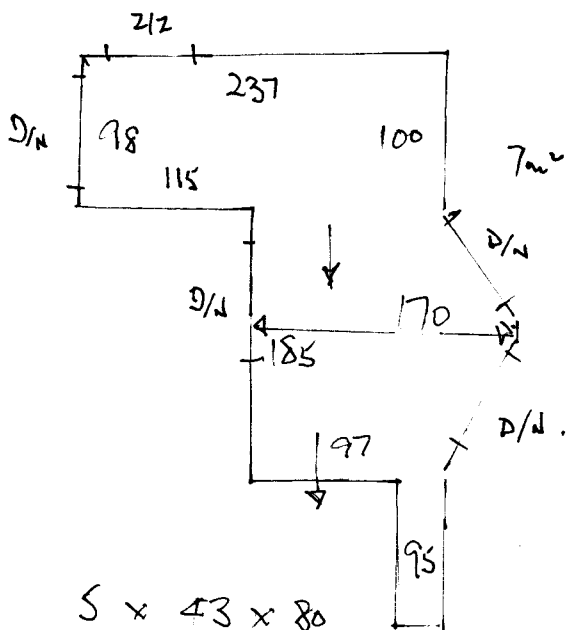

- S x 43 x 80
- W1 62 x 82
- W2 66 x 113 6m²
- W3 65 x 78
- 8 x 43 x 80

STAIRS 60cm RUNNER - WHIPPED SIDES.

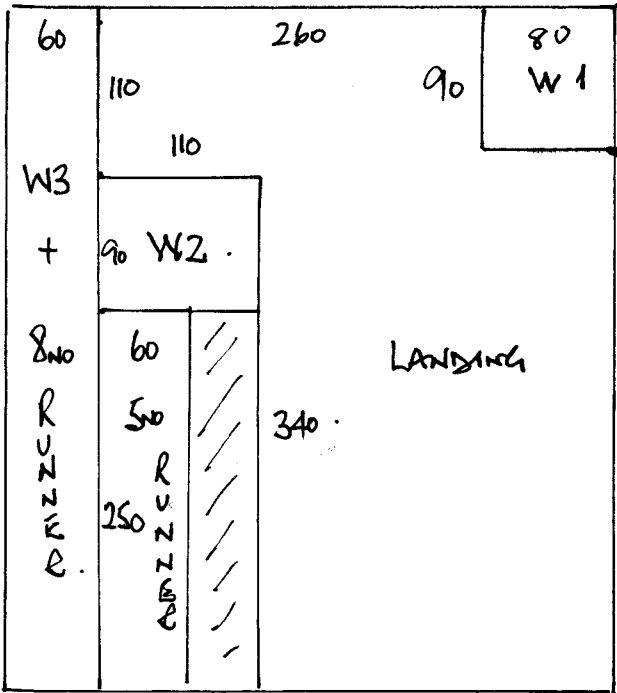

R15719
 ELLIOTT
 50 WILTON CRES.
 SW19.

1 2

$$450 \times 400 = 180000$$

WED. 9th DEC.
 CUT RUNNERS - 60 cm WIDE.
 BALANCE FIT ON MON 14th.