

TOP LANDING

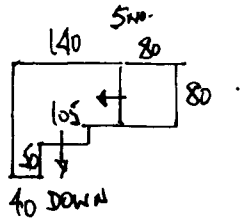

W1 62 x 85

W2 62 x 110 15no.

W3 75 x 80

9 x 44 x 80.

FIRST FLOOR

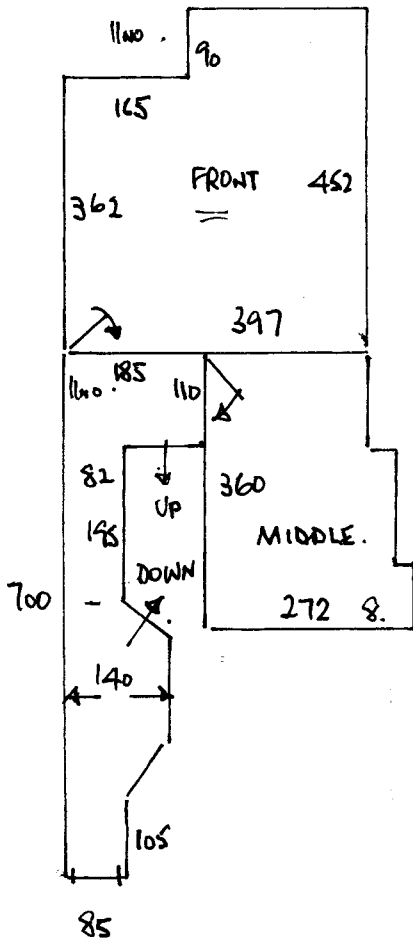

FLT.

FRONT - CAIRNS - CAMEL, REMNANT -

4.35 x 5.00m.

R15767
GILMOUR
32 WATERY LANE
SW 20.

1 1.