

RISQ91
 LYNCH
 30 DRAX AVE
 SW20

100

1 2

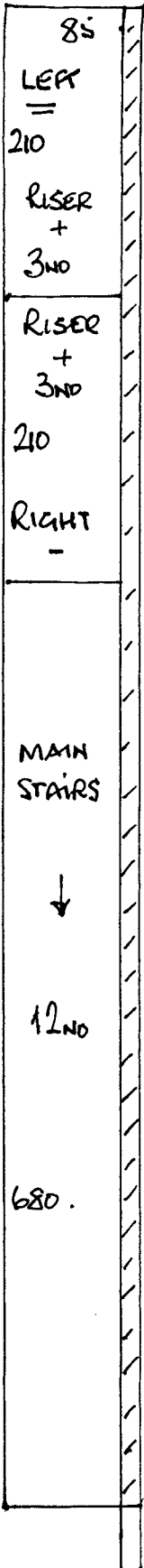

500.

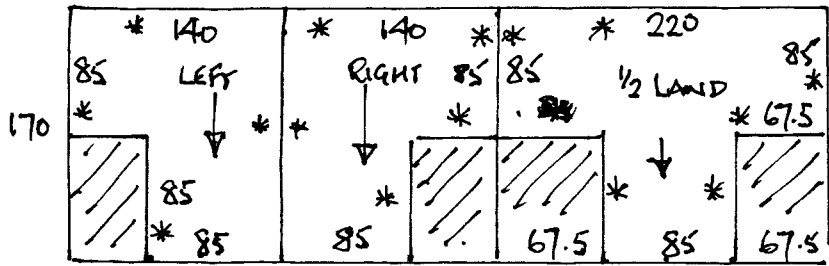

RUNNERS, 1/4 LANDINGS & 1/2 LANDINGS

ALL 85 CENTIMETRES WIDE.

ARROW INDICATES DIRECTION OF PILE LAY.

* MARKS SIDES TO BE WHIPPED ON LANDINGS.
 INCLUDING SIDES ONLY ON RUNNERS.

TOTAL NUMBER OF PIECES (6)

$$\begin{aligned}
 & \text{in m} \\
 11.00 \times 2 &= 22.00 \\
 5.35 \times 2 &= 10.70 \\
 6.95 \times 2 &= 13.90 \\
 & \underline{46.60}
 \end{aligned}$$

BASEMENT

Fit ALL SPICE - SAFFRON
AS RUNNERS WITH RED TAPE.

R15991
LYNCH
30 DRAX AVE
SW20.

- 16.00 l/m²ms. 3 x 45 x 87. (65 RUNNER)
- RED TAPE FINISH.
- W1 68 x 90
 - W2 70 x 100
 - W3 80 x 75 4m².
 - W4 70 x 70
- 8 x 45 x 87 (65 RUNNER)

2 2

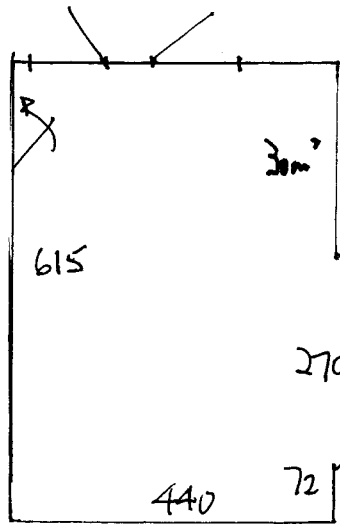

UPLIFT & DISPOSE OF EXISTING
SISAL, STUCK TO RUBBER.

SEAM HERE. USE SIDEWASTE

MAIN STAIRS.

Fit:	RISER	20.			
WESTEND PRESTIGE	2 x 50	x	85	} x 2	20.
VELVET.	1/4L 160	x	130		
	1 x 50	x	85	2	
	1/2L 140	x	195	4	4
	12 x 50	x	85	24.	24.
					<u>48NO.</u>