

KITCHEN - MON 24th NOV.

R15480
SAUNDERS,
18 HILL VIEW
SW 20. OTA.

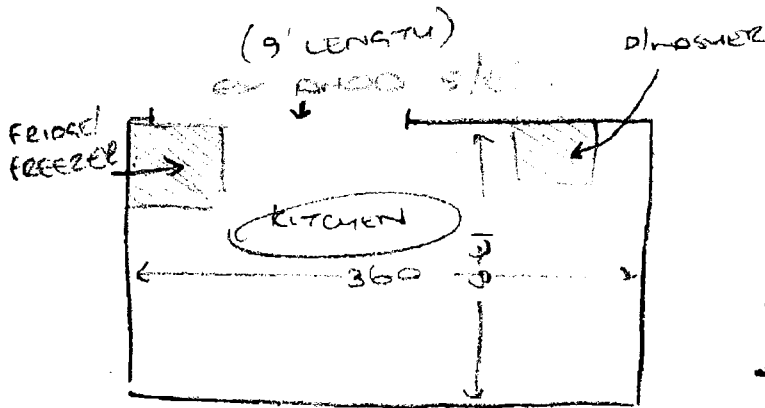

- CONC FLOOR
- 1/2" ex VINYL
- QUOTE TO SCREED. MAY NOT BE REC...
- ex BLR
- MOVE 2 x APPLIANCES.

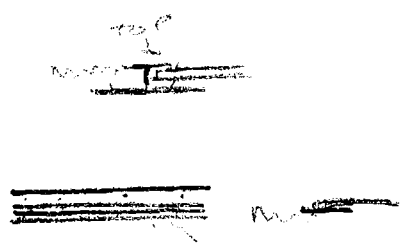

HOLD ON FILE

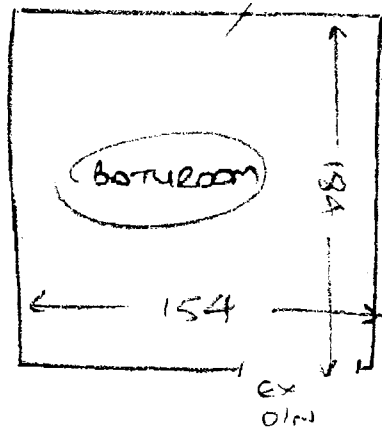

- EXISTING COLE TILES
- FIT OVER EXISTING TILES AS WALLS ARE TILED RIGHT UP TO FLOORING.
- ALLOW COVER STRIP TO FIT OVER ex DIA INSET EXISTING FLOORING IS FITTED INTO.