

R15432

• TEBBS
27 PRINCES GEORGES AVE
SW20.

2 2 .

$$395 \times 500 = 19.75m^2$$

$$0/400 \times 500 = 20.00m^2$$

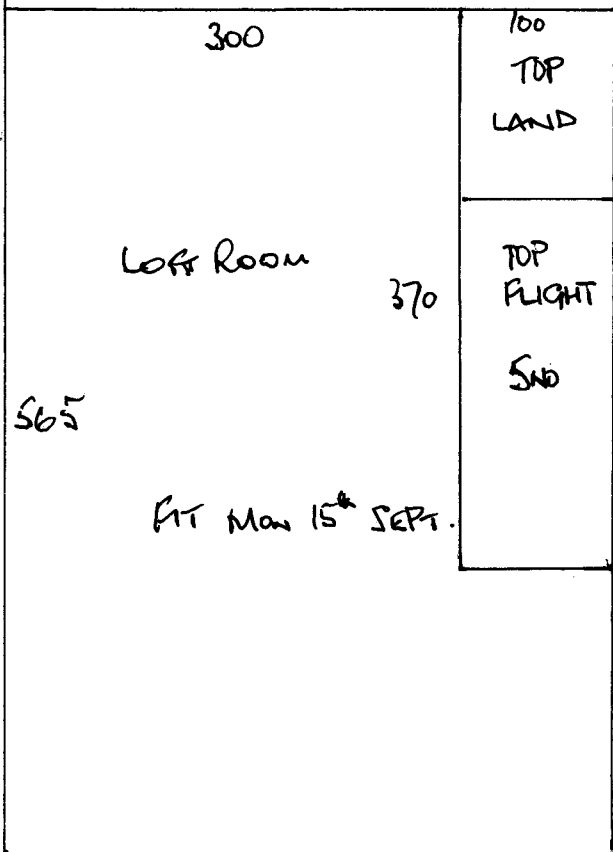

Loft Room.
FIT Mon 15th SEPT. 15th CALL

LEAVE TOP LAND &
STAIR SECTION IN
W'HOUSE FOR LATER STAGE.

2ND STAGE.
MON 9th FEB.

$$5.65 \times 400 = 22.60m^2$$

TOTAL. 42.60m²

WOOD FLOORS - NO UPLIFT.

H/B TO FIRST LANDING ONLY.

R15432

TEBBS

27 PRINCE GEORGES AVE

SW 20

LOFT ROOM. (FITTED 15th SEPT)

1 2

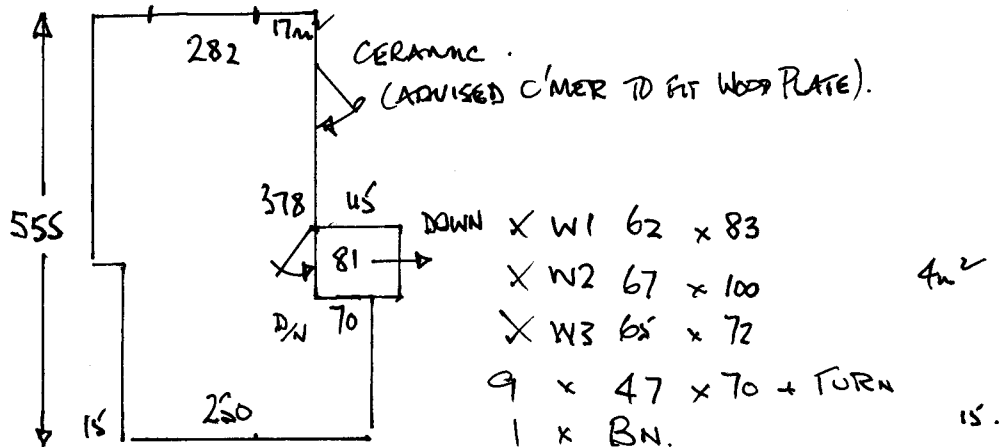

FIRST FLOOR.

H/B

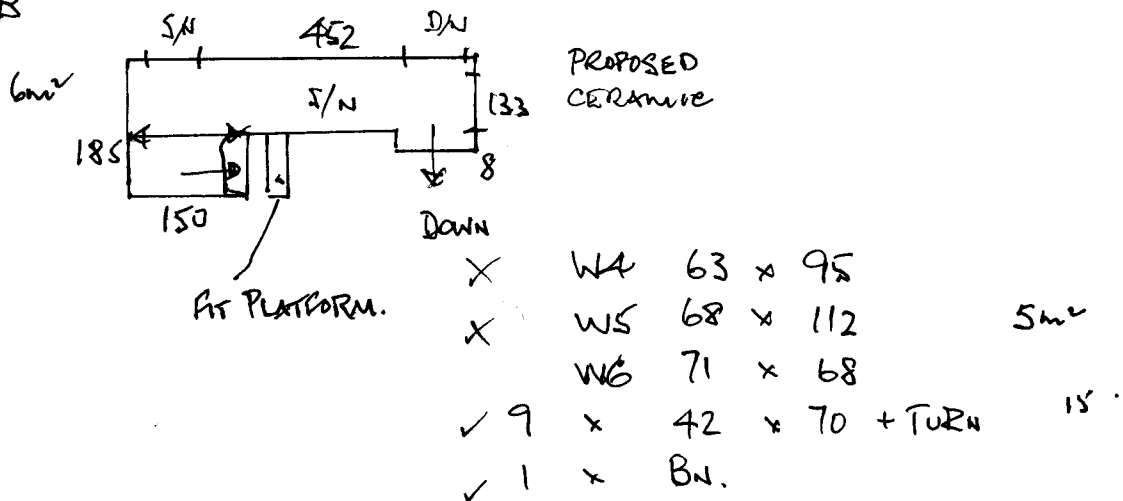

OPTION ① - CLOSE COVER

② - AS RUNNER.

U/LAY v 15m²

D/N x 2NO

S/N x 4NO

Z/Z x 1NO.

GRIPPER v 53NO.

H/B. x 10NO