

R 15478
 WARD
 52 BODMIN ST
 SW 18

1 2.

CURS:

570 x 500.

500 x "

ALL WOOD FLOORS.
GRIPPER RECD
DW DOORBARS.

R15478
WARD
52 BODMIN ST
SW18

2 2.

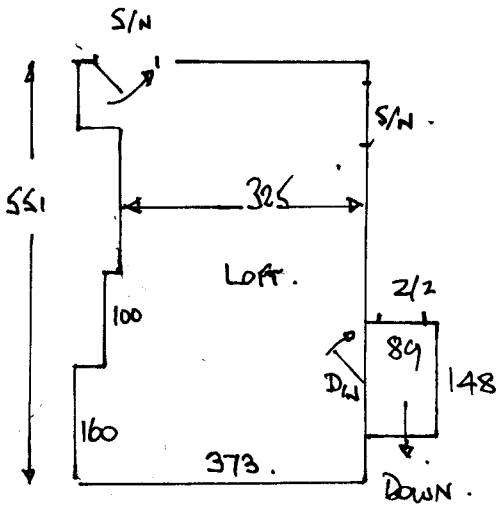

SECOND
STAIR.

$\frac{1}{2}$ $3 \times 47 \times 80$
L. 108×156
 $10 \times 47 \times 80$

FIRST
STAIR.

$\frac{1}{2}$ $2 \times 43 \times 85$
L. 120×159 (ALL S/N)
 $14 \times 45 \times 74$

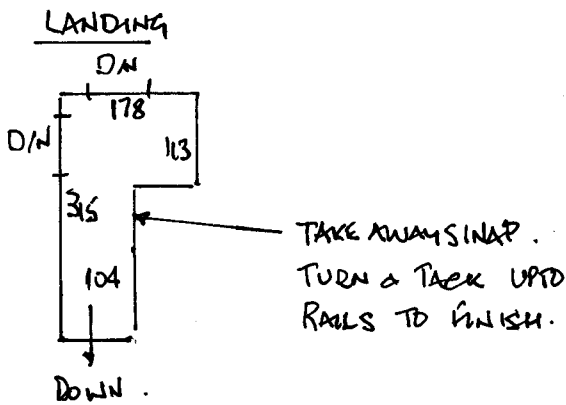

HALL.

