

Floor Care System

Our Floor Care Guide is designed to show you how to get the best from your new Karndean floor. Karndean floors are very hardwearing and like all vinyl products, regular maintenance will enhance the beauty and durability of your new floor.

We recommend that you order a 'Clean Start' pack with your new Karndean floor. You will be able to order extra bottles of the individual cleaning products from your retailer.

Your Clean Start pack contains:

- 750ml Basic Stripper
- 750ml Dim Glow Floor Protector
- 750ml Routine Cleaner
- 1 x Applicator
- 1 x Green pad (for use with Basic Stripper)
- 1 x White pad (for use with Dim Glow)
- 1 x Set furniture protectors



Preparation: Newly laid floors should be left for at least 24 hours before you replace furniture or clean the floor. Before using our cleaning and maintenance products, you should sweep the floor with a soft brush.

Stage 1 Karndean Basic Stripper

Following installation, use to remove all remains of adhesive. Subsequently, use to remove previous applications of Dim Glow floor protector.

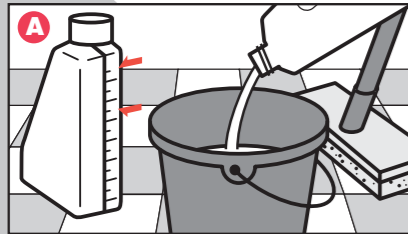

Dilute Basic Stripper approximately 1:5 with water (4 divider lines [200ml] to one litre of water – covers approx. 10m²). Spread solution liberally over the floor with mop.

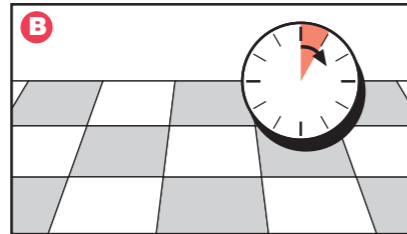

Leave to work for approximately 5 minutes. Do **NOT** allow the wet floor to become dry before stage "C".

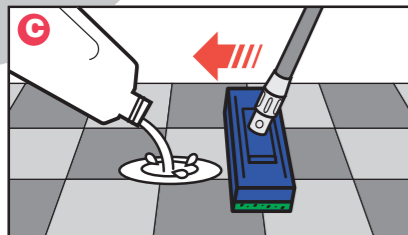

Scrub the floor with the blue applicator and green pad.



Remove residue with mop, then rinse thoroughly with clean water.

Karndean Basic Stripper should **NOT** be allowed to dry on the floor. While applying Basic Stripper wear rubber gloves. For the removal of stubborn marks, use Karndean Basic Stripper undiluted. Please ensure green pad is always wet when in use.

Stage 2 Karndean Dim Glow Floor Protector

Dim Glow Floor Protector creates a satin finish. Helps protect your floor from marks and find scratches. Helps to simplify routine cleaning.

Before proceeding with application ensure the floor is completely dry and free of all traces of Basic Stripper.

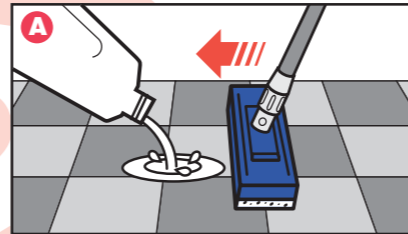

Using the blue applicator with the white pad, spread a thin and even layer of undiluted Dim Glow floor protector, in one direction.

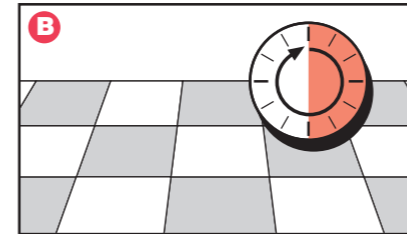

Leave this layer to dry for approximately 30 minutes...

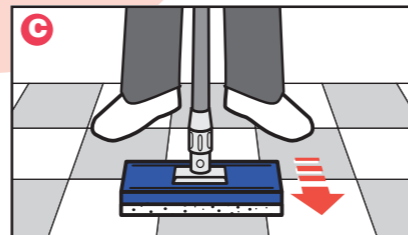

... then repeat the process in a transverse direction. (IMPORTANT: white pad must be rinsed thoroughly immediately afterwards, for future use).

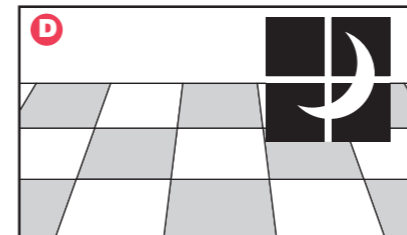

Leave to dry without walking on the surface for at least 6 hours, or preferably overnight.

Note: When, after a period of time, the Dim Glow needs replenishing, begin the process from stage 1 again. To maintain the protective layer, the Dim Glow floor protector will need to be stripped and reapplied every 6 months depending on traffic.

Stage 3 Karndean Routine Cleaner

Use regularly for easy cleaning of your Karndean floor.



Use 50ml (1 divider line) in a bucket with about 8 to 10 litres of water.



Keeping the mop wet, mop routine cleaner solution onto the floor. Wring out mop, mop off and leave to dry.

Attention: Keep locked up and out of reach of children.

Protecting your new floor

Do...

- Use quality fibre mats at entrances to minimise dirt and grit being brought in from outside.

Warning: Avoid rubber-backed mats as some types can cause permanent floor discolouration.

- Use protective pads under furniture legs to protect against scratches.
- Use load-bearing castors to protect against indentation from heavy items of furniture.
- Mop up spillages as soon as possible to prevent spots becoming stains. Use of the Dim Glow floor protector should ensure better protection from most substances.

Do not...

- Slide or drag appliances or furniture across the floor.
- Allow cigarettes or other hot items to come into contact with the floor, as they can cause permanent damage.
- Apply thick coatings of Dim Glow floor protector. Two thin coats as per our instructions is more than sufficient.
- Use non-Karndean cleaning products. Some cleaning products contain agents that can damage the floor.
- Allow silicone-based products such as furniture polish or glass cleaner to come into contact with the floor. These can make the floor very slippery.
- Allow rubber backed mats or rubber footed furniture to come into contact with the floor. Permanent discolouration may occur.



If you require any advice on maintaining your floor, please contact our Customer Services Department in your country:

Karndean UK

Crab Apple Way, Vale Park, Evesham,
Worcestershire, WR11 1GP

Technical: 01386 820102

Trade: 01386 820200

Consumer: 01386 820100

Accounts: 01386 820101

Fax: 01386 761249

technical@karndean.co.uk

Karndean New Zealand

Unit A, 73 Greenmount Drive
East Tamaki, Auckland
PO Box 58264

Tel: 64 9 273 5430

Fax: 64 9 273 5435

info@karndean.co.nz

Karndean USA

1100 Pontiac Court,
Bushy Run Corporate Park

Export,

PA 15632

Toll free phone: 888.266.4343

Toll free fax: 800.887.7043

info@karndean.com

Karndean Australia

835 Stud Road,
Knoxfield,
Victoria 3180

Tel: 1800 33 11 70

Fax: (03) 9763 1625

enquiries@karndean.com.au

