

Mrs Catherine Lloyd, 82 Erpingham Road

Date of Measure: Thu, 25 Nov 21

At: 10:00 - 10:30

Site Address:
82 Erpingham Road

Customer Address:
82 Erpingham Road

LONDON SW15 1BG

LONDON SW15 1BG

CONTACT: As customer details

Mobile	Home	Office
07789-718927		

Email:
catherinelloyd739@btinternet.com

Areas to be done and Description of Measure

Bedroom, Stairs and Landing. Bedroom urgent, rest could wait. Had soft velvet previously, will come in to select another pp

Landings + Stairs

Instructions and Estimators comments

no felt underlay on quote

A2 ST (13)

P/KTAS
offer -

Lux Pl. (HAD BEFORE
ON OLD
HSE (P 27317))

Must Read!

Not entered

Office Ref: P30280

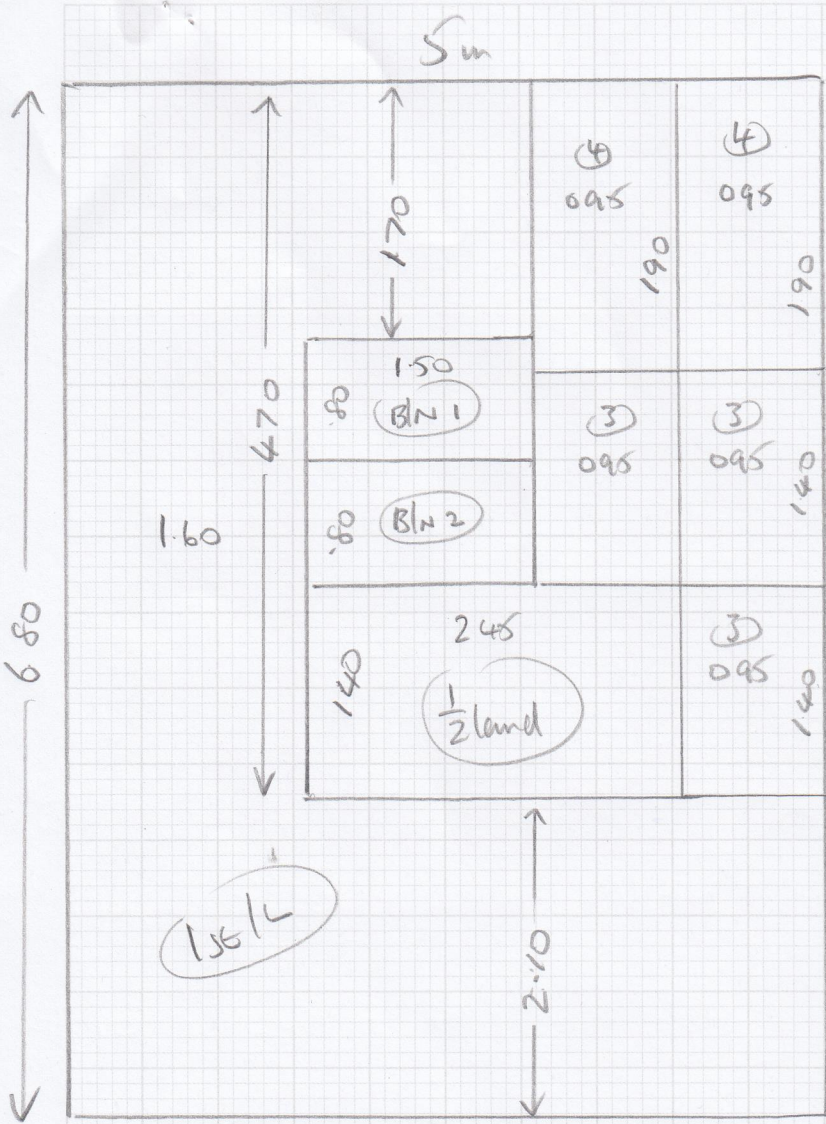

pmrcarpet
DESIGNS FOR FLOORS

Job No: Mrs C Lloyd
 Van: 82 Erpingham Road
 Address: Putney
 SW15 1BQ

Tel: _____
 Sheet: _____ of: _____

680 x 5m
 185 x 5m

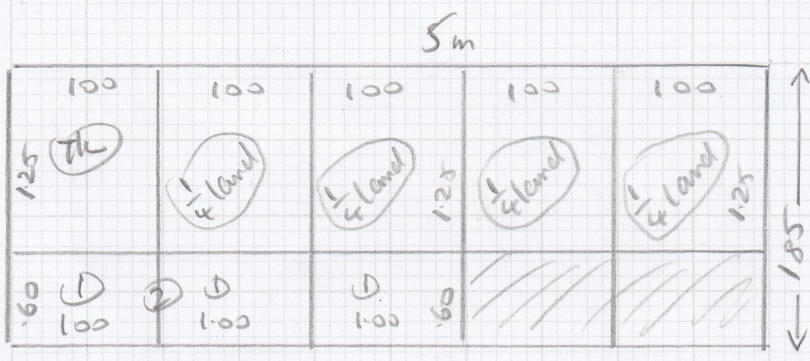

↑
 ↓
 ② ①

① 0.2

Cost Sheet

LANDS + STAIRS

Customer Name				Job No			
Mrs Catherine Lloyd				P30280			
Invoice address							
82 Erpingham Road, Putney, SW15 1BG							
Site Address							
Tel no 1:	07789-718927						
Tel no 2:							
Tel no 3:							
email:	catherinelloyd1739@btinternet.com						
Areas Covered							
Landings and stairs							
QUALITY & COLOUR	Length	Width	QUANTITY	UNIT PRICE	TOTAL	BREAKDOWN	
	6.80	5.00	34.00				
	1.85	5.00	9.25				
Quality & Colour						CARPETS	
Quality & Colour							
Quality & Colour							
SUPPLIERS CARRIAGE CHARGE (if Applicable) enter cost in left hand column			1.00				
UNDERLAYS & GRIPPER			QUANTITY	UNIT PRICE	TOTAL		
Environmental Charge			1.00	£25.00	£25.00		
Underlay Selection (DEFAULT 42oz Felt)							
LUXIFELT COMBINATION U/LAY			43.00	£9.90	£425.70		
Enter Lin M below	PAPERFELT INTERLINER		20.00	£1.00	£20.00		
	WOOD SMOOTHEDGE (5' length)		8.00	£2.60	£20.80		
	CONCRETE SMOOTHEDGE (5' length)			£2.60			
	NO PIN SMOOTHEDGE (5' length)			£2.60			
Enter Cost	BARS - ADHESIVES (Default Standard Bars)		QUANTITY	UNIT PRICE	TOTAL		
	Standard ALI D/NAP (900mm length)		5.00	£8.00	£40.00		
	Standard ALI S/NAP (900mm length)		1.00	£8.00	£8.00		
	Standard ALI T/Edge (900mm length)		2.00	£8.00	£16.00		
	TILE LIPS (900mm Length) Select Finish			£22.00			
	GRIPPER ADHESIVE (Fast Set)			£10.25			
	SPRAY ADHESIVE (Can)		1.00	£6.00	£6.00	ANCILLARIES	
	COIR	Length	Width	QUANTITY	UNIT PRICE	TOTAL	£561.50
	COIR MATTING - NATURAL				£35.00		
	COIR MATTING - COLOURS 17mm				£52.00		
Enter Cost	BESPOKE ANCILLARIES (enter cost in column A to calculate retail)		QUANTITY	UNIT PRICE	TOTAL		
WORKSHOP CHARGES (enter cost in column A to calculate retail)							
	DESCRIPTION		QUANTITY	UNIT PRICE	TOTAL	WORKSHOP	
	Whipping under 9m2			£8.00			
	Whipping OVER 9m2 (IE 2 people to handle the carpet through machine)			£9.00			
	Tape (Enter cost in left column)						
	Sewing (Enter cost in left column)						
	FITTING (Items where it states enter cost enter in left column)		QUANTITY	UNIT PRICE	TOTAL		
£86.50	FITTING CARPET STANDARD RATE		43.25	£4.50	£194.63		
	MIN CHARGE (Coir = 1/2 / Room = 1 / Flight stairs= 2)			£60.00			
	LABOUR MOVE FURNITURE (Normal = 1 / Heavy = 2)			£18.00			
	STICK SMOOTHEDGE			£1.50			
	SEAMING (Enter lin mtrs)			£5.00			
	SEAM DOORWAYS (Enter No. of doorways)			£7.00			
	FIT DOORMAT (As part of larger job)			£17.50			
	PORTERAGE (1 Unit = 1 hour labour)			£27.50			
£105.00	STAIR PREMIUM STANDARD (15 Sts/ 3 winders & 1 B/N)		3.00	£60.00	£180.00	FITTING	£417.63
	WINDER BONUS (Over 3 winders / per winder)			£6.00			
	RUNNERS CUT DOWN AT WAREHOUSE (Per job)			£18.00			
	RUNNERS FITTING CHARGE (Per visit / staircase)			£80.00			
	RUNNERS TEMPLATE ON SITE (Per item)			£9.00			
	RUNNERS RETURN VISIT (Per visit / Max 3 items)			£55.00			
	FIT STAIRRODS (Each)			£5.50			
	DELIVERY CHARGE (Per visit)			£25.00			
	CONGESTION CHARGE (Per day)			£26.00			
	ULEZ CHARGE (Per Extra day)			£22.00			
£12.50	ULEZ CHARGE (1 Day default) ONLY PAY ONE CHARGE PER FITTER PER DAY		1.00	£22.00	£22.00		
		Parking Cost per hour	QUANTITY	MRC Charge			
£12.00	PARKING (Enter cost per hour in next column on right)		4	3.00	£7.00	£21.00	
	ADAPTION / REMEDIAL WORK (Enter cost in left column)			2.00			
	LABOUR ADDITIONAL (Enter cost in left column)			1.00			
	LABOUR ADDITIONAL (Enter cost in left column)			1.00			
£216.00	FITTING MONEY (without uplift)				SUB TOTAL	£979.13	
	DISCOUNT		43.25		TOTAL	£979.13	
			QUANTITY	UNIT PRICE	TOTAL		
£32.25	UPLIFT & DISPOSE (IF Required)		43.00	£3.00	£129.00		
	Easy Shims (SEE BELOW FOR QUANTITIES/DEPTHS)			£20.00			
	Side Shims (SEE BELOW FOR QUANTITIES/DEPTHS)			£5.00			
£248.25	TOTAL FITTING MONEY (with uplift & Easyshims)				TOTAL	£1,108.13	
	Easy shims 6mm				SUB TOTAL CARPET & UPLIFT	£1,108.13	
	Easy shims 9mm				Discount		
	Easy shims 12mm				TOTAL CARPET & UPLIFT	£1,108.13	
					SUB TOTAL CARPET & UPLIFT & SHIMS	£1,108.13	
					Discount		
					TOTAL CARPET & UPLIFT & SHIMS	£1,108.13	
					This price for order confirmation use only - Net Cost inc shims NO UPLIFT		
					£979.13		

Mrs Catherine Lloyd, 82 Erpingham Road

Date of Measure Thu, 25 Nov 21

At 10:00 - 10:30

Floor: Wood / Concrete / other stairs

S/edge: Wood/Concrete/No pin/existing (if existing, allow 8 sticks to supplement where necessary)

Sticking Req'd: Yes/No Type: Fastset/Other

Underlay: Re-use Existing / New required

Type: 42oz Felt / Fomalux / PU Foam / Luxury PU Foam / LowTog / Durafit

Doorbars: Alloy / Satin Ali / Polished Ali / Anod / Solid Brass / Chrome / Nisheen Seam/Wood/T/Holds: colour _____

Door Clearance: OK / Low (advise on quote)

Uplift: No / Yes (if "Yes" - what type?) _____

Furniture: No/Yes (if YES, please specify the following) - 1 man / 2 men (Fitter to get paid) £ _____ total/per room

Parking Cost: Free / £ 4 per hour

Parking Restrictions: (type) / £ _____ 8.30 - 10.30 am

Congestion Zone: No / Yes

Access: Easy / Hard / 2 men req'd / _____ floor?

Runners: Whipping / Binding (if binding, specify type)

Tape size: 1½" / 2" / 3" / 5"

Style: Top taping / Side binding

Stairrods: Type _____ Nr _____ Size _____

Must Read: Not entered

Office Ref: P30280