



**HERITAGE**  
- REDROW -

# THE STRATFORD

FOUR BEDROOM HOME



# THE STRATFORD GROUND FLOOR

- 1 Lounge 16'4" x 11'6" 4.97 x 3.51 m
- 2 Family/  
Kitchen/  
Dining 19'8" x 14'9" 5.99 x 4.49 m
- 3 Cloaks 7'3" x 3'6" 2.20 x 1.07 m

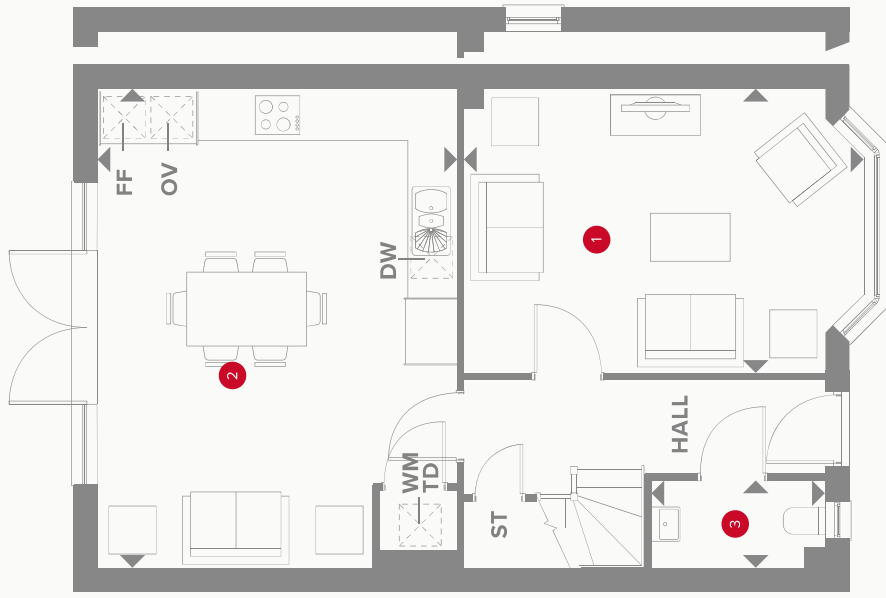

\*Elevation variation to plot: 41' only.

## KEY

- Hob
- OV Oven
- FF Fridge/freezer
- TD Tumble dryer space
- ST Storage cupboard
- WM Washing machine space
- DW Dishwasher space
- 4 Dimensions start

# THE STRATFORD FIRST FLOOR

4	Bedroom 1	14'2" x 10'10"	4.33 x 3.30 m
5	Bedroom 2	11'11" x 9'11"	3.62 x 3.02 m
6	Bedroom 3	9'5" x 7'8"	2.88 x 2.34 m
7	Bedroom 4	8'6" x 7'3"	2.60 x 2.20 m
8	Bathroom	6'9" x 5'9"	2.05 x 1.76 m
9	En-suite	7'6" x 4'7"	2.28 x 1.39 m

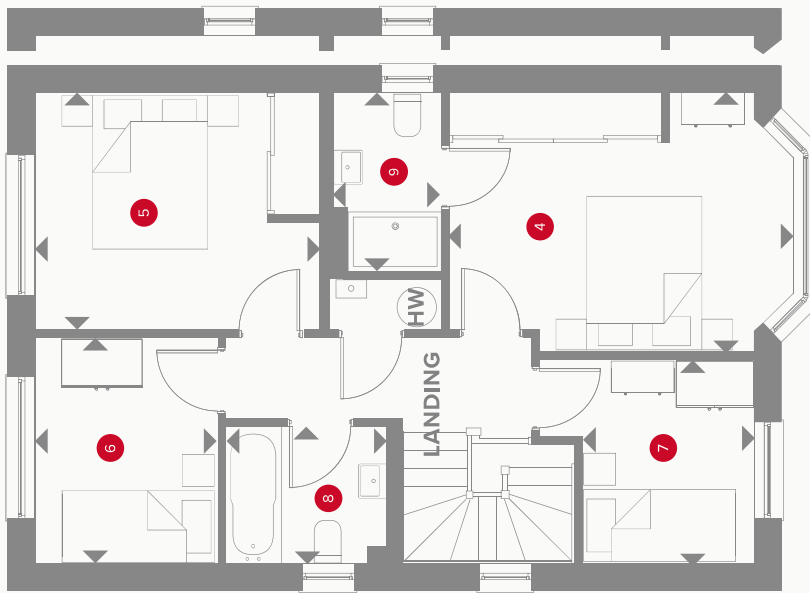

\*Elevation variation to plot 41 only.

## KEY

- ◀ Dimensions start
- HW Hot water storage

**CONSUMER  
CODE FOR  
HOME BUILDERS**  
[www.consumercode.co.uk](http://www.consumercode.co.uk)

Customers should note this illustration is an example of the Stratford Lifestyle house type. All dimensions indicated are approximate and the furniture layout is for illustrative purposes only. Dimensions are given in feet and inches and may vary from plot to plot including window and door locations or removed. Materials and may differ from plot to plot including window and door locations. Detailed plans and specifications are available for inspection for each plot at our Sales Centre during working hours and customers must check their individual specification prior to making a reservation. All and above are subject to the specification. Please see Sales Consultant for further details.