

Runners

S33174
 Mrs L Brinkwater
 10 Connaught Ave
 E. Sheen
 SW14 7RH

BOTTOM STAIRS
 SEND FOR WHIPPING

↑ ↑
 (11) To be 60 cm runner
 need to pattern match
 also with Yeland

WOOL HERRING BONE
 SABLE BONE PIN → 2.75 x 4m

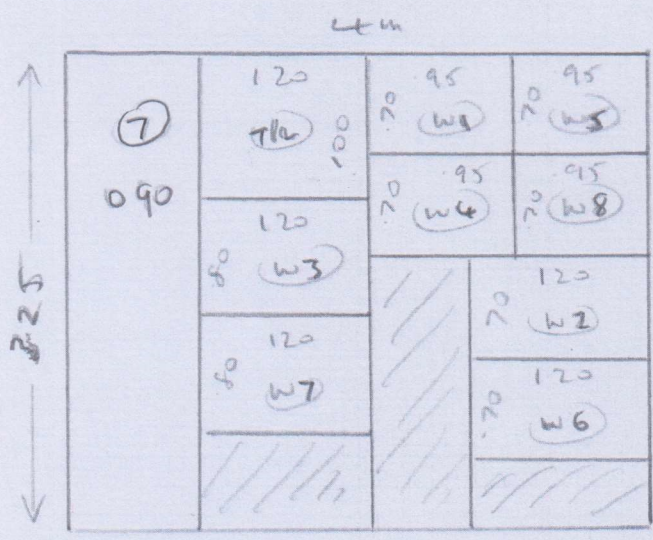

BOSTON BOS 017 3.25 x 4m

TOP STAIRS

FULLY FITTED 23.96

1 of 2

PART 1
 FIT TOP STAIRS +
 TEMPLATE BOTTOM
 STAIRS

Layout

S33174
DRINKWATER

TOP STAIRS

- T/L 080 or x090 (G.L. SW)
- W1 055 x 083
- W2 056 x 1.07
- W3 070 x 1.07
- W4 058 x 0.75
- W5 057 x 0.83
- W6 057 x 1.07
- W7 070 x 1.07
- W8 058 x 0.75
- (7) 046 x 0.79

Boston
Bas 017

wood
u/d 1010x
eye sledge

- Riser 020 x 0.76
- W9 068 x 0.95
- W10 080 x 0.95

Cut on site

- W11 075 x 60cm runner

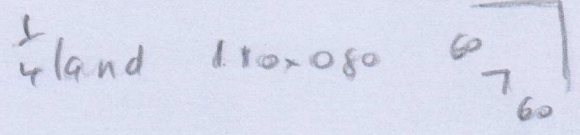

- (11) 045 x 60cm runner

WOOD HERRINGBONE
Runner

(20P2)

BOTTOM STAIRS
TEMPLATE ONLY

wood
u/d 1010x
eye sledge

eye STAIR RODS

Whip sides

Part 1 of job

Fit Top Stairs +
template Bottom
stairs

Whipping & Binding Workshop Instructions

Revised Prices February 2021



To: Kasias Carpets Ltd **07825 156676**
Branch: Sheen - Tel: 020 8876 9126 E: sheenbranch@mrcarpets.co.uk
Branch Contact: John Cresswell

Customer Name: Drinkwater **Please quote on invoice**

Job No: S33174 **Please quote on invoice**

Description of Carpet: Wool Herringbone, Sable Bone Pin 1862

Carpet Finish: Whipping SIDES ONLY

Number of Pieces: 7

Sizes to be cut to: (If applicable) Already cut runners

Runner Lengths for Taping: Please check before sewing 2.70 x 60cm / 2.70 x 60cm / 1/4 landing / 3 x winders / and riser

Date for collection: **Required back by:**

Collection From: Warehouse **Return To:** Warehouse

If Tape Selected	Supplied By	Select Supplier (if Appl)
Colour of tape:	Size of Tape:	Amount Visible on Top:
If Whipping:		
Colour of Whipping: Dark colour in carpet		

Special Instructions

Sewing charges authorised - Please note only charges authorised in writing will be paid on invoice

Materials	Description	Quantity	Unit Cost	Total
Whipping	Under 3m x 3m	19.00	£2.70	£51.30
	Over 3m x 3m		£2.70	
Standard Taping	Labour Only Under 3m x 3m		£6.40	
Double Taping	Labour Only Under 3m x 3m		£9.00	
Faux Suede & Leather	Labour Only Under 3m x 3m		£7.80	
Mitres Cotton	Per Corner	NOT APPLICABLE		
Mitres Leather	Per Corner	NOT APPLICABLE		
Narrow Binding THICK PILES	Labour & tape included		£7.70	
Blind Stitching MACHINE	NO LONGER AVAILABLE HAND SEWN ONLY			
Blind Stitching HAND SEWN	38mm Tape Labour & Tape		£13.00	
Hidden Stitching	Additional cost per lin M to above prices (Enter the same quantity as tape quantity)	NOT APPLICABLE		

Materials & other charges

Quantity	Description	Quantity	Unit Cost	Total
	Padding		£1.00	
	Chenille Tape 120mm		£4.40	
	Chrome Tape 120mm		£4.00	
	Cotton Tape 70mm		£3.30	
	Cotton Tape CK 120mm		£3.80	
	Cotton Herringbone HB 120mm		£4.40	
	Linen Twill Tape		£6.00	
	Faux Leather 120mm		£6.20	
	Faux Suede 120mm		£6.20	
	Goblin GLV 120mm		£4.40	
	Jute 120mm		£4.00	
	Leather 120mm		£14.00	
	Pipeline		£3.50	
	Starline (Linen) LS 120mm		£6.00	
	Superstrong 120mm		£6.00	
	Slim 120mm		£3.50	
	Teakline 120mm		£6.00	
	Sub Total			£51.30
	VAT @ 20%			£10.26
	Total			£61.56