

R19901
 M^cCurley
 153 Coombe Lane West
 KT2 7DH
 07834-859583
 1 of 1

67cm Runners

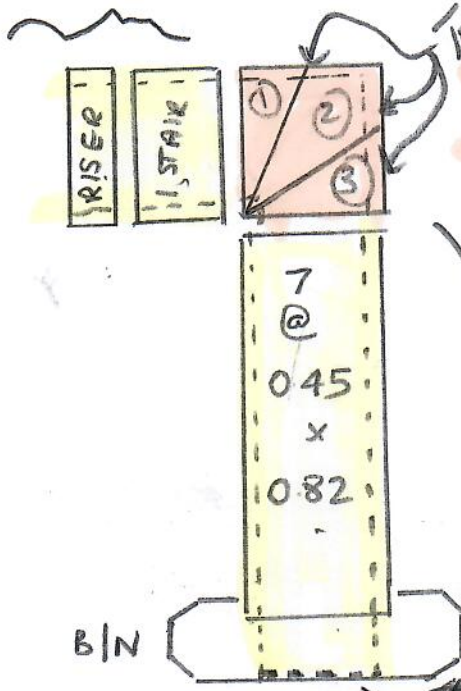

TEMPORARY 3x WINDER
 AND SIDE TO MATCH 67cm WIDE RUNNERS

Riser	=	0.16 x 0.82
1 stair	=	0.45 x 0.82
W1	=	0.65 x 0.94
W2	=	0.73 x 1.15
W3	=	0.71 x 0.79
B/N	=	0.54 x 1.34
71	=	0.45 x .82

~~Price for Bullnose to be taped at bottom~~

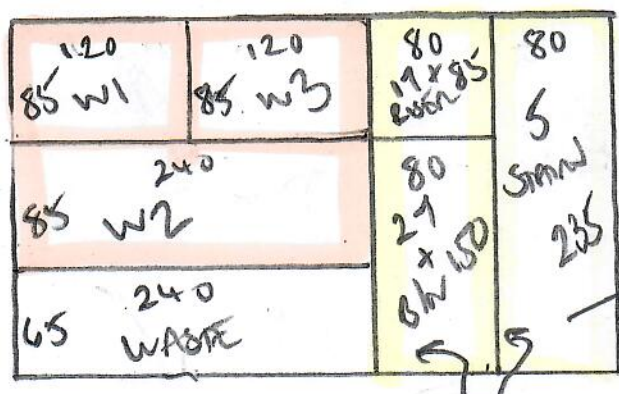

MUST PATTEREN
 MATCH STRIPES
 WHEN LAYING RUNNERS
 TO 67cm WIDTH

Cut Down TO 67cm Runners
 + MATCH UP STRIPES

TAKE COLAR CK 13 15 LINEAR METRES.